

BedPro™ Safety Alarm



Reorder #	Description	Unit
909335	BedPro Safety Alarm with Accessories	Each

This new alarm from Skil-Care features an under-mattress sensor pad that is protected against incontinence and wear by the mattress. Unlike sensor pads that are placed on the mattress, the BedPro UnderMattress sensor will not compromise the pressure relieving qualities of the mattress. Placed beneath the mattress, the BedPro sensor pad stays in place to reduce false alarms. This is especially important for restless patients.

GUARANTEES

1. The BedPro Safety Alarm Unit is replacement guaranteed for one year following the date of purchase.
2. The BedPro UnderMattress Sensor Pads are replacement guaranteed for either 90 or 180 days following the date they are put into service. That date must be noted on the pad for this guarantee to be effective.

These guarantees cover defects in materials and workmanship under conditions of normal use. Please return defective part to dealer from whom it was purchased. The dealer will send the defective part to Skil-Care and arrange for shipment of a replacement.

PURPOSE

The BedPro UnderMattress Safety Alarm alerts caregivers when a patient has left or fallen from the bed.

CAUTIONS

1. The BedPro UnderMattress Safety Alarm is not a substitute for proper supervision. Staff on a regular basis should monitor fall-risk and wander-risk patients.
 2. We strongly recommend that the a/c adaptor be used as the power source.
 3. If a battery is used as power source, it must be checked each time the alarm is used to monitor a patient. If weak, replace 9-volt battery.
2. LED should glow when patient is in bed. If LED fails to glow and you are using the a/c adaptor, check connection at wall outlet and alarm unit. If you are using a battery, replace 9-volt battery.

BedPro™ Safety Alarm Unit

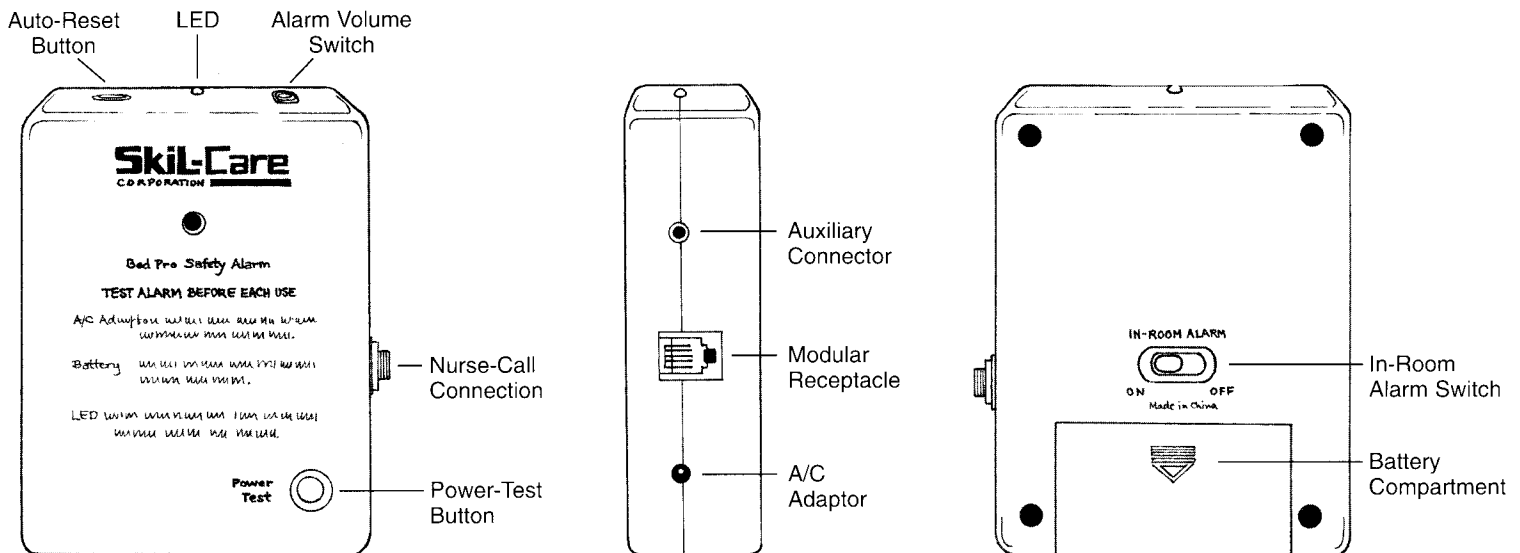

Alarm unit made in China. Instructions printed in USA.

INSTALLATION

Power Sources

1. Normal Use

Insert a/c adaptor plug into socket labeled “AC Adaptor”. (Illustration B) Plug adaptor into wall outlet. Test by pressing “Power Test” button. When testing, make certain that the “In-Room Alarm” switch on the back of the alarm unit is set to the “On” position. (Illustration A) There will be no audible signal if this switch is in the “Off” position. If alarm doesn’t sound, check adaptor connections.

2. Electrical Power Failure Mode

a. Remove battery compartment cover and install 9-volt battery. Battery should be installed and used only as a back up in case of power failure. Skil-Care does not recommend using a battery for general operation of this alarm.

For battery operation, a/c adaptor must be disconnected from alarm unit

b. Test battery by pressing the “Power Test” button on front of alarm. When testing battery, make certain that the “In-Room Alarm” switch on the back of the alarm unit is set to the “On” position. (Illustration A) The alarm signal will not sound if the switch is set to the “Off” position. If alarm fails to sound, check battery connections and retest. If alarm still doesn’t sound, replace 9-volt battery.

Nurse-Call Interface

The BedPro Safety Alarm is easily connected to the nurse-call system in your facility. It is designed to permit the regular use of the patient’s nurse-call button without activating the alarm. You may choose to have the alarm sound at bedside and the nurse’s station, or to signal only at the nurse’s station. See instructions below.

1. Set the “In-Room Alarm” switch on the back of the alarm unit to the “On” position if you want the alarm to sound both at bedside and the nurse’s station. (Illustration A) Set the switch to the “Off” position for the alarm to signal only at the nurse’s station. (Illustration C) **Important: Set the switch to the “On” position when testing the alarm. There will be no audible signal when the “In-Room Alarm” switch is set to “Off”.**

2. Insert one end of the supplied nurse-call interface cable into the receptacle labeled “Nurse-Call Connection” located on the right side of the alarm unit. (Illustration D) Mount alarm unit on headboard. To prevent patient tampering, alarm unit should face the wall.

3. Remove nurse-call button cable from wall socket and insert the enclosed Y-adaptor. (Illustration E)

4. Plug both the nurse-call button cable and the alarm nurse-call interface cable into the Y-adaptor. (Illustration F) Test operation of both the Nurse-call button and the alarm nurse-call interface by:

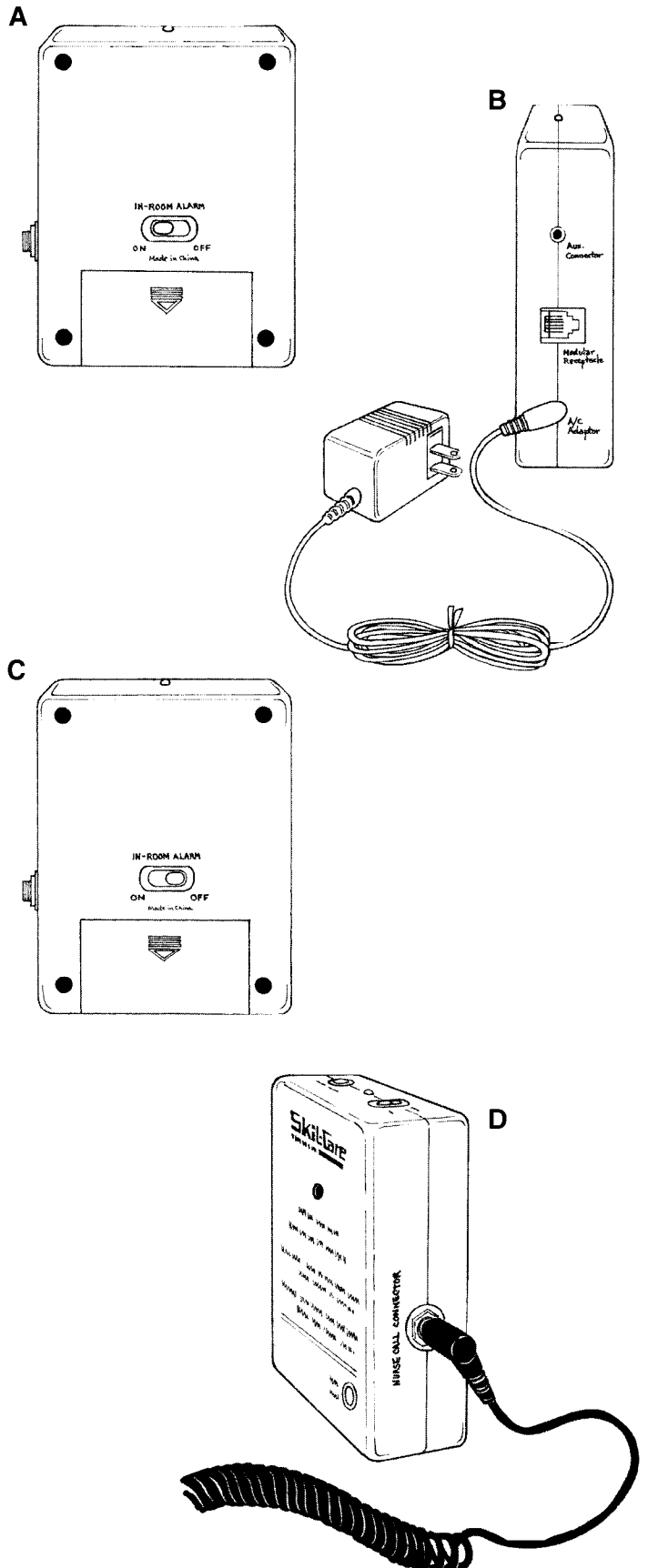

Nurse-Call Interface (Continued)

- a. pressing nurse-call button and verifying that the signal is received at nurse’s station; and
- b. pressing the “Power Test” button on the front of the alarm and verifying that the signal is received at the nurse’s station.

If either or both fail to work, check all connections and retest.

Sensor Pad

- 1. Remove mattress and place sensor pad across width of bed frame. (Illustrations G1 and G2)
- 2. Position connector cord toward headboard. The opposite end must be positioned just below the patient’s pelvis.
- 3. Pass sensor cord under headboard and plug into “Modular Receptacle” outlet on left side of alarm unit. (Illustration H) Keep cord away from side rails and out of patient’s reach.
- 4. Place mattress on bed.
- 5. Sensor pad may be cleaned with a damp cloth and mild cleanser. Do not immerse pad in water or cleaning solution. Do not sterilize.
- 6. Inspect pad before each use. Replace if damaged.

Read “Warnings” on sensor pad.

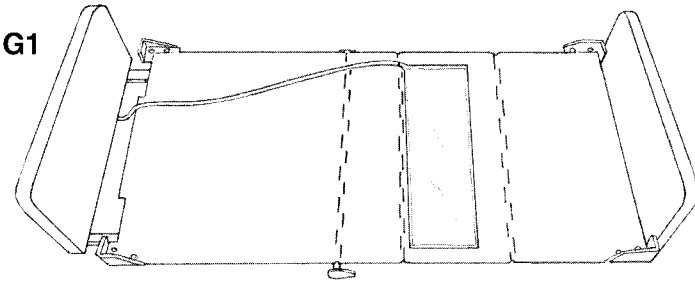
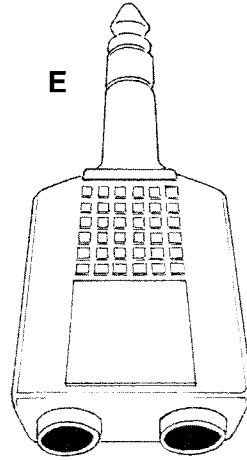

10” x 30” Sensor Pad

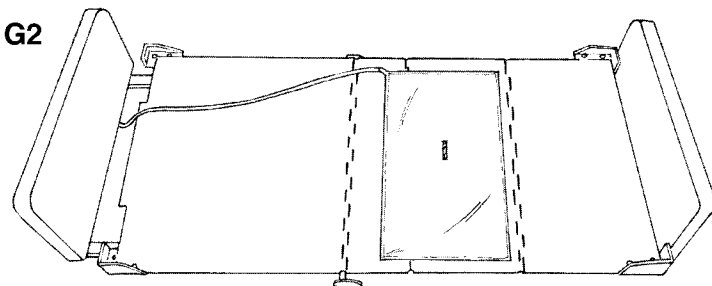

20” x 30” Sensor Pad

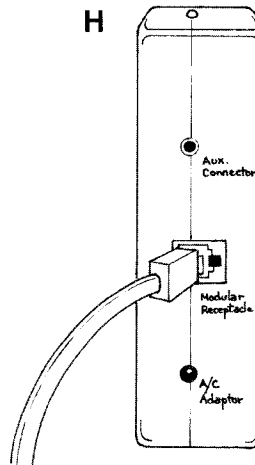
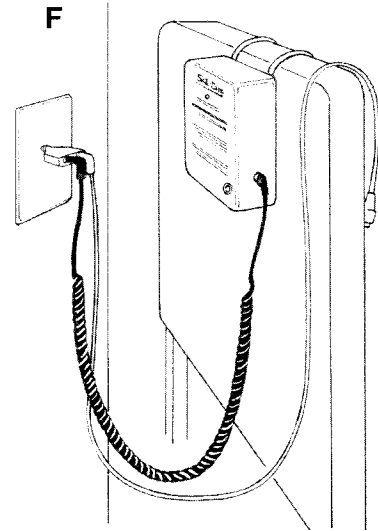

System Operation

Skil-Care's BedPro Safety Alarm is designed without an on/off switch. Whenever the alarm is initiated, pressing the "Auto-Reset" button on top of the alarm unit will silence it. Pressing this button puts the system into the stand-by mode. The system will automatically go into the monitoring mode when you put your patient to bed. There's no need to remember to turn the system on. Skil-Care recommends the following procedure for using the BedPro UnderMattress Safety Alarm.

- Press "Power Test" button before putting patient to bed. If "In-Room Alarm" switch is set to the "On" position, the alarm signal will sound and the LED will glow while the button is held down. If the "In-Room" switch is set to the "Off" position, the LED will glow while the button is held down. If the LED and/or alarm signal are not activated when button is pressed, check power source connections. If alarm is on battery power, replace 9-volt battery. Do not use alarm system if pressing "Power Test" button cannot activate LED and/or alarm signal.
- Place patient in bed. The LED should glow indicating that the alarm is in the monitoring mode. If LED does not glow, remove patient from bed and examine sensor pad. If pad is damaged, replace it. Do not use alarm system if LED does not glow when patient is in bed.
- If alarm is set to signal both at bedside and at the nurse's station, select alarm volume by moving the volume selector switch to "High" or "Low."
- If your patient leaves the bed and then returns, the alarm will silence and the system will reset itself. Be certain to visit the patient to make sure he/she is safe.
- Press the "Auto-Reset" button after you have removed your patient from bed. This will place the system in the stand-by mode.

Important: Skil-Care's BedPro UnderMattress Safety Alarm is designed to work with most mattresses and beds. However, due to variations in mattress construction, bed designs, and patient weight, the system may not work in all situations. Be certain to evaluate the system's operation for each bed and patient. If it does not work, you may want to consider Skil-Care's BedPro OverMattress Safety Alarm.

Keep a copy of these instructions in your procedures manual. If you require extra copies of these instructions, call Skil-Care at 800-431-2972.

Replacement sensor pads are available from your medical supply dealer.

Reorder #	Description	Unit
909336	BedPro Safety Alarm with Accessories	10/Pk

Skil-CareTM
CORPORATION

*Advanced design for nursing and therapy.*TM

Alarm system made in China. Instructions printed in USA.

Visit us online
at Skil-Care.com