



PORTABLE CHAIR SCALES
BEAM and DIGITAL TYPES
MODELS
475, 4751, 6475 and 6475K

FCC COMPLIANCE STATEMENT

WARNING! The 6475 and 6475K generate, use and can radiate radio frequency energy and if not installed and used in accordance with the instructions manual, may cause interference to radio communications. It has been tested and found to comply with the limits for a Class A computing device pursuant to Subpart J of Part 15 of FCC Rules, which are designed to provide reasonable protection against such interference when operated in a commercial environment. Operation of this equipment in a residential area is likely to cause interference in which case the user at his own expense will be required to take whatever measures necessary to correct the interference.

All rights reserved. Reproduction or use, without express permission, of editorial or pictorial content, in any manner, is prohibited. No patent liability is assumed with respect to the use of the information contained herein. While every precaution has been taken in the preparation of this book, we assume no responsibility for errors or omissions. Neither is any liability assumed for damages resulting from the use of the information contained herein. All instructions and diagrams have been checked for accuracy and ease of application; however, success and safety in working with tools depend to a great extent upon the individual accuracy, skill and caution. For this reason, we are not able to guarantee the result of any procedure contained herein. Nor can we assume responsibility for damage to property or injury to persons occasioned from the procedures. Persons engaging the procedures do so entirely at their own risk.

SERIAL NUMBER _____
DATE OF PURCHASE _____
PURCHASED FROM _____
RETAIN THIS INFORMATION FOR FUTURE USE

UNPACKING INSTRUCTIONS

Remove scale from its packing and inspect it for signs of shipping damage, such as exterior dents and scratches. Keep the carton and packing for return shipment or relocation if it should become necessary. It is the responsibility of the purchaser to file all claims for any damage or loss incurred during transit. If no damage is seen, then remove straps from between base and platform.

SETUP AND OPERATION

The scale has been assembled at the factory. Refer to Instructions for your model. For digital models also refer to Owner’s Manual of the digital indicator for additional information.

To use the scale, set on firm and level surface. Raise arms and footrest out of your and the patient’s way. Assist the patient to a setting position. Lower the arms and footrest. (Note: The arms and footrest are for the patient’s comfort during weighing.) After weighing the patient, raise arms and footrest out of the way and assist the patient out of the chair.

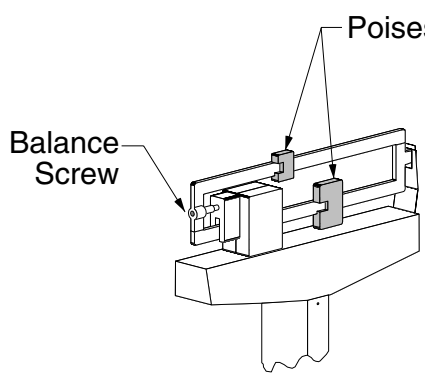
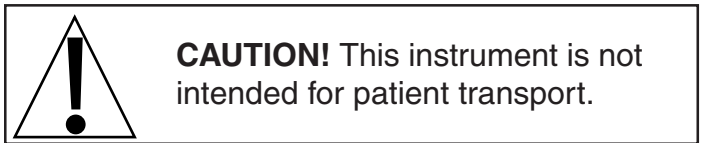

475 AND 4751
To balance scale, move both poises to zero (0) and turn balance screw to right or left until scale balances.

6475 and 6475K
Press **ON/OFF**

key to turn display on. With the display on, press the **ZERO** key to zero the weight display. Set patient on the scale as described above. When weight is stable, press the **HOLD/RELEASE** key to lock on to the weight. Note that weight value will be flashing. Read the patient weight. Remove patient from the scale and press **HOLD/RELEASE** key to unlock the display and prepare for the next weighing operation or press **ON/OFF** key to turn display off.

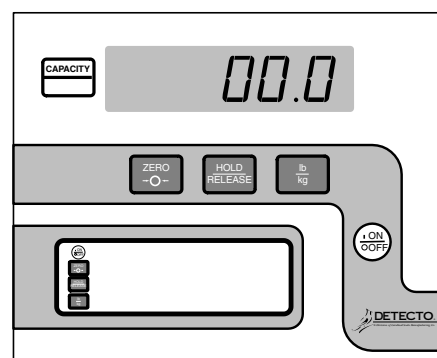

**MODELS 475 AND 4751
REPLACEMENT PART IDENTIFICATION**

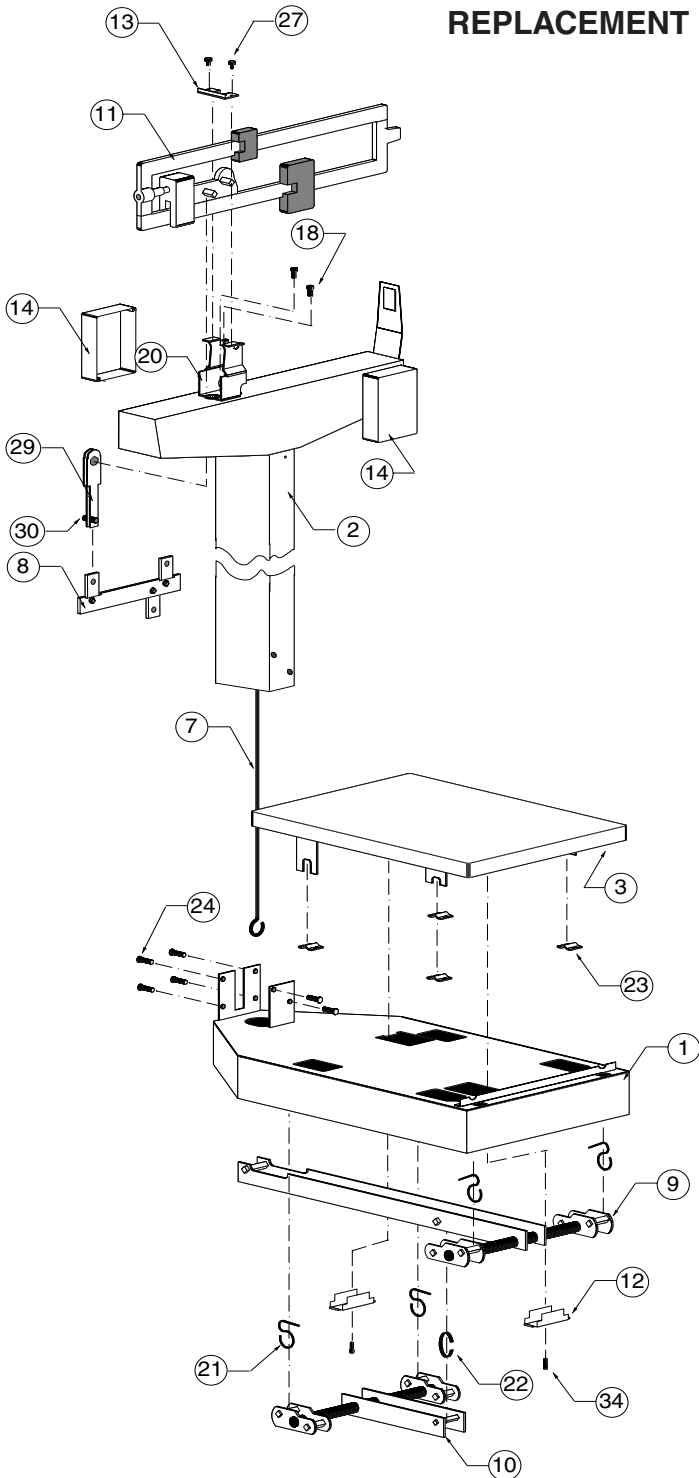

Item	Part No.	Description	Req'd
17*		#10 Internal Tooth Lockwasher	2
18		#10-32 x 1/2 lg hex head screw	2
19*		#10-32 Square Nut	2
20	3P1008	Beam Yoke	1
21	3P8059	Union Hanger	4
22	2U58	Union Center Hanger	1
23*	3P2087	Platform Bearing	4
24		1/4-20 x 3/4" lg truss head screw	6
25*		1/4 Split Lockwasher	6
26*	63K1038	Base Leg	4
27		#6 x 1/4 lg hex head type "B" Screw	2
28*	650RC7	Flatwasher	2
29	3P8034	Beam Hanger Side	2
30	3P8168	Pin	2
31*	650RV26	Flatwasher	2
32*	6550-0085	Ring Ret. "E"	4
34		#10 x 1/2 hex washer head type "B" Screw	2

*Not Shown

Item	Part No.	Description	Req'd
1	3P5001X	Base Weldment	1
2	0033-D243-0A	Headpiece and Column Weldment	1
3	3P4011X	Platform Weldment	1
4	3P4408X-1	Complete Chair Assy	1
4B	0033-C178-0A	Chair Seat Only	1
4C	3P4412	Arm Rests	2
5	3P3408X	Base Stand	1
7	13P3033	Draft Rod	1
8	3P8069X	Shelf Lever w/Pivot	1
9	3P8002X	Long Lever Assy	1
10	3P8003X	Short Lever Assy	1
11	0033-B220-1A	Beam 400 lb	1
	0033-B226-1A	Beam 400 lb/175 kg	1
12	3P60	Check Plate	2
13	3P41	Reading Beam Retainer	1
14	0033-C236-18	Beam Cover	2

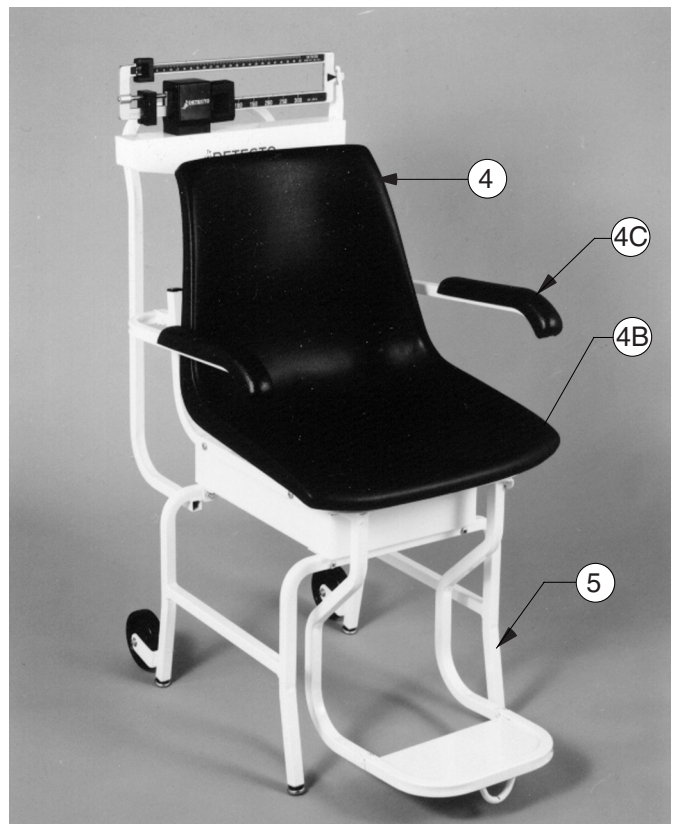

**MODELS 6475, 6475K AND 6475PK
REPLACEMENT PART IDENTIFICATION**

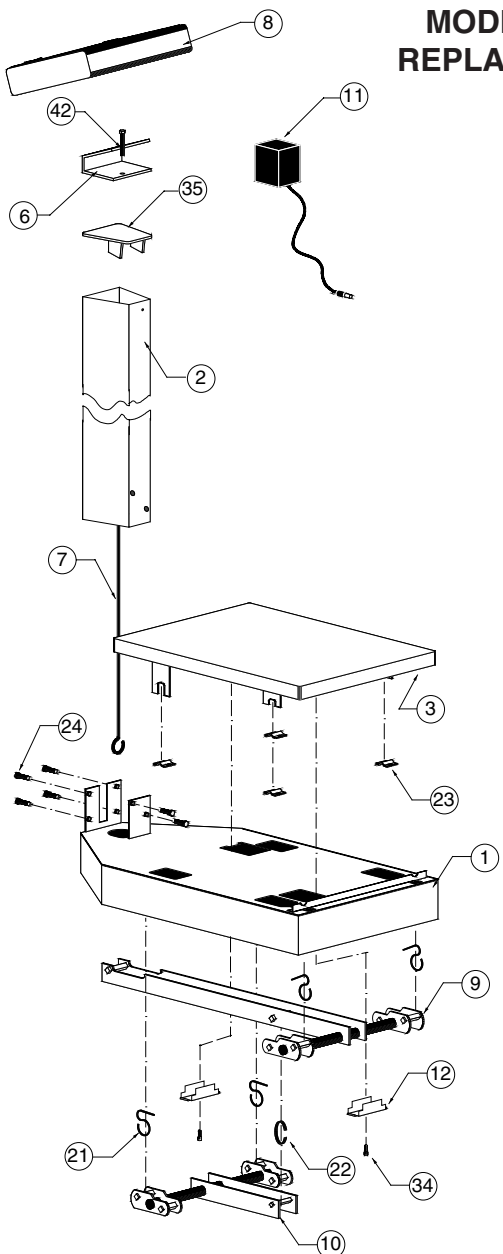

Item	Part No.	Description	Req'd
21	3P8059	Union Hanger	4
22	2U58	Union Center Hanger	1
23*	3P2087	Platform Bearing	4
24		1/4-20 x 3/4" lg Truss Head Screw	6
25*		1/4 Split Lockwasher	6
26*	63K1038	Base Leg	4
34		#10 x 1/2 Hex Washer Head Type "B" Screw	2
35	0033-B104-0A	Top Plate	1
40**		#10 Internal Tooth Lockwasher	2
42**		1/4-28 x 1 1/8 Hex Head Bolt	1
45*	0033-B110-08	UHMW Disk	1
46*	709G2R1206	Load Cell Assy	1
47**		1/4-20 Locknut	1
48**		Washer Flat 1/4	2
49*	0033-B122-0A	Stop Plate Assy	1

*Not Shown

** Standard Hardware

Item	Part No.	Description	Req'd
1	3P5001X	Base Weldment	1
2	430GR818	Column Assy	1
3	3P4011X	Platform Weldment	1
4	3P4408X-1	Complete Chair Assy	1
4B	0033-C178-0A	Chair Seat Only	1
4C	3P4412	Arm Rests	2
5	3P3408X	Base Stand	1
6	0033-B164-08	Bracket	1
7	568GR938	Shock Absorber	1
8	758C	Indicator	1
9	3P8002X	Long Lever Assy	1
10	3P8003X	Short Lever Assy	1
11	728R90	Optional Power Supply	1
		115 VAC, 60 Hz	
	728R901	230 VAC, 60 Hz	
12	3P60	Check Plate	2

