



OMEGA 2

COMMERCIAL MULTI-STATION

OWNER'S MANUAL



SERIAL NUMBER HERE

DATE OF PURCHASE



BATCA
fitness systems · usa

INSTRUCTIONS

CONGRATULATIONS ON THE PURCHASE OF YOUR NEW BATCA OMEGA 2. THIS GYM WILL PROVIDE YOU WITH A LIFETIME OF ENJOYMENT TO MEET YOUR STRENGTH TRAINING NEEDS. BATCA FITNESS SYSTEMS STRIVES TO BUILD THE BEST QUALITY GYMS AND TO PACKAGE THESE GYMS IN SUCH A WAY TO AVOID ANY DAMAGE DURING SHIPPING.

IN ORDER TO GET STARTED WITH YOUR ASSEMBLY YOU SHOULD FIRST FAMILIARIZE YOURSELF WITH THIS MANUAL. IT IS RECOMMENDED THAT YOU READ THROUGH EACH STEP THOROUGHLY BEFORE YOU BEGIN. BEGIN BY OPENING YOUR BOXES AND SEPARATING ALL OF YOUR PARTS. VERIFY THAT ALL PARTS ARE ACCOUNTED FOR AND HAVE NO DAMAGE. WHEN ALL PARTS ARE ACCOUNTED FOR, YOU MAY BEGIN YOUR ASSEMBLY. SOME ITEMS MAY HAVE BEEN PRE-ASSEMBLED FOR YOUR CONVENIENCE. PLEASE NOTE THAT HARDWARE QUANTITIES SHOWN REFLECT TOTAL QUANTITIES FOR YOUR GYM AND MAY NOT REFLECT ACTUAL QUANTITIES IN EACH BAG. ASSEMBLE YOUR GYM ON A SOLID LEVEL SURFACE. THIS WILL ENSURE THE BEST POSSIBLE PERFORMANCE, FUNCTION, AND SAFETY FOR THE GYM AND YOUR WORKOUT.

ASSEMBLE YOUR GYM ACCORDING TO THE STEP BY STEP INSTRUCTIONS FOUND IN THIS MANUAL. FAILURE TO DO SO WILL VOID YOUR WARRANTY AND MAY RESULT IN PERSONAL INJURY. AFTER ASSEMBLY, YOU SHOULD CHECK EACH STATION TO ENSURE CORRECT OPERATION. IF A PROBLEM ARISES, RECHECK YOUR ASSEMBLY WITH THESE INSTRUCTIONS TO VERIFY CORRECT ASSEMBLY. IF YOU ARE UNABLE TO CORRECT A PROBLEM OR HAVE QUESTIONS WITH YOUR ASSEMBLY PLEASE CONTACT YOUR AUTHORIZED BATCA DEALER.

WARNING

BATCA FITNESS SYSTEMS HAS BUILT THIS GYM TO GIVE YOU A SAFE, EFFECTIVE AND ENJOYABLE WORKOUT. HOWEVER, THERE IS A RISK ASSUMED BY INDIVIDUALS WHO USE THIS TYPE OF EQUIPMENT. IT IS VERY IMPORTANT THAT ALL WARNINGS AND INSTRUCTIONS ARE READ AND FOLLOWED BEFORE BEGINNING ANY EXERCISE PROGRAM.

IT IS ALSO VERY IMPORTANT TO READ AND FOLLOW THE PREVENTATIVE MAINTENANCE SCHEDULE DESCRIBED IN THIS MANUAL. IF ANY OF THE WARNING LABELS OR STICKERS ARE WORN, FADED, TORN, SCRATCHED OR MISSING THEY SHOULD BE REPLACED IMMEDIATELY.

WARNING: THERE IS A RISK ASSUMED BY INDIVIDUALS WHO USE THIS TYPE OF EQUIPMENT. TO MINIMIZE RISK ALWAYS FOLLOW THESE RULES.

- 1) IT IS ESSENTIAL THAT YOU CONSULT WITH YOUR PHYSICIAN BEFORE BEGINNING ANY EXERCISE PROGRAM.
- 2) INSPECT EQUIPMENT BEFORE EACH USE FOR LOOSE, WORN, OR FRAYED PARTS (INCLUDING CABLES, NUTS AND BOLTS). REPLACE PARTS AT FIRST SIGNS OF WEAR (USE ONLY GENUINE BATCA REPLACEMENT PARTS). USE OF EQUIPMENT THAT IS DAMAGED, WORN, FRAYED OR NOT COMPLETELY ASSEMBLED ON A SOLID, LEVEL SURFACE MAY RESULT IN INJURY.
- 3) MAKE SURE ALL ADJUSTMENT PINS ARE FULLY ENGAGED BEFORE USING EQUIPMENT.
- 4) KEEP ALL PARTS OF THE BODY AND CLOTHING OUTSIDE THE PATH OF ANY MOVING PARTS OF THE GYM. BE ALERT TO THE POSSIBILITY OF INJURY. DO NOT BE CARELESS.
- 5) MINORS AND CHILDREN SHOULD NOT BE ALLOWED TO PLAY ON OR AROUND THIS GYM.

TABLE OF CONTENTS

	PAGE		PAGE
INSTRUCTIONS	2	LEG PRESS ASSEMBLY	32-37
PARTS LISTING	3-5	FINAL ASSEMBLY AND TROUBLESHOOTING	38
HARDWARE COMPARISON	6-9	CABLE TENSION AND ADJUSTMENTS	39
MAIN ASSEMBLY	10-21	MAINTENANCE	40
UPHOLSTERY	28-31	WARRANTY	41
CABLE ROUTING	22-27	FLOOR PLAN LAYOUT	42

FRAME COMPONENTS

ITEM NO.	PART NUMBER	DESCRIPTION	QTY.
1	BFP-10968	MAIN HUB	1
2	BFP-10984	LEG EXTENSION/LEG CURL BASE	1
3	BFP-10971	REAR BRACE FRAME	1
4	BFP-10969	CHEST PRESS/MID ROW BASE	1
5	BFP-10975	CHEST PRESS/MID ROW UPRIGHT FRAME	1
6	BFP-10974	TOP FRAME	1
7	BFP-51768	CURVED ANTI-DEFLECTION PLATE	1
8	BFP-52213	ANTI-DEFLECTION PLATE	1
9	BFP-10972	ANTI-DEFLECTION PLATE WITH LEG	1
10	BFP-10973	ANTI-DEFLECTION PLATE WITH LEG	1
11	BFP-10990	REAR BOTTOM BRACE (RIGHT)	1
12	BFP-11016	J BRACE/BEARING HOUSING	1
13	BFP-11015	LEG EXTENSION/LEG CURL FRAME	1
14	BFP-11027	FRAME SUPPORT BRACE	1
15	BFP-52132	ANTI-DEFLECTION PLATE	1
16	BFP-52159	ANTI-DEFLECTION PLATE	1
17	BFP-52408	ANTI-DEFLECTION PLATE	1
18	BFP-10873	LEFT HANDLE	1
19	BFP-10872	RIGHT HANDLE	1
20	BFP-10867	LEG EXT./LEG CURL CAM	1
21	BFP-10868	LEG EXT./LEG CURL ARM	1
22	BFP-52364	6" COUNTER WEIGHT	1
23	BFP-10871	KNEE ALIGNMENT ROLLER	1
24	BFP-52177	AXLE	1
25	BFP-10870	KNEE HOLD DOWN ASSEMBLY	1
26	BFP-52201	KNEE HOLD DOWN CAM	1
27	BFP-51909	AXLE	1
28	BFP-10948	BACK CHROME ADJUSTMENT	1
29	BFP-10978	CHEST PRESS/MID ROW SWING	1
30	BFP-11025	USER RIGHT FUNCTIONAL ARM	1
31	BFP-11017	SWIVEL PULLEY HOLDER	1
32	BFP-51800	CURVED ANTI-DEFLECTION PLATE	1

ITEM NO.	PART NUMBER	DESCRIPTION	QTY.
33	BFP-51776	AXLE	1
34	BFP-10979	CHEST PRESS/MID ROW ARM	1
35	BFP-10980	CHEST/BACK CHROME ADJUSTMENT	1
36	BFP-52370	AXLE	1
37	BFP-11013	CHROME SEAT ADJUSTMENT	1
38	BFP-10976	FRONT GUIDE ROD/PULLEY HOLDER	1
39	BFP-10977	REAR GUIDE ROD/DOUBLE PULLEY HOLDER	1
40	BFP-52227	LONG GUIDE ROD	2
41	BFP-52226	SHORT GUIDE ROD	2
42	BFM-10299	TOP WEIGHT PLATE	2
43	BFM-50256	WEIGHT STACK PLATE	38
44	BFP-52143	RUBBER DONUT	4
45	BFP-52165	DOUBLE PULLEY PLATE	2
47	BFP-51883	DOUBLE PULLEY COVER	1
48	BFM-10588	KNEE HOLD DOWN HANDLE	1
49	BFP-52267	FRONT SHROUD WITH LOGO	1
50	BFP-52269	REAR SHROUD WITH LOGO	1
51	BFP-52268	FRONT SHROUD	1
52	BFP-52271	REAR SHROUD	1
53	BFP-52383	GUIDE ROD SLEEVE	2
141	BFP-11026	USER LEFT FUNCTIONAL ARM	1
142	BFM-50345	4 1/2" PULLEY COVER	4
143	BFP-52412	SPACER	4
145	BFP-11022	FREE FLOATER WITH STOP	1

ACCESSORIES

ITEM NO.	PART NUMBER	DESCRIPTION	QTY.
54	BFM-51173	RED AND YELLOW WEIGHT STACK PULL PIN	2
55	BFC-50122	AB STRAP	1
56	BFC-50125	LAT PULL BAR	1
57	BFC-50126	SHORT BAR	1
146	BFC-10103	STRAP HANDLE	2
147	BFC-50135	22" ANKLE STRAP	1

HARDWARE

ITEM NO.	PART NUMBER	DESCRIPTION	QTY.
58	BFH-50165	1" SNAP RING	4
59	BFP-51885	RED PIVOT POINT CAP	1
60	BFP-51696	SMALL ALUMINUM END CAP	4
61	BFH-50210	GAS SPRING	1
62	2xBFC-50128	2 LINK CHAIN	1
63	14xBFC-50128	14 LINK CHAIN	1
64	BFH-50622	LARGE ALUMINUM END CAP	6
65	BFH-50188	SNAP HOOK	4
66	BFH-50221	3" PLASTIC WASHER	4
67	BFP-51746	1/2" PULLEY SPACERS	8
68	BFH-50173	3 1/2" PULLEY	5
69	BFH-50174	4 1/2" PULLEY	22
70	BFP-11037	FREE FLOATER WITH LOCKOUT	1
71	BFP-52372	SHCS 5/16" x 1/2"	3
72	BFP-52430	BHSCS 3/8" x 3/4"	14
73	BFH-50144	FHSCS 3/8" x 1"	2
74	BFH-50245	FHSCS 5/16 x 1"	2
75	BFH-50620	BHSCS 3/8" x 1"	5
76	BFP-51653	SHCS 3/8" x 1 1/4"	8
77	BFH-50351	1 3/8" SHOULDER BOLT	4
78	BFP-52377	FHSCS 3/8" x 2"	2
79	BFP-51759	SHCS 3/8" x 2"	9
80	BFP-51752	SHCS 3/8" x 2 1/4"	18
81	BFP-52382	SHCS 3/8" x 2 1/2"	4
82	BFP-51750	SHCS 3/8" x 2 3/4"	8
83	BFP-51748	SHCS 3/8" x 3 1/4"	12
84	BFP-51747	SHCS 3/8" x 3"	8
85	BFP-51884	SHCS 3/8" x 4 1/4"	2
87	BFP-51756	SHCS 3/8" x 5 1/4"	4
88	BFP-52364	SHCS 3/8" x 6"	1
89	BFH-50267	5/16" NYLOCK	4
90	BFH-50147	3/8" LOCK WASHER	8
91	BFH-50204	3/8" CURVED WASHER	10
92	BFH-50146	3/8" FLAT WASHER	117
93	BFH-50157	3/8" NYLOCK	67
145	BFH-52520	SCHS 3/8" x 5 3/4"	2

UPHOLSTERY

ITEM NO.	PART NUMBER	DESCRIPTION	QTY.
94	BFP-52136	BACK PAD WITH LUMBAR	2
95	BFP-52141	BOTTOM PAD	1
96	BFU-10121	7" UPHOLSTERED ROLLER	6
97	BFP-52130	LARGE BOTTOM PAD	1
98	BFU-10122	17" UPHOLSTERED ROLLER	1

CABLES

ITEM NO.	PART NUMBER	DESCRIPTION	QTY.
99	CAB-14018	WEIGHT STACK TO SWIVEL PULLEY	1
100	CAB-14015	FREE FLOATER TO MID PULLEY	1
101	CAB-14013	WEIGHT STACK TO LOCKOUT	1
102	CAB-14012	FREE FLOATER LEG EXTENSION CAM	1
144	CAB-14014	FUNTIONAL ARM TO FUNCTIONAL ARM	1

TOOLS REQUIRED

- 9/16" WRENCH
- 9/16" RATCHET
- ALLEN WRENCH SET
- TAPE MEASURE

- 1/2" WRENCH
- 1/2" RATCHET
- 3/4" WRENCH
- SNAP RING PLIERS

LEG PRESS COMPONENTS

ITEM NO.	PART NUMBER	DESCRIPTION	QTY.
103	BFP-10992	REAR BOTTOM BRACE (LEFT) OPTIONAL*	1
104	BFP-10973	ANTI-DEFLECTION PLATE WITH LEG	1
105	BFP-10838	FREE FLOATER	1
106	BFP-11021	PULLEY SUPPORT PLATE WITH LEVELER	1
107	BFP-10981	LEG PRESS BASE	1
108	BFP-52164	ANTI-DEFLECTION PLATE	1
109	BFP-10982	LEG PRESS FRAME	1
110	BFP-10860	LEFT HANDLE	1
111	BFP-10861	RIGHT HANDLE	1
112	BFP-52159	ANTI DEFLECTION PLATE	1
113	BFP-10851	FOUR ARM	2
114	BFP-10852	PIVOT ARM	1
115	BFP-10853	LEG PRESS FOOT PLATE	1
116	BFP-10983	BACK CHROME ADJUSTMENT	1
117	BFM-50345	PULLEY COVER	1

UPHOLSTERY

ITEM NO.	PART NUMBER	DESCRIPTION	QTY.
118	BFP-52136	BACK PAD WITH LUMBAR	1
119	BFP-52130	LARGE BOTTOM PAD	1

HARDWARE

ITEM NO.	PART NUMBER	DESCRIPTION	QTY.
120	BFH-50174	4 1/2" PULLEY	8
121	BFH-51696	SMALL ALUMINUM END CAP	2
122	BFP-51746	1/2" PULLEY SPACER	4
123	BFP-52430	SHCS 5/16" x 1/2"	2
124	BFH-50620	BHSCS 3/8" x 1"	4
125	BFP-51653	SHCS 3/8" x 1 1/4"	4
126	BFH-50250	1 1/4" SHOULDER BOLT	1
127	BFP-51759	SHCS 3/8" x 2"	1
128	BFP-51752	SHCS 3/8" 2 1/4"	4
129	BFP-52382	SHCS 3/8" x 2 1/2"	2
130	BFP-51750	SHCS 3/8" x 2 3/4"	2
131	BFP-51747	SHCS 3/8" x 3"	2
132	BFP-51748	SHCS 3/8" x 3 1/4"	4
133	BFP-51799	SHCS 3/8" x 5"	2
134	BFH-50267	5/16" NYLOCK	1
135	BFH-50204	3/8" CURVED WASHER	4
136	BFH-50146	3/8" FLAT WASHER	30
137	BFH-50157	3/8" NYLOCK	20
138	BFH-50147	3/8" LOCK WASHER	4

CABLE

ITEM NO.	PART NUMBER	DESCRIPTION	QTY.
139	CAB-14008	WEIGHT STACK TO LEG PRESS FREE FLOATER	1
140	CAB-14011	FREE FLOATER TO CABLE LOCKOUT	1

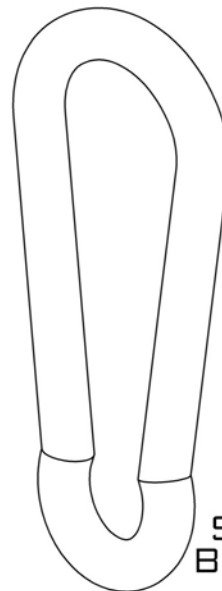
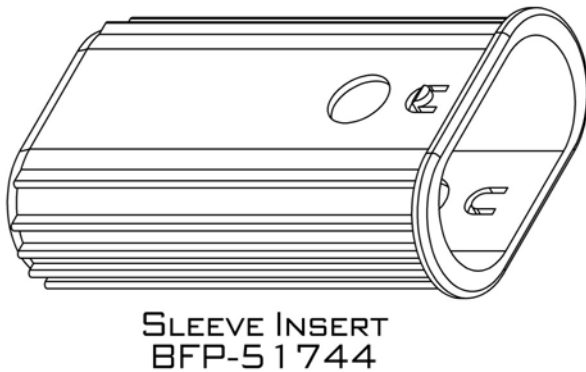
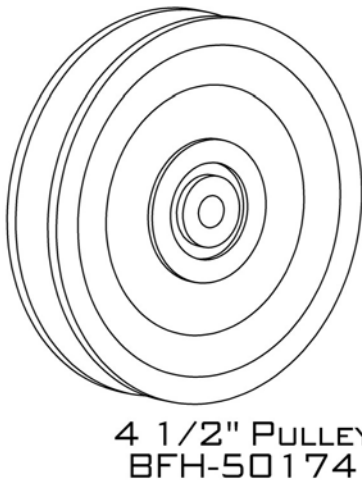
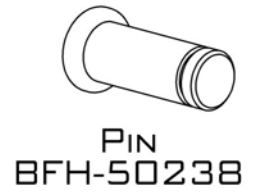
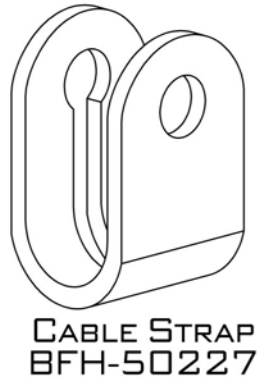
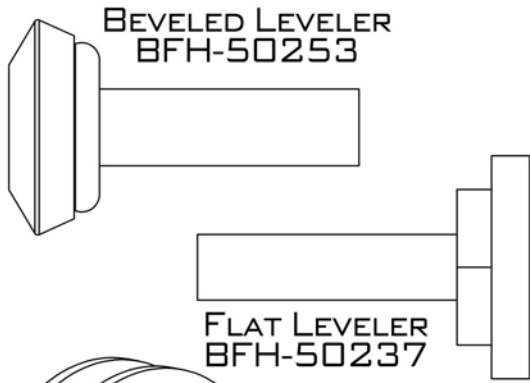

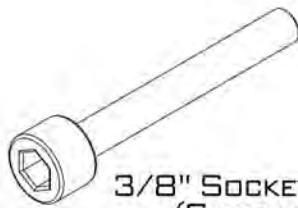

3/8" SOCKET HEAD CAP SCREW
(SIZES LISTED IN CHART)

PART #	BOLT SIZE
BFP-52340	3/8" x 3/4"
BFP-52376	3/8" x 1"
BFP-51653	3/8" x 1 1/4"
BFP-51697	3/8" x 1 1/2"
BFP-51759	3/8" x 2"
BFP-51752	3/8" x 2 1/4"
BFP-51750	3/8" x 2 3/4"
BFP-51747	3/8" x 3"
BFP-51748	3/8" x 3 1/4"
BFP-51760	3/8" x 3 1/2"
BFP-52345	3/8" x 4"
BFP-51884	3/8" x 4 1/4"
BFP-51751	3/8" x 4 1/2"
BFP-51753	3/8" x 4 3/4"
BFP-51799	3/8" x 5"
BFP-51756	3/8" x 5 1/4"
BFP-52364	3/8" x 6"

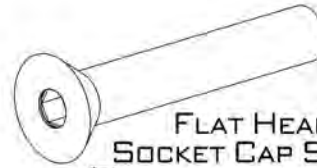

FLAT HEAD SOCKET CAP SCREW
(SIZES LISTED IN CHART)

PART #	BOLT SIZE
BFH-50144	FHSCS 3/8"-16 x 1"
BFP-52377	FHSCS 3/8" x 2"
BFH-50145	FHSCS 3/8"-16 x 2 1/4"
BFP-52374	FHSCS 3/8" x 2 3/4"

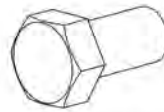

HEX HEAD CAP SCREW (HCS) 3/8" x 3/4"
(BFH-50254)

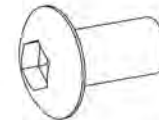

BUTTON HEAD SOCKET CAP SCREW (BHSCS) 3/8" x 3/4"
BFP-52430

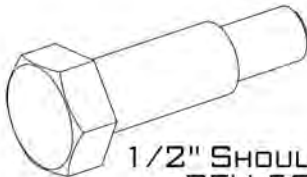

1/2" SHOULDER BOLT
BFH-50249

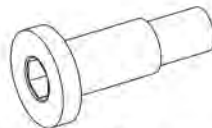

1 1/4" SHOULDER BOLT
BFH-50250



ZINC PLATED SHCS 5/16" x 1/2"
(BFP-52372)



5/16"-18 NYLOCK
BFH-50267



3/8"-16 THIN NYLOCK
BFH-50247



3/8"-16 NYLOCK
BFH-50157



1/2"-13 NYLOCK
BFH-50251



1/2" JAM NUT
BFH-50256



3/8" JAM NUT
BFH-50149

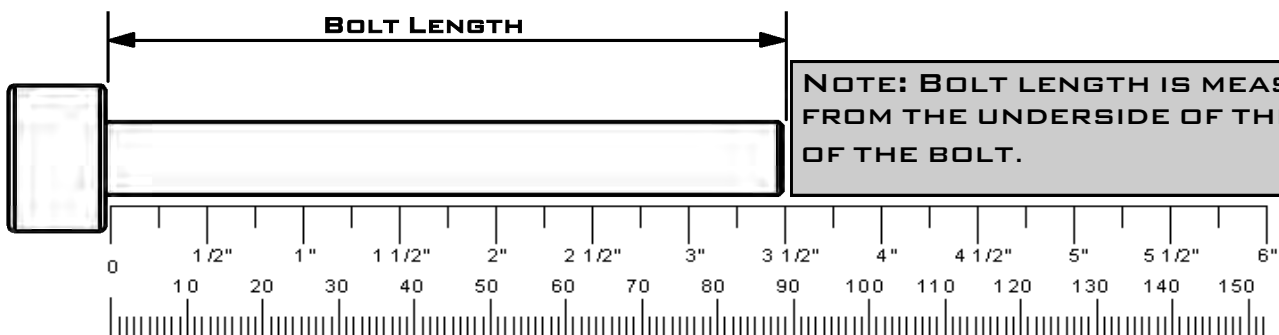

NOTE: BOLT LENGTH IS MEASURED FROM THE UNDERSIDE OF THE HEAD OF THE BOLT.

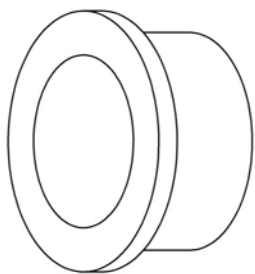

1" BRONZE BUSHING
BFH-50101

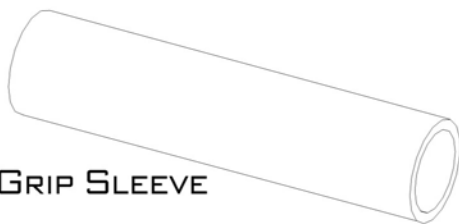

GRIP SLEEVE

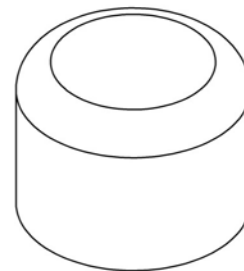

1" OUTER PLASTIC CAP
BFH-50111



GRIP CAP



GRIP COLLAR

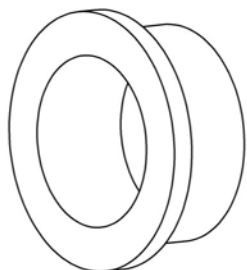

1" BRONZE BUSHING x 1/2 L
BFH-50297

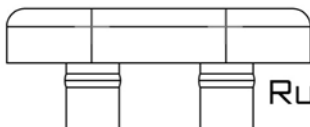

BFH-50222

RUBBER BUMPERS

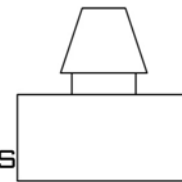

BFH-50200



5/8" BRONZE BUSHING
BFH-50102

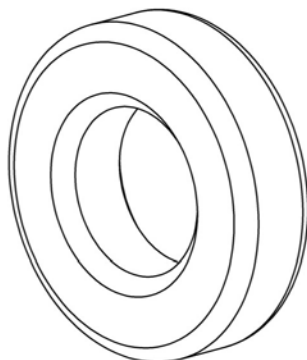

RADIAL BEARING
BFH-50602

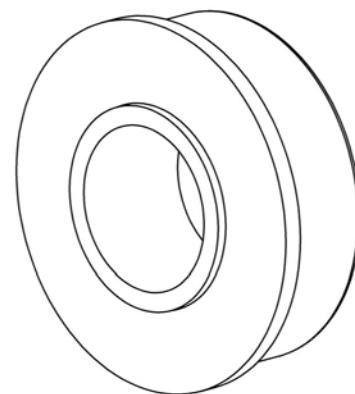

FLANGED RADIAL BEARING
BFP-51949

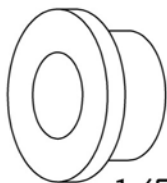

1/2" BRONZE BUSHING
BFH-50103



CABLE PIVOT BUSHING
BFH-50248

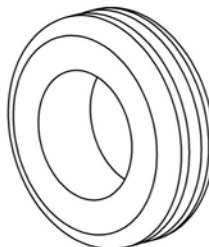

RUBBER GROMMET
BFH-50199



SHORT 1/2" BUSHING
BFH-50244



1/2" SNAP RING
BFH-50166

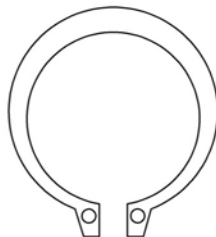

1" SNAP RING
BFH-50165

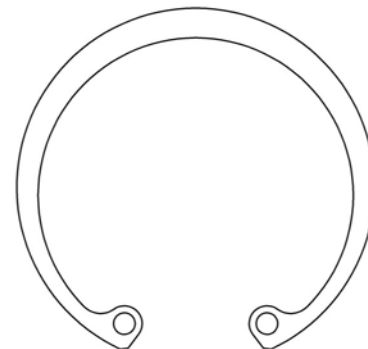

2 1/2" SNAP RING
BFH-50604

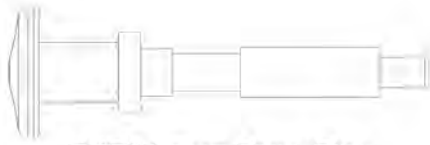

3/8" LONG PULL PIN
BFM-51176

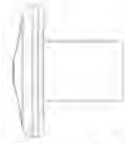

PULL PIN HANDLE
BFM-51181



PLASTIC END CAP
(BFP-52101)



1/2" LONG PULL PIN
BFM-51172

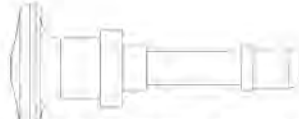

3/8" SHORT PULL PIN
BFM-51175

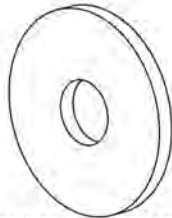

3/8" FENDER WASHER
BFH-50242



3/8" FLAT WASHER
BFH-50146



3/8" CURVED WASHER
BFH-50204

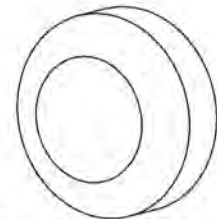

SCREW CAP COVER
BFH-50112



SCREW CAP WASHER
BFH-50113



3/8" LOCK WASHER
BFH-50147



MAGNETIC WEIGHT STACK PIN
BFM-51173

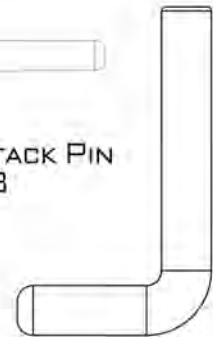

BAR CATCH RUBBER
SLEEVE
BFH-50240

ITEMS NOT SHOWN.

PART #	DESCRIPTION
BFH-50259	MIDNIGHT BLACK PAINT
BFH-50278	SILVER METALLIC PAINT
BFH-50198	LARGE LOGO
BFH-50236	FOAM GRIP
BFH-50262	SILICON GEL PACK
BFC-10101	1 INCH CHAIN
BFC-10102	1 1/2 INCH CHAIN

SIDE MOUNTED
FLANGE BEARING
BFH-50171

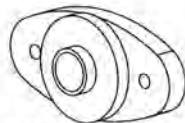

LINEAR BEARING
BFH-50627

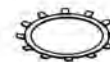

BEARING RETAINING
CLIP
BFH-50628



PLEASE FOLLOW ALL DIRECTIONS VERY CAREFULLY FOR PROPER INSTALLATION.

STEP 1:



NOTE: FOR A MORE CONSISTENT APPEARANCE, POSITION ALL BOLTS IN THE DIRECTION SHOWN IN EACH FIGURE.

ALL FLAT WASHERS AND NYLOCKS ARE 3/8" UNLESS OTHERWISE NOTED. ANYWHERE A WASHER IS AGAINST THE ROUND SIDE OF A TUBE THERE IS TO BE A 3/8" CURVED WASHER INSTEAD OF A



DO NOT TIGHTEN BOLTS UNTIL STEP 4

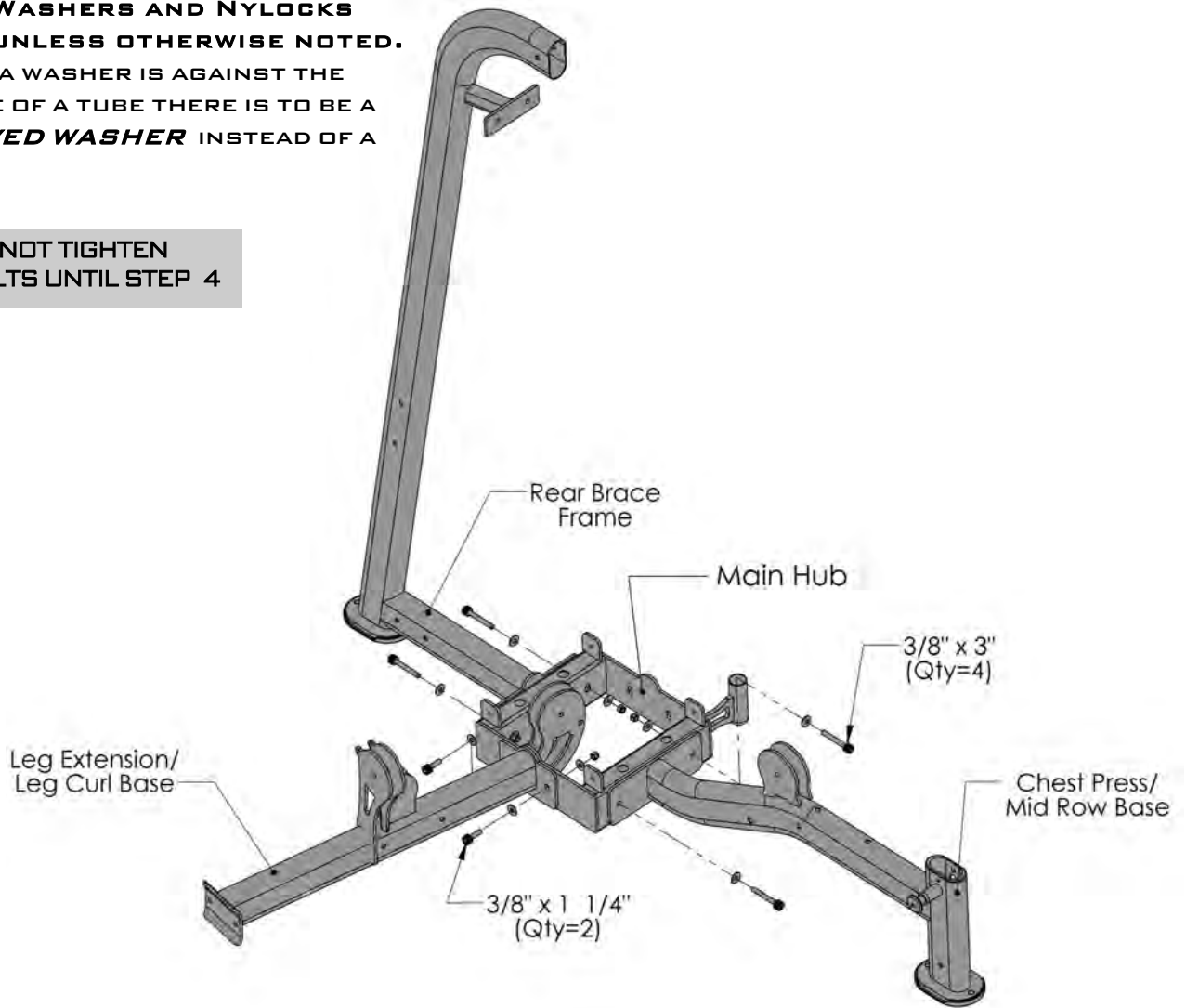

ITEM #	PART #	DESCRIPTION	QTY
1	BFP-10968	MAIN HUB	1
2	BFP-10984	LEG EXTENSION/LEG CURL BASE	1
3	BFP-10971	REAR BRACE FRAME	1
4	BFP-10969	CHEST PRESS/MID ROW BASE	1
76	BFP-51653	SHCS 3/8" x 1 1/4"	2
84	BFP-51747	SHCS 3/8" x 3"	4
92	BFH-50146	3/8" FLAT WASHER	12
93	BFH-50157	3/8" NYLOCK	6

STEP 2:



SKIP THIS STEP IF LEG PRESS WAS PURCHASED.

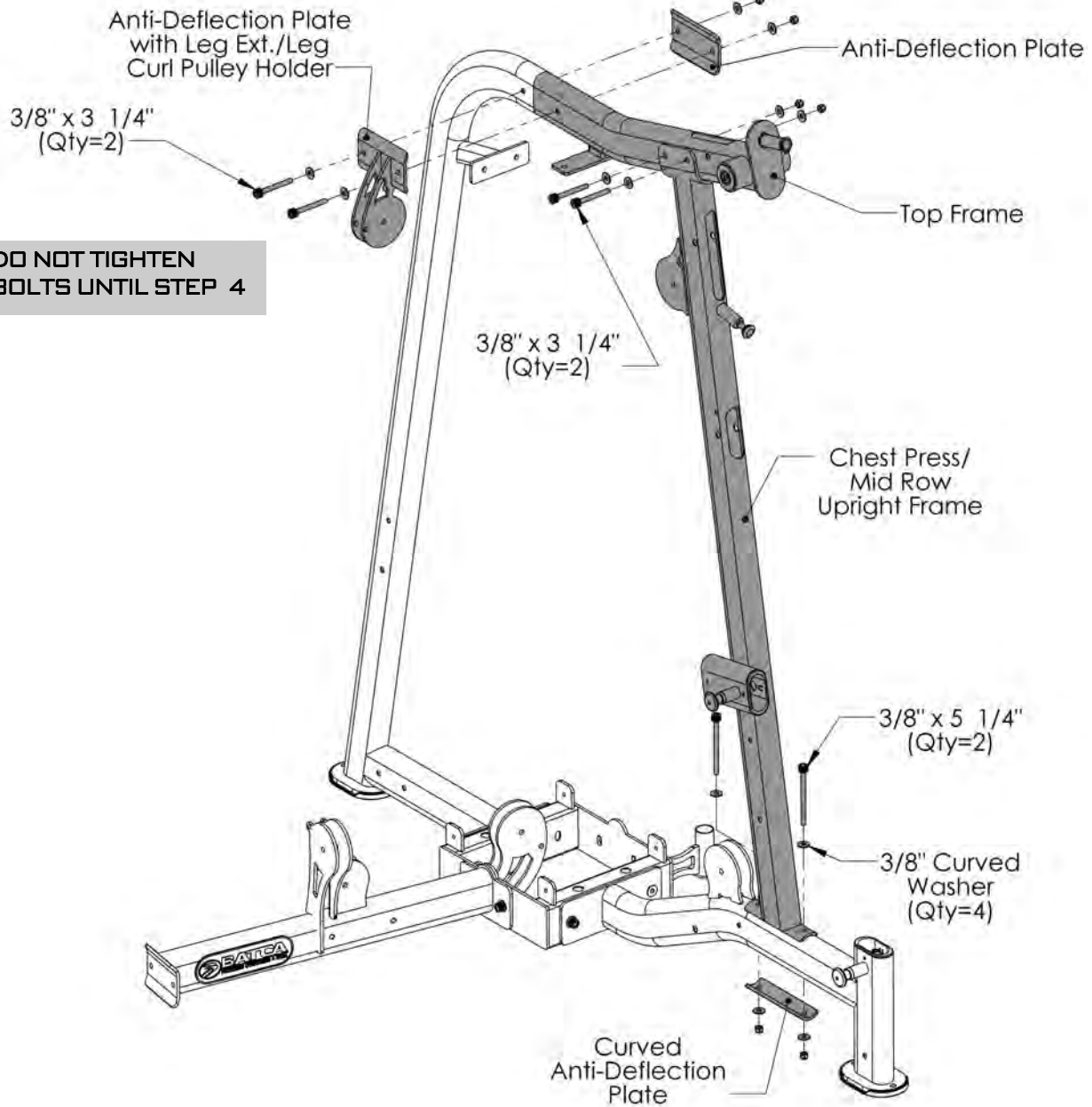

DO NOT TIGHTEN BOLTS UNTIL STEP 4

ALL FLAT WASHERS AND NYLOCKS ARE 3/8" UNLESS OTHERWISE NOTED. ANYWHERE A WASHER IS AGAINST THE ROUND SIDE OF A TUBE THERE IS TO BE A **3/8" CURVED WASHER** INSTEAD OF A **3/8" FLAT WASHER**.

ITEM #	PART #	DESCRIPTION	QTY
5	BFP-10975	CHEST PRESS/MID ROW UPRIGHT FRAME	1
6	BFP-10974	TOP FRAME	1
7	BFP-51768	CURVED ANTI-DEFLECTION PLATE	1
8	BFP-52213	ANTI-DEFLECTION PLATE	1
10	BFP-10973	ANTI-DEFLECTION PLATE WITH LEG EXT./LEG CURL PULLEY HOLDER	1
83	BFP-51748	SHCS 3/8" x 3 1/4"	4
87	BFP-51756	SHCS 3/8" x 5 1/4"	2
91	BFH-50204	3/8" CURVED WASHER	4
92	BFH-50146	3/8" FLAT WASHER	8
93	BFH-50157	3/8" NYLOCK	6

STEP 2A:



FOLLOW THIS STEP IF LEG PRESS WAS PURCHASED.

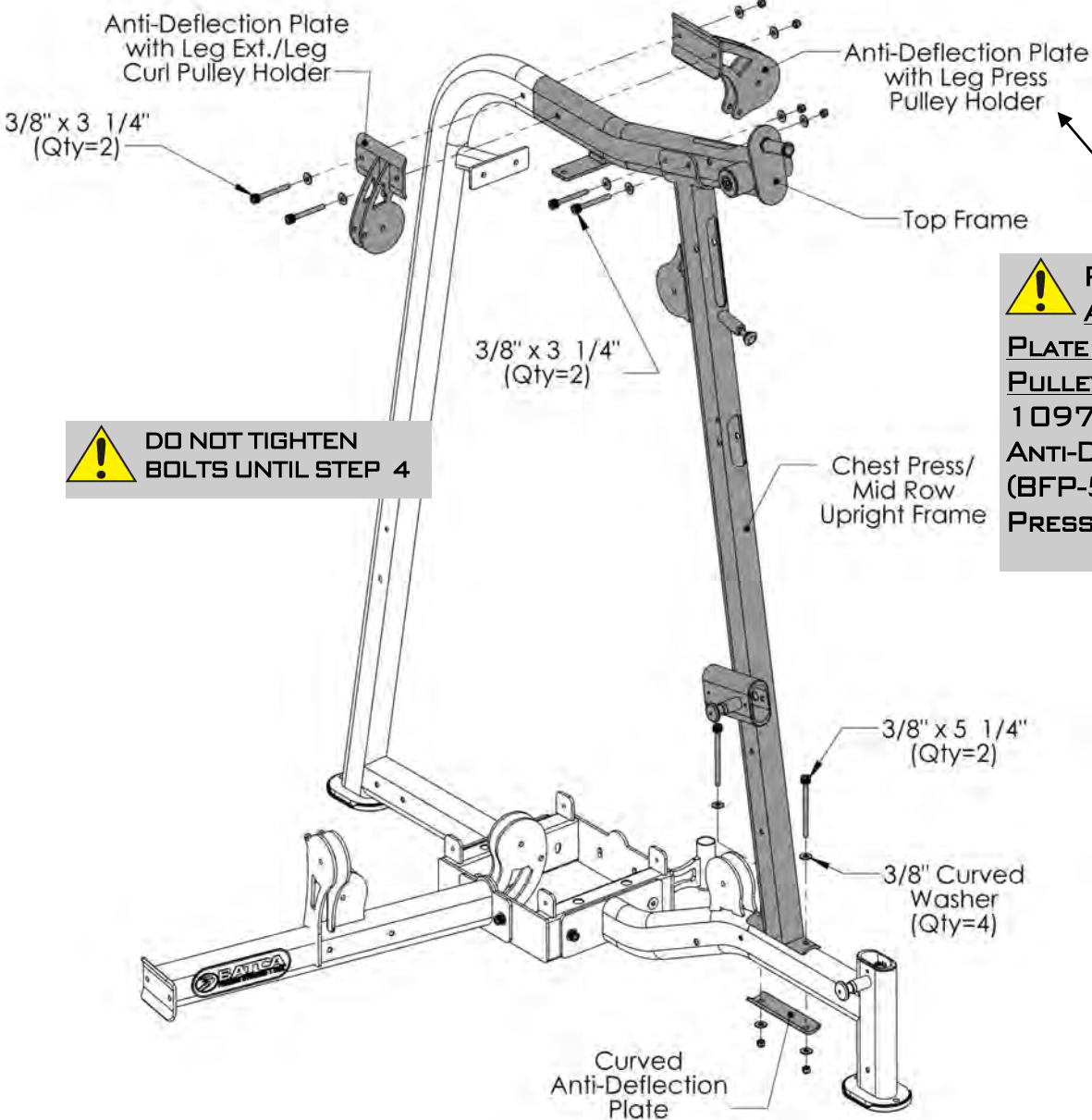

DO NOT TIGHTEN BOLTS UNTIL STEP 4

PLEASE INSTALL THE ANTI-DEFLECTION PLATE WITH LEG PRESS PULLEY HOLDER (BFP-10973) INSTEAD OF JUST ANTI-DEFLECTION PLATE (BFP-51223) IF LEG PRESS WAS PURCHASED.

ALL FLAT WASHERS AND NYLOCKS ARE 3/8" UNLESS OTHERWISE NOTED. ANYWHERE A WASHER IS AGAINST THE ROUND SIDE OF A TUBE THERE IS TO BE A **3/8" CURVED WASHER** INSTEAD OF A **3/8" FLAT WASHER**.

ITEM #	PART #	DESCRIPTION	QTY
5	BFP-10975	CHEST PRESS/MID ROW UPRIGHT FRAME	1
6	BFP-10974	TOP FRAME	1
7	BFP-51768	CURVED ANTI-DEFLECTION PLATE	1
9	BFP-10972	ANTI-DEFLECTION PLATE WITH LEG PRESS PULLEY HOLDER	1
10	BFP-10973	ANTI-DEFLECTION PLATE WITH LEG EXT./LEG CURL PULLEY HOLDER	1
83	BFP-51748	SHCS 3/8" x 3 1/4"	4
84	BFP-51756	SHCS 3/8" x 5 1/4"	2
91	BFH-50204	3/8" CURVED WASHER	4
92	BFH-50146	3/8" FLAT WASHER	8
93	BFH-50157	3/8" NYLOCK	6

STEP 3:



DO NOT INSTALL THE *REAR BOTTOM BRACE (LEFT)* IF OPTIONAL LEG PRESS WAS NOT PURCHASED AND USE SHCS 3/8" X 3" BOLTS INSTEAD OF SHCS 3/8" X 3 1/4".



DO NOT TIGHTEN BOLTS UNTIL STEP 4

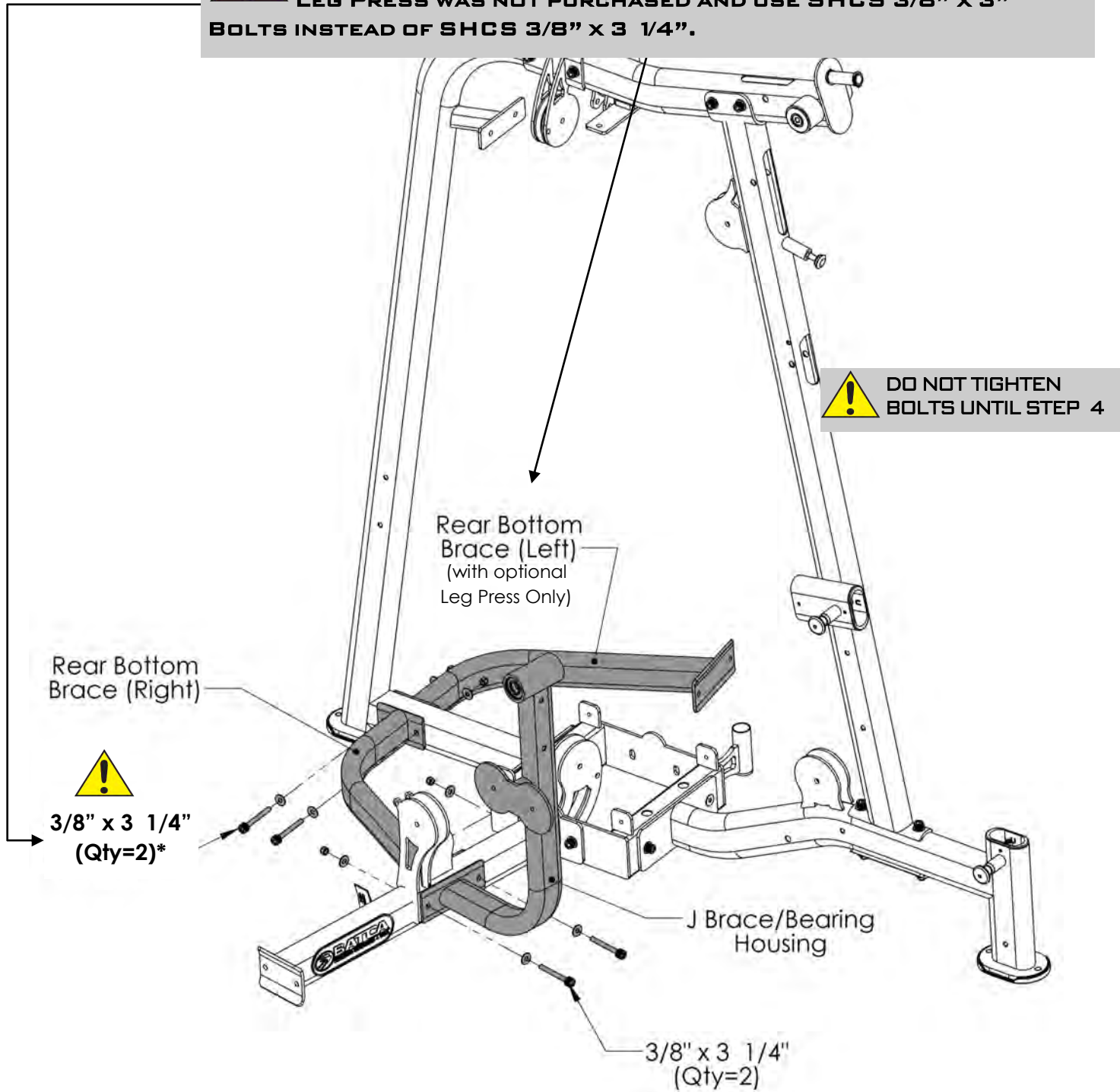

ITEM #	PART #	DESCRIPTION	QTY
11	BFP-10990	REAR BOTTOM BRACE (RIGHT)	1
103	BFP-10992	REAR BOTTOM BRACE (LEFT) OPTIONAL*	1
12	BFP-11016	J BRACE/BEARING HOUSING	1
132	BFP-51748	SHCS 3/8" X 3 1/4"*	4
92	BFH-50146	3/8" FLAT WASHER	8
93	BFH-50157	3/8" NYLOCK	4

ALL FLAT WASHERS AND NYLOCKS ARE 3/8" UNLESS OTHERWISE NOTED.

STEP 4:



MAKE SURE ALL BOLTS ARE TIGHTENED BEFORE MOVING ON. AND IT IS IMPORTANT THAT THE MAIN HUB IS SITTING FLAT ON THE FLOOR BEFORE AND AFTER ALL BOLTS ARE TIGHTENED.

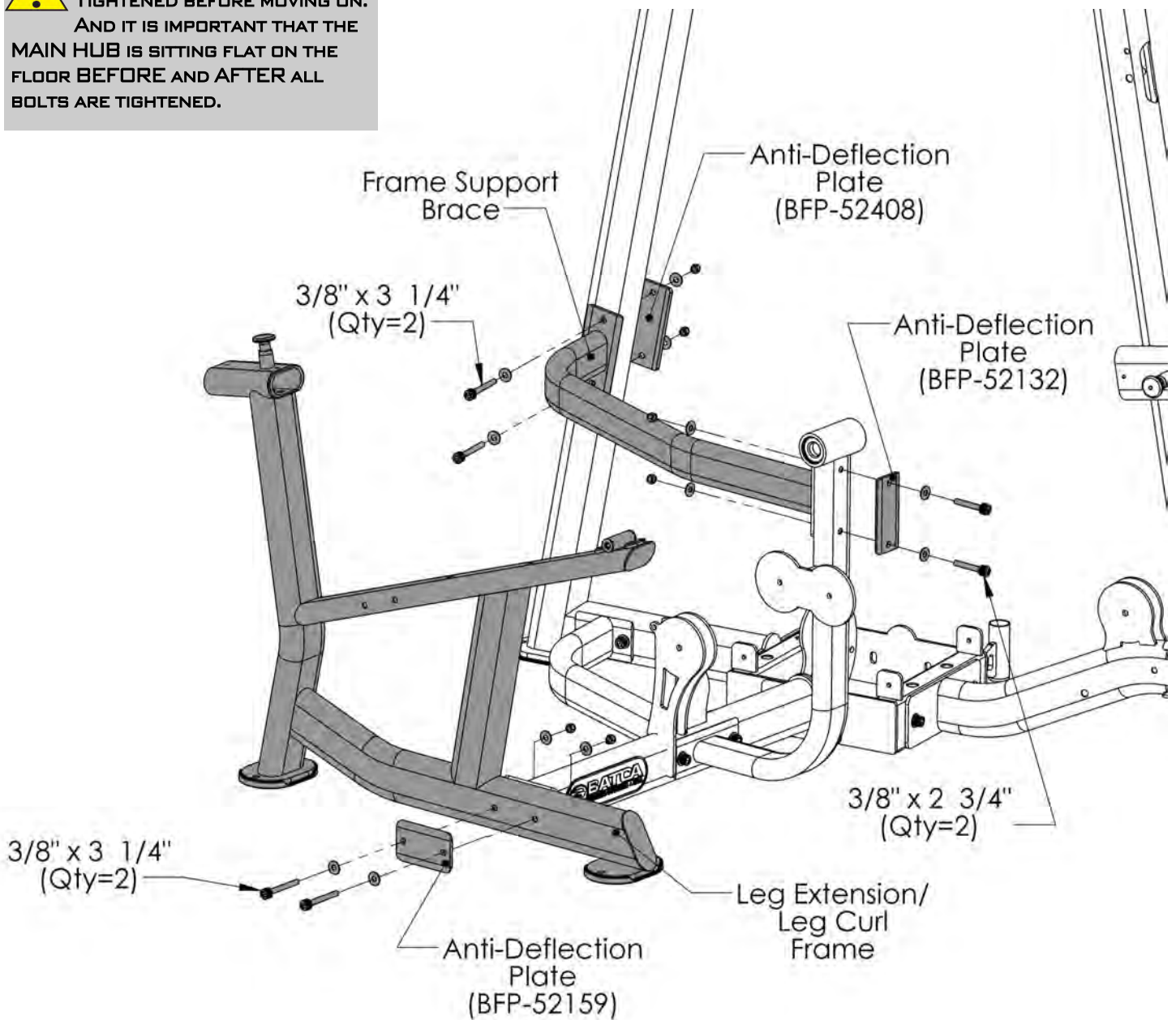

ITEM #	PART #	DESCRIPTION	QTY
13	BFP-11015	LEG EXTENSION/LEG CURL FRAME	1
14	BFP-11027	FRAME SUPPORT BRACE	1
15	BFP-52132	ANTI-DEFLECTION PLATE	1
16	BFP-52159	ANTI-DEFLECTION PLATE	1
17	BFP-52408	ANTI-DEFLECTION PLATE	1
82	BFP-51750	SHCS 3/8" x 2 3/4"	2
83	BFP-51748	SHCS 3/8" x 3 1/4"	4
92	BFH-50146	3/8" FLAT WASHER	12
93	BFH-50157	3/8" NYLOCK	6

ALL FLAT WASHERS AND NYLOCKS ARE 3/8" UNLESS OTHERWISE NOTED.

STEP 5:

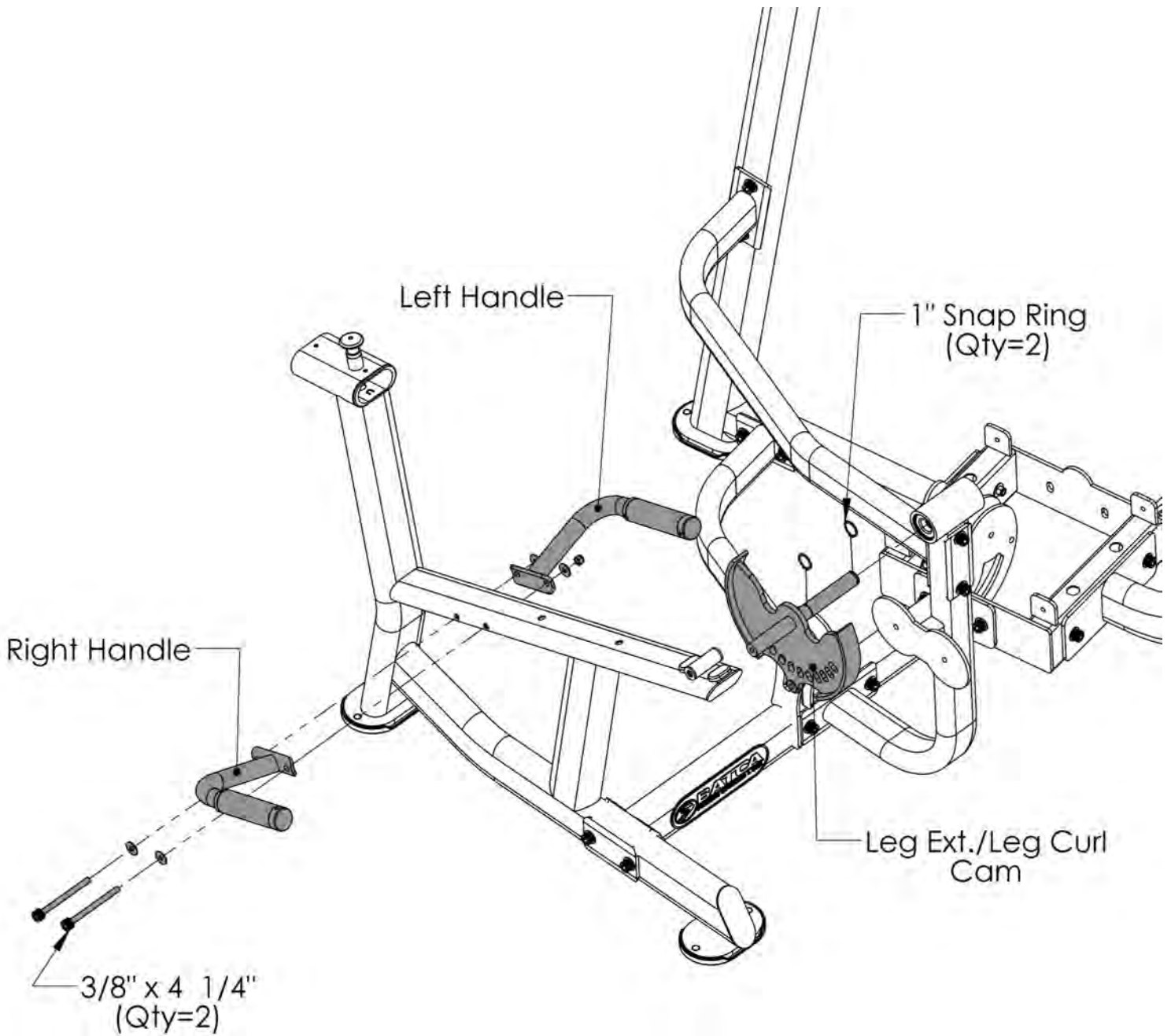

ALL FLAT WASHERS AND NYLOCKS ARE 3/8" UNLESS OTHERWISE NOTED. ANYWHERE A WASHER IS AGAINST THE ROUND SIDE OF A TUBE THERE IS TO BE A **3/8" CURVED WASHER** INSTEAD OF A **3/8" FLAT WASHER**.

ITEM #	PART #	DESCRIPTION	QTY
18	BFP-10873	LEFT HANDLE	1
19	BFP-10872	RIGHT HANDLE	1
20	BFP-10867	LEG EXT./LEG CURL CAM	1
58	BFH-50165	1" SNAP RING	2
85	BFP-51799	SHCS 3/8" x 4 1/4"	2
91	BFH-50204	3/8" CURVED WASHER	4
92	BFH-50146	3/8" NYLOCK	2

STEP 6:

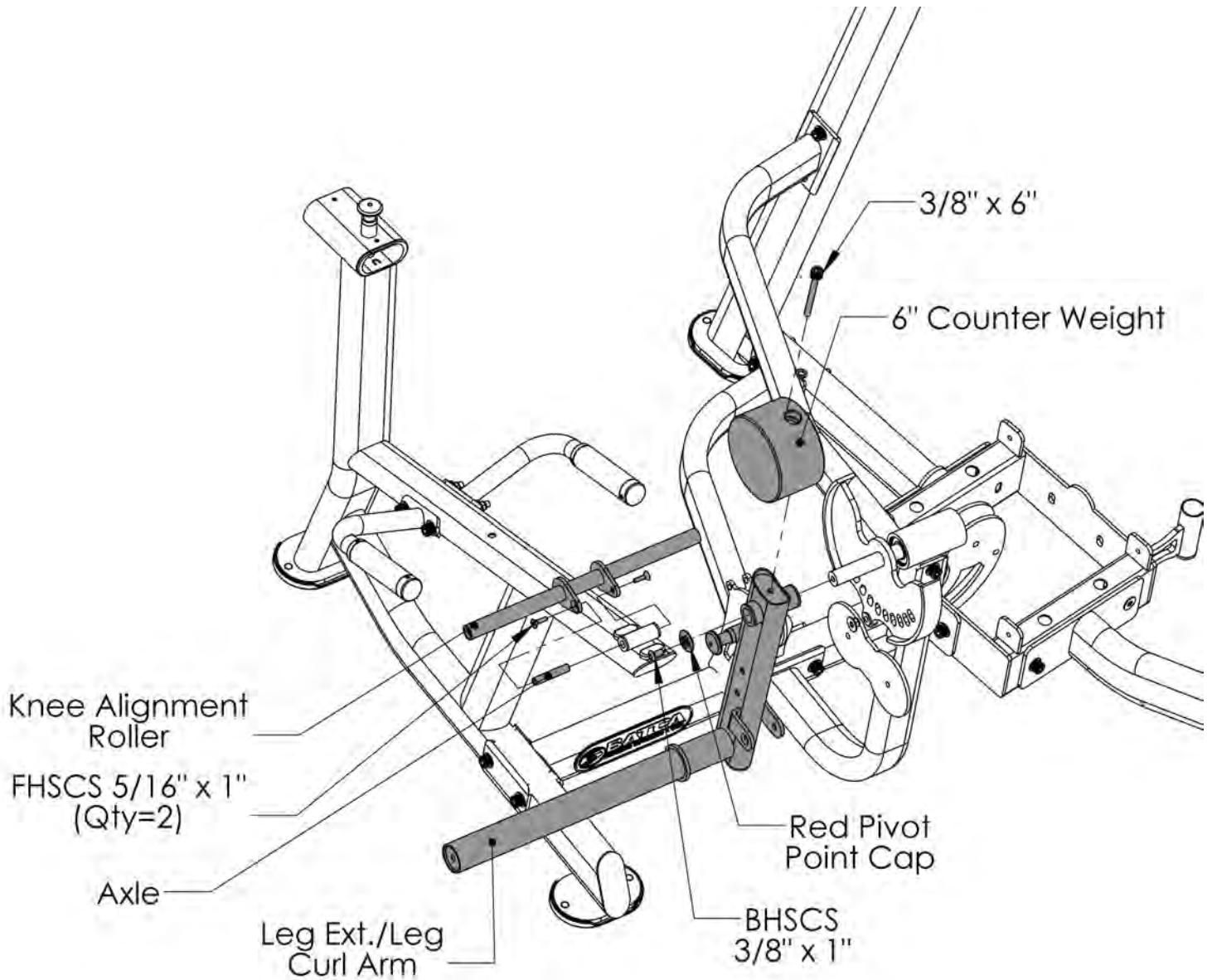

ITEM #	PART #	DESCRIPTION	QTY
21	BFP-10868	LEG EXT./LEG CURL ARM	1
22	BFP-52364	6" COUNTER WEIGHT	1
23	BFP-10871	KNEE ALIGNMENT ROLLER	1
24	BFP-52177	AXLE	1
59	BFP-51885	RED PIVOT POINT CAP	1
74	BFH-50245	FHSCS 5/16 x 1"	2
75	BFH-50620	BHSCS 3/8" x 1"	1
88	BFP-52364	SHCS 3/8" x 6"	1
92	BFH-50146	3/8" FLAT WASHER	1

ALL FLAT WASHERS AND NYLOCKS ARE 3/8"
UNLESS OTHERWISE NOTED.

STEP 7:

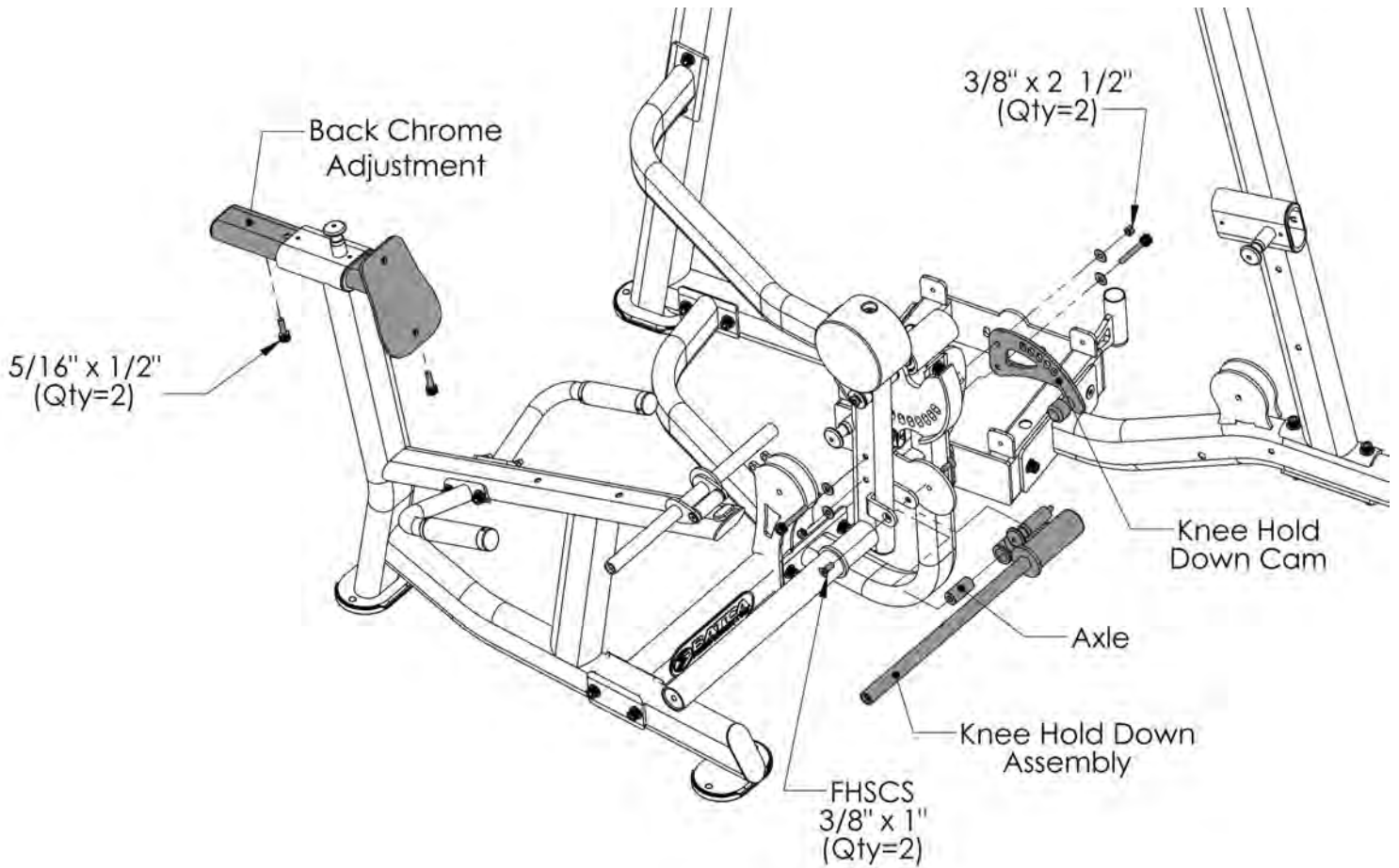

ITEM #	PART #	DESCRIPTION	QTY
25	BFP-10870	KNEE HOLD DOWN ASSEMBLY	1
26	BFP-52201	KNEE HOLD DOWN CAM	1
27	BFP-51909	AXLE	1
28	BFP-10948	BACK CHROME ADJUSTMENT	1
71	BFP-52372	SHCS 5/16" x 1/2"	2
73	BFH-50144	FHSCS 3/8" x 1"	2
81	BFP-52382	SHCS 3/8" x 2 1/2"	2
92	BFH-50146	3/8" FLAT WASHER	4
93	BFH-50157	3/8" NYLOCK	2

ALL FLAT WASHERS AND NYLOCKS ARE 3/8" UNLESS OTHERWISE NOTED.

STEP 8:

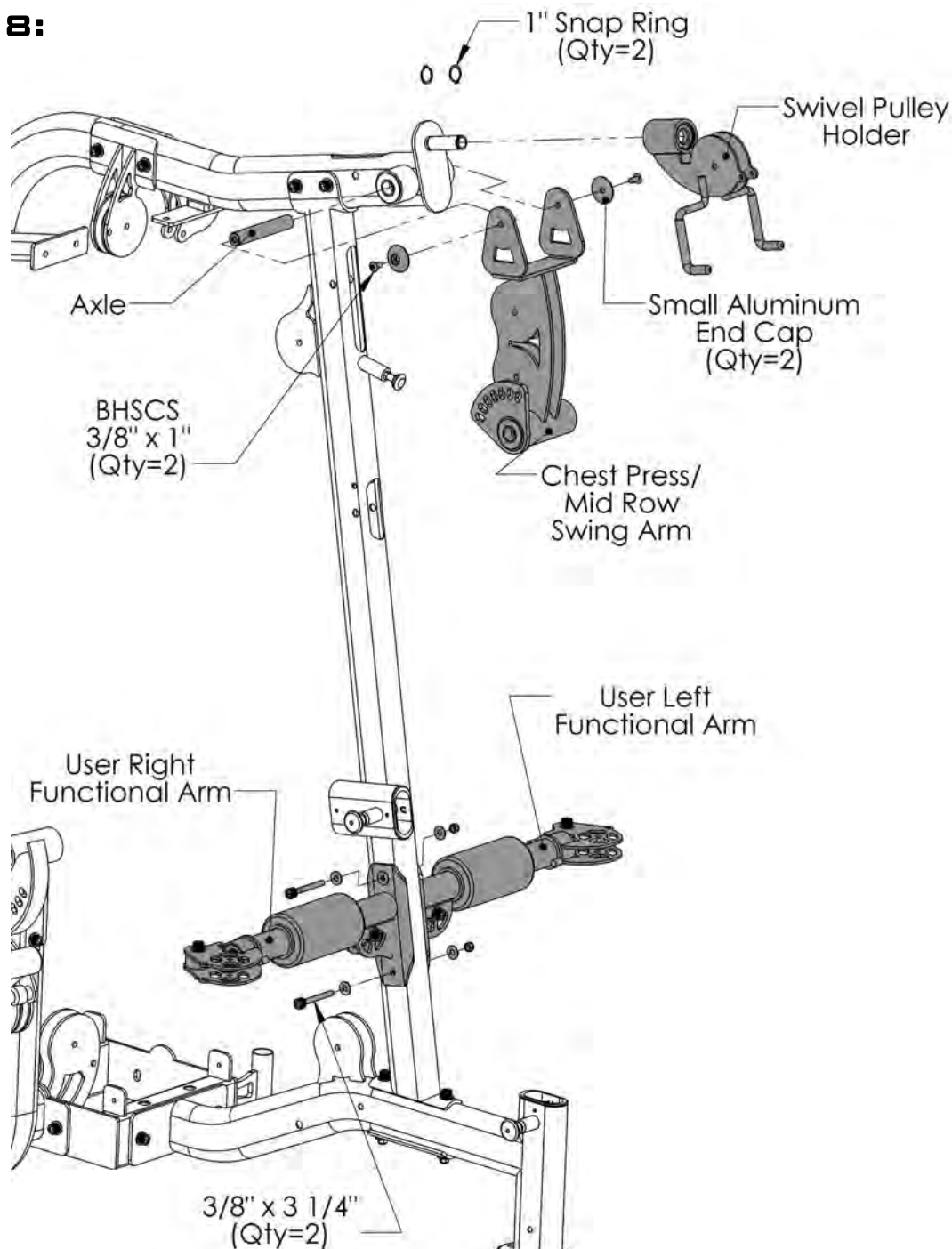

ALL FLAT WASHERS AND NYLOCKS ARE 3/8" UNLESS OTHERWISE NOTED.

ITEM #	PART #	DESCRIPTION	QTY
29	BFP-10978	CHEST PRESS/MID ROW SWING ARM	1
30	BFP-11025	USER RIGHT FUNCTIONAL ARM	1
141	BFP-11026	USER LEFT FUNCTIONAL ARM	1
31	BFP-11017	SWIVEL PULLEY HOLDER	1
32	BFP-51776	AXLE	1
60	BFP-51696	SMALL ALUMINUM END CAP	2
58	BFH-50165	1" SNAP RING	2
75	BFH-50620	BHSCS 3/8" x 1"	2
83	BFP-51748	SHCS 3/8" x 3 1/4" "	2
92	BFH-50146	3/8" FLAT WASHER	4
93	BFH-50157	3/8" NYLOCK	2

STEP 9:

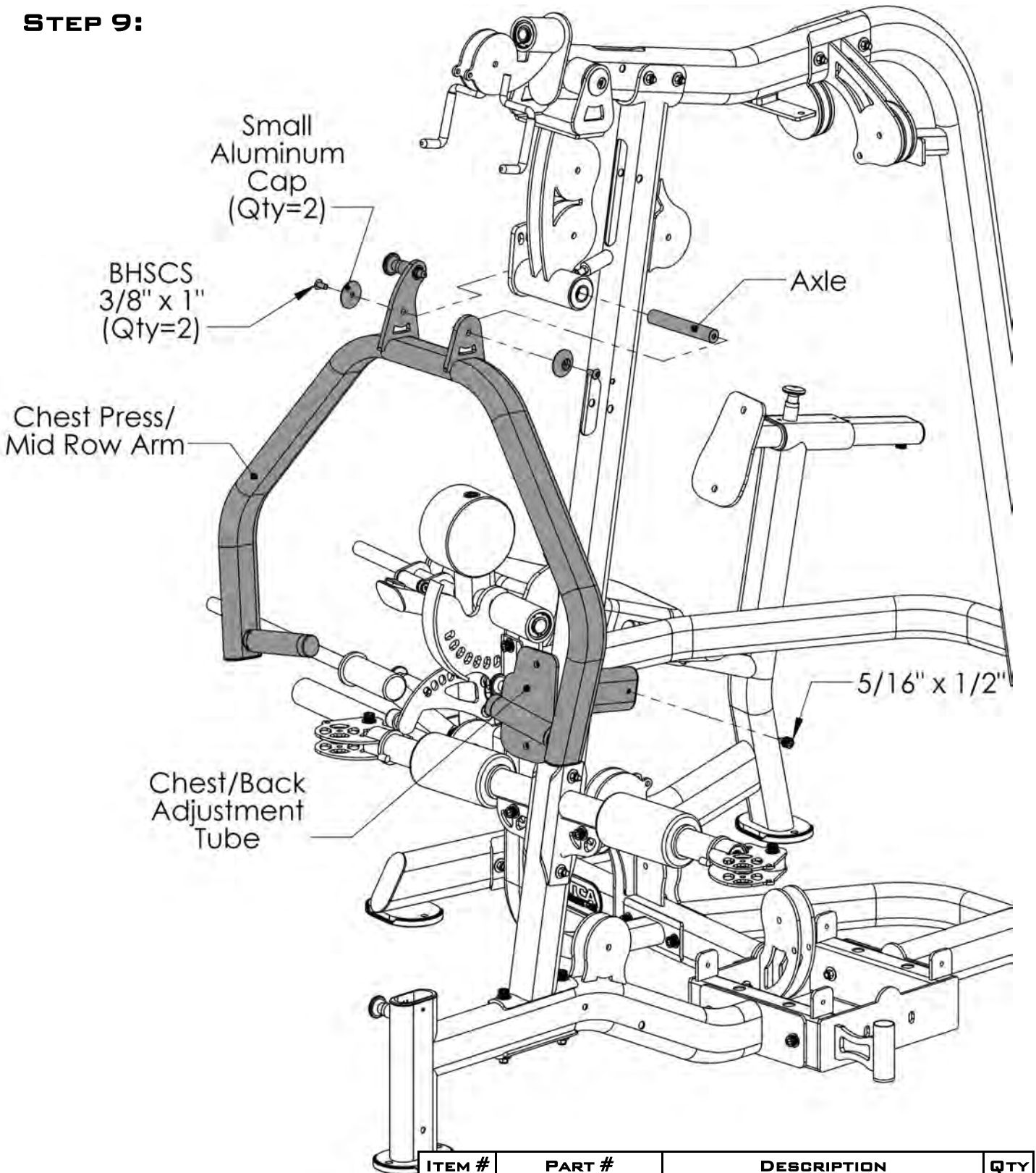

ITEM #	PART #	DESCRIPTION	QTY
34	BFP-10979	CHEST PRESS/MID ROW ARM	1
35	BFP-10980	CHEST/BACK CHROME ADJUSTMENT	1
36	BFP-52370	AXLE	1
60	BFP-51696	SMALL ALUMINUM END CAP	2
71	BFP-52372	SHCS 5/16" x 1/2"	1
75	BFH-50620	BHSCS 3/8" x 1"	2

ALL FLAT WASHERS AND NYLOCKS ARE 3/8" UNLESS OTHERWISE NOTED.

STEP 10:

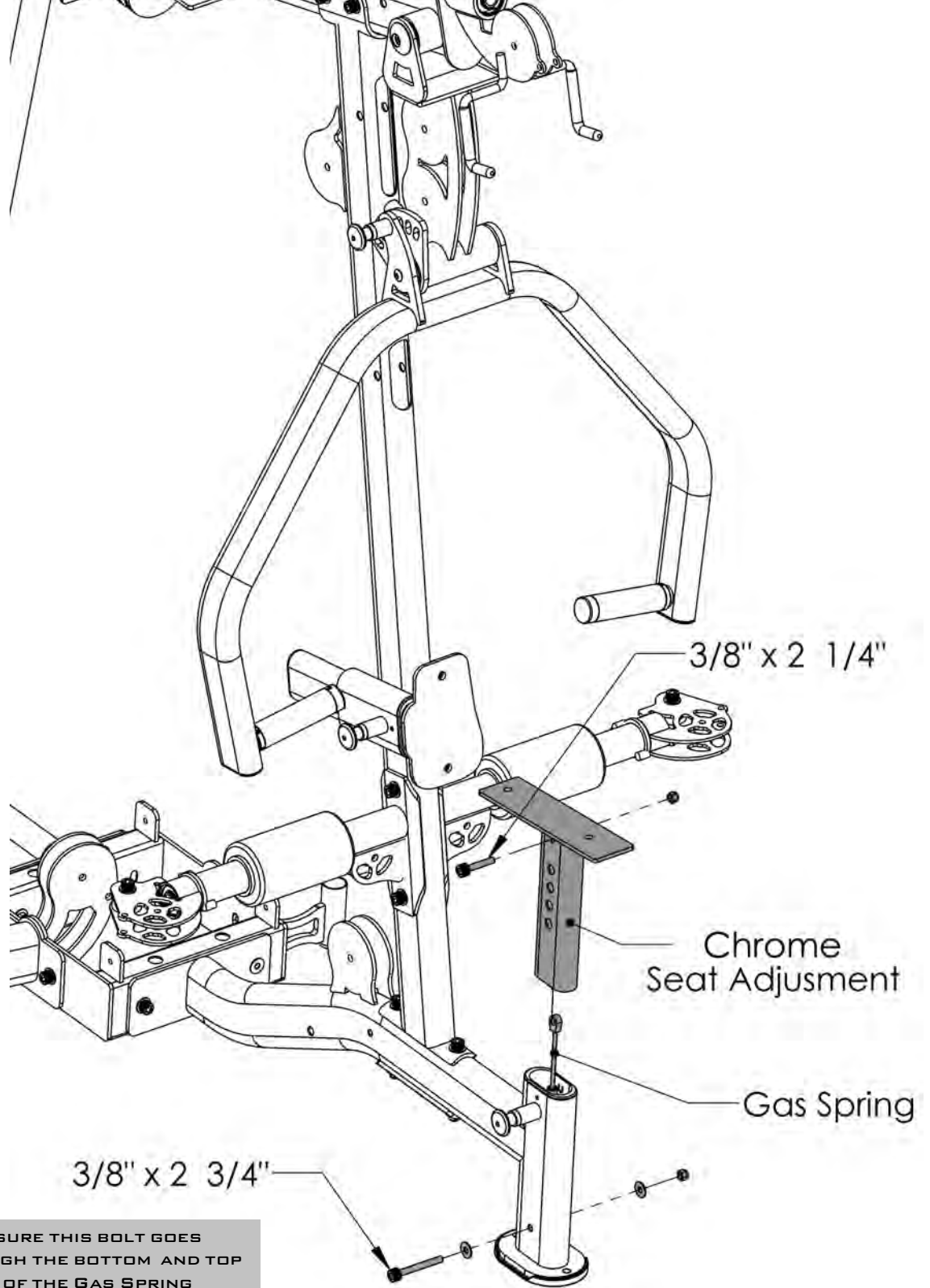

! MAKE SURE THIS BOLT GOES THROUGH THE BOTTOM AND TOP HOLES OF THE GAS SPRING

ALL FLAT WASHERS AND NYLOCKS ARE 3/8" UNLESS OTHERWISE NOTED.

ITEM #	PART #	DESCRIPTION	QTY
37	BFP-11013	CHROME SEAT ADJUSTMENT	1
61	BFH-50210	GAS SPRING	1
80	BFP-51752	SHCS 3/8" x 2 1/4"	1
82	BFP-51750	SHCS 3/8" x 2 3/4"	1
92	BFH-50146	3/8" FLAT WASHER	2
93	BFH-50157	3/8" NYLOCK	2

STEP 11:

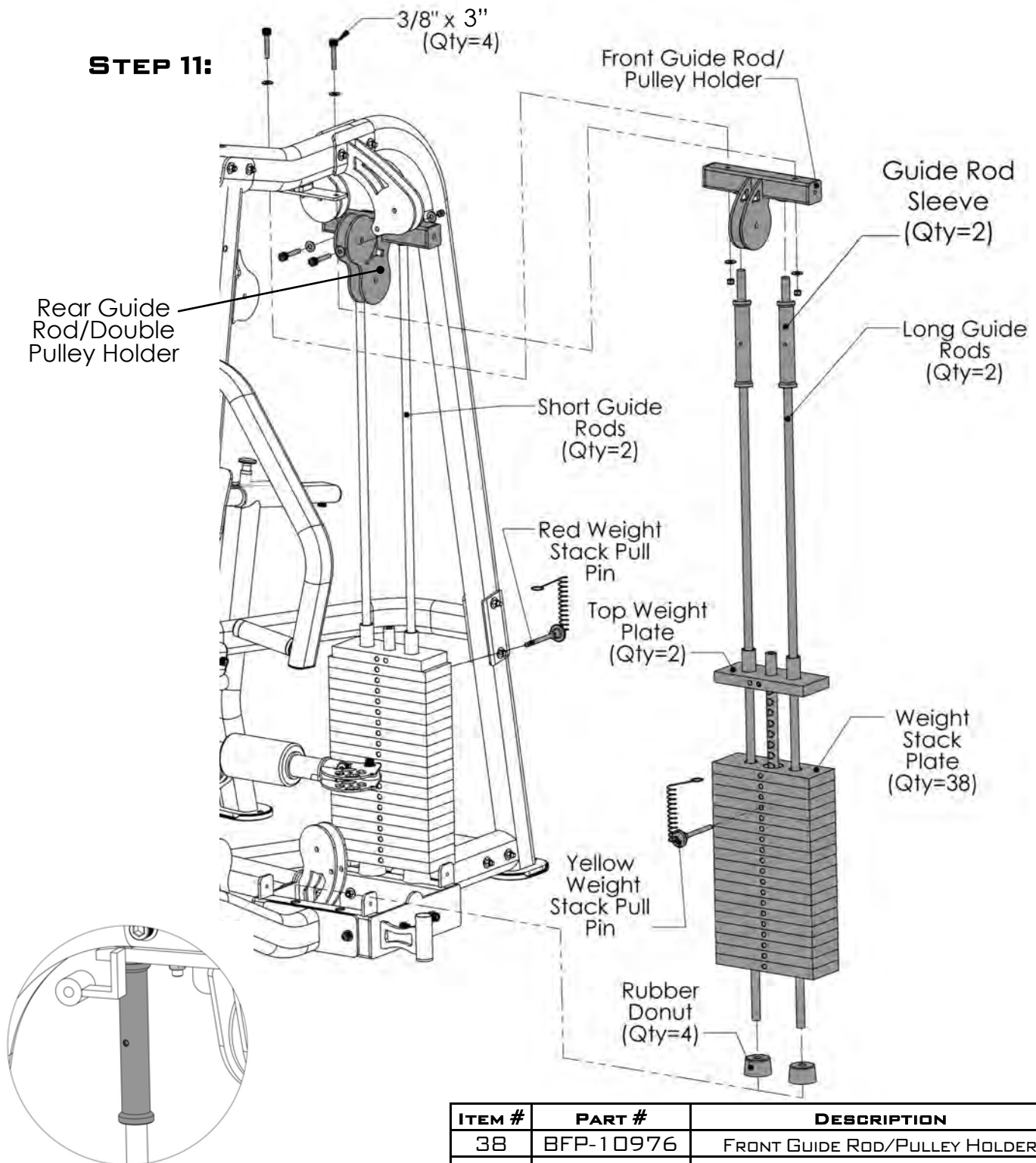

! MAKE SURE THE SCREW IN THE GUIDE ROD SLEEVES IS FACING TOWARDS THE BACK OF THE WEIGHT STACK AND THE SLEEVE IS PUSHED UP AGAINST THE RUBBER GROMMET OF THE GUIDE ROD HOLDER ONCE IT IS IN PLACE TIGHTEN THE SCREW TO KEEP IT IN PLACE.

ALL FLAT WASHERS AND NYLOCKS ARE 3/8" UNLESS OTHERWISE NOTED.

ITEM #	PART #	DESCRIPTION	QTY
38	BFP-10976	FRONT GUIDE ROD/PULLEY HOLDER	1
39	BFP-10977	REAR GUIDE ROD/DOUBLE PULLEY HOLDER	1
40	BFP-52227	LONG GUIDE ROD	2
41	BFP-52226	SHORT GUIDE ROD	2
42	BFM-10299	TOP WEIGHT PLATE	2
43	BFM-50256	WEIGHT STACK PLATE	38
44	BFP-52143	RUBBER DONUT	4
53	BFP-52383	GUIDE ROD SLEEVE	2
54	BFM-51173	RED AND YELLOW WEIGHT STACK PULL PIN	2
84	BFP-51747	SHCS 3/8" X 3"	4
92	BFH-50146	3/8" FLAT WASHER	8
93	BFH-50157	3/8" NYLOCK	4

STEP 12:

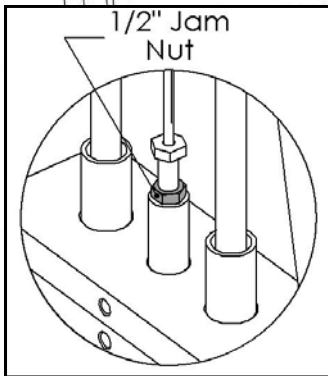
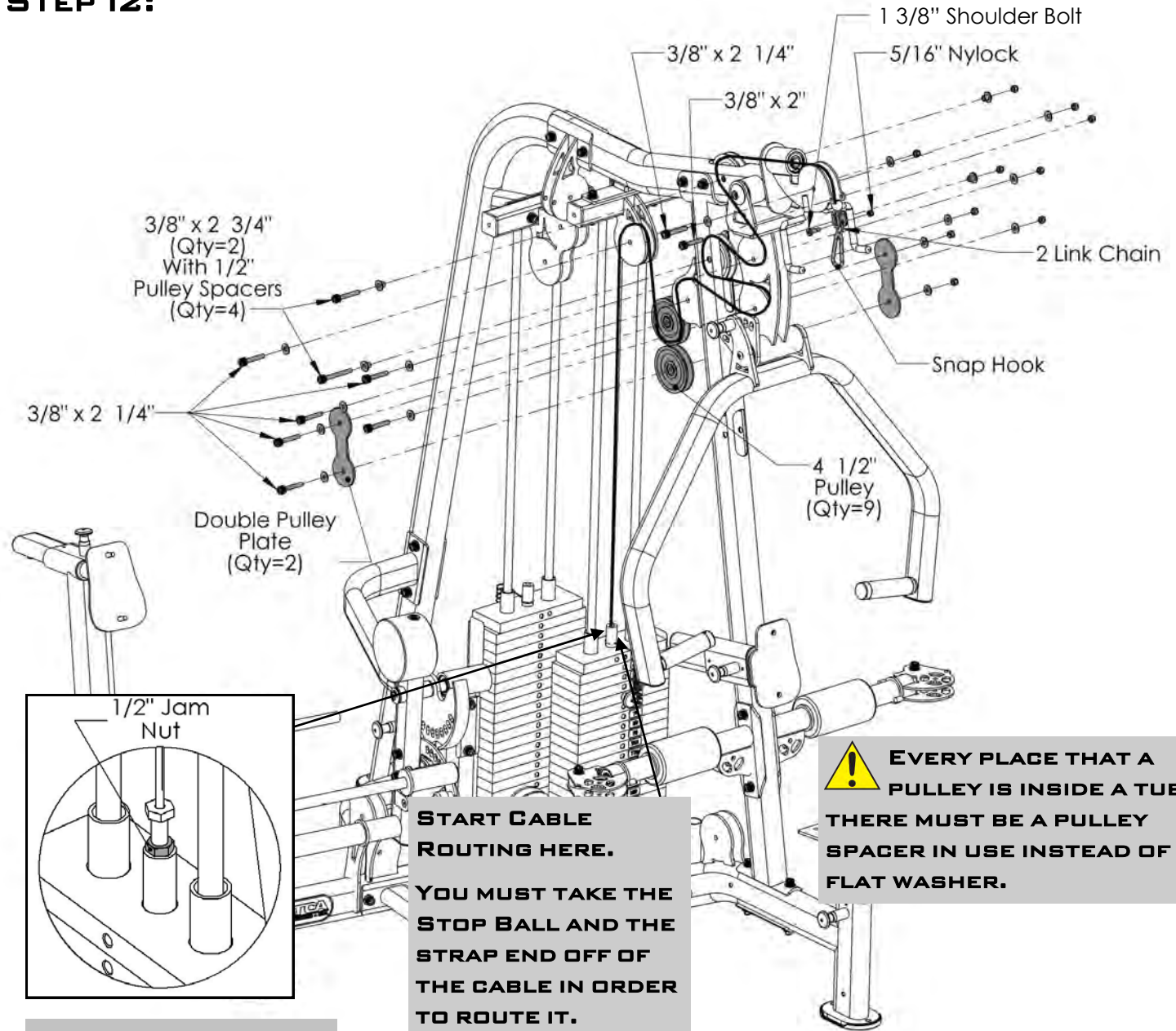

START CABLE ROUTING HERE. YOU MUST TAKE THE STOP BALL AND THE STRAP END OFF OF THE CABLE IN ORDER TO ROUTE IT.

EVERY PLACE THAT A PULLEY IS INSIDE A TUBE THERE MUST BE A PULLEY SPACER IN USE INSTEAD OF A FLAT WASHER.

NOTE: THE THREADED BOLT ON THE END OF THE CABLE **MUST BE THREADED AT LEAST 1/2"** THE TOP PLATE OF THE WEIGHT STACK. THE BOLT MUST ALSO BE SECURED WITH A 1/2" JAM NUT TO ENSURE A SAFE AND PROPER CONNECTION.

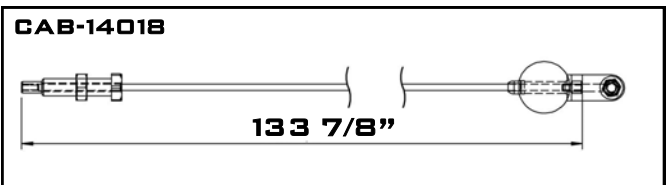

ITEM #	PART #	DESCRIPTION	QTY
99	CAB-14018	WEIGHT STACK TO SWIVEL PULLEY	1
45	BFP-52165	DOUBLE PULLEY PLATE	2
62	2xBFC-50128	2 LINK CHAIN	1
65	BFH-50188	SNAP HOOK	1
69	BFH-50174	4 1/2" PULLEY	9
67	BFP51746-	1/2" PULLEY SPACERS	4
77	BFH-50351	1 3/8" SHOULDER BOLT	1
79	BFP-51759	SHCS 3/8" x 2"	3
80	BFP-51752	SHCS 3/8" x 2 1/4"	5
82	BFP-51750	SHCS 3/8" x 2 3/4"	2
89	BFH-50267	5/16" NYLOCK	1
92	BFH-50146	3/8" FLAT WASHER	14
93	BFH-50157	3/8" NYLOCK	10

ALL FLAT WASHERS AND NYLOCKS ARE 3/8" UNLESS OTHERWISE NOTED.

STEP 13:

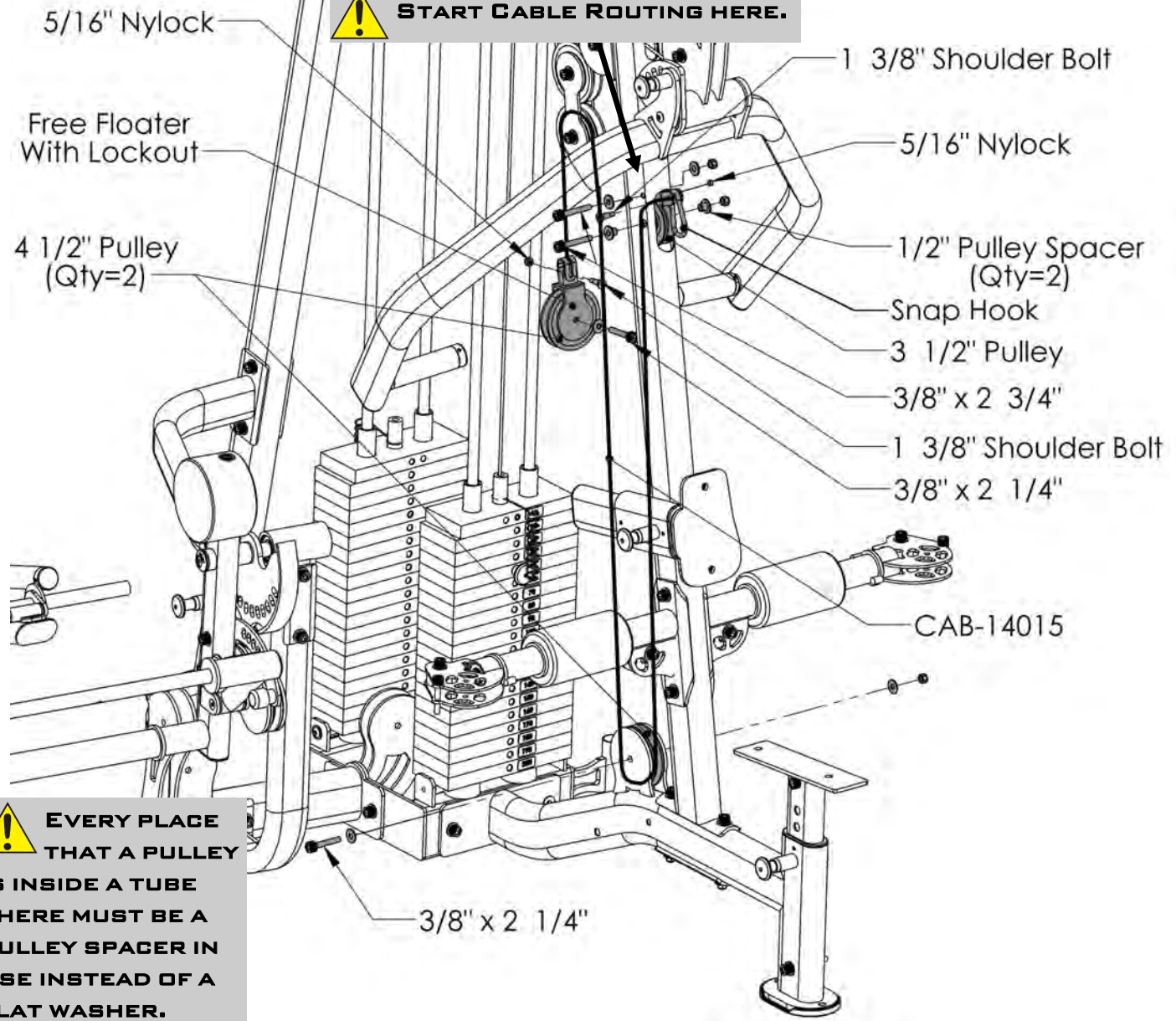

! START CABLE ROUTING HERE.

! EVERY PLACE THAT A PULLEY IS INSIDE A TUBE THERE MUST BE A PULLEY SPACER IN USE INSTEAD OF A FLAT WASHER.

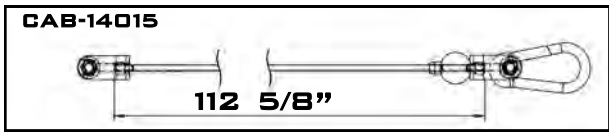

ITEM #	PART #	DESCRIPTION	QTY
100	CAB-14015	FREE FLOATER TO MID PULLEY	1
65	BFH-50188	SNAP HOOK	1
67	BFP-51746	1/2" PULLEY SPACER	2
68	BFH-50173	3 1/2" PULLEY	1
69	BFH-50174	4 1/2" PULLEY	2
70	BFP-11037	FREE FLOATER WITH LOCKOUT	1
77	BFH-50351	1 3/8" SHOULDER BOLT	2
80	BFP-51752	SHCS 3/8" x 2 1/4"	2
82	BFP-51750	SHCS 3/8" x 2 3/4"	2
89	BFH-50267	5/16" NYLOCK	2
92	BFH-50146	3/8" FLAT WASHER	4
93	BFH-50157	3/8" NYLOCK	3

ALL FLAT WASHERS AND NYLOCKS ARE 3/8" UNLESS OTHERWISE NOTED. ANYWHERE A WASHER IS AGAINST THE ROUND SIDE OF A TUBE THERE IS TO BE A **3/8" CURVED WASHER** INSTEAD OF A **3/8" FLAT WASHER**.

STEP 14:

START CABLE ROUTING HERE.

YOU MUST TAKE THE STOP BALL AND THE STRAP END OFF OF ONE END OF THE CABLE IN ORDER TO ROUTE IT.

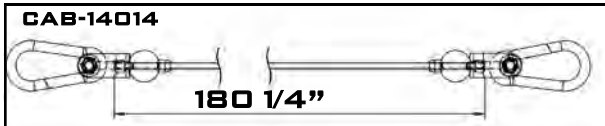
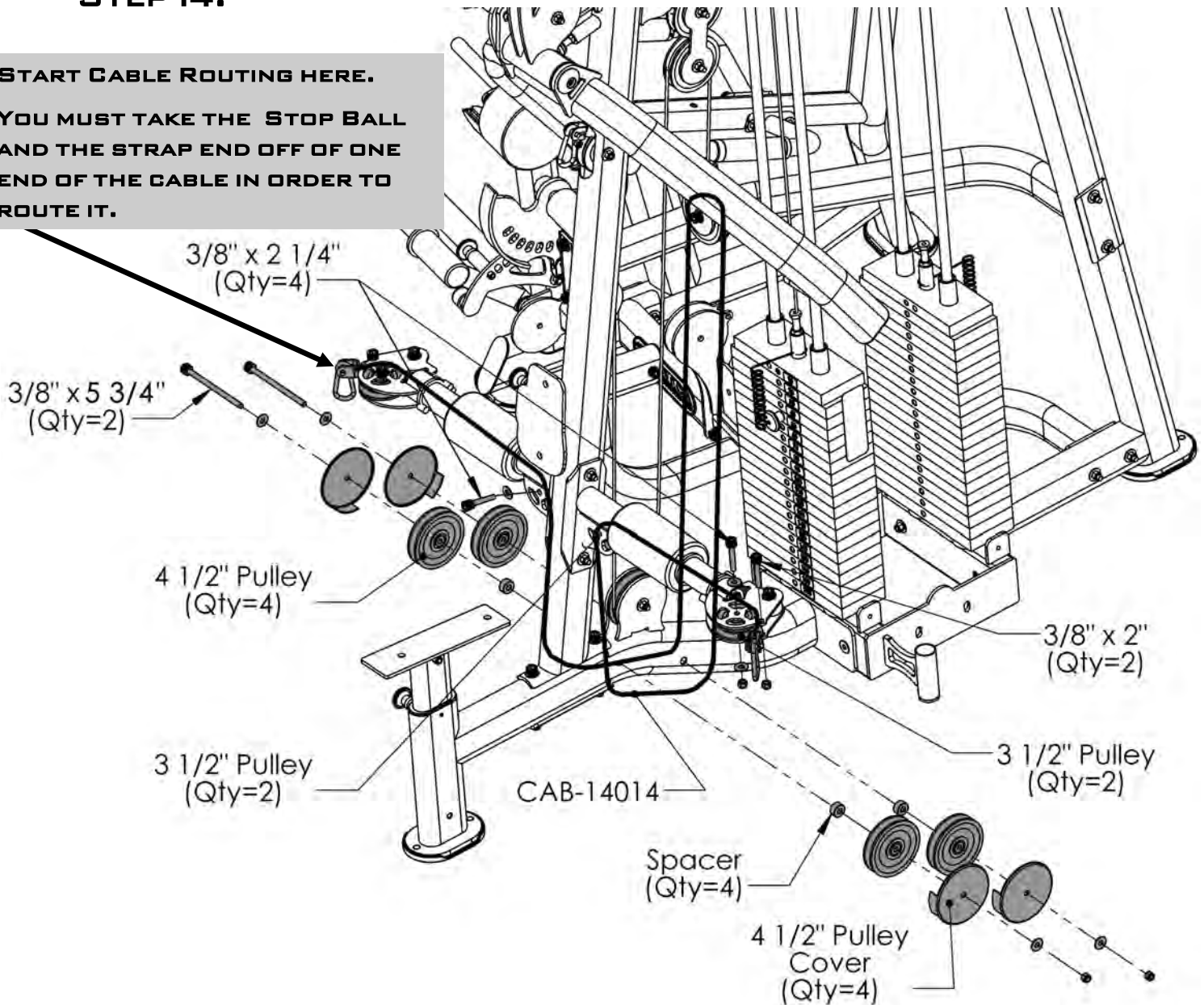

ALL FLAT WASHERS AND NYLOCKS ARE 3/8" UNLESS OTHERWISE NOTED. ANYWHERE A WASHER IS AGAINST THE ROUND SIDE OF A TUBE THERE IS TO BE A **3/8" CURVED WASHER** INSTEAD OF A **3/8" FLAT WASHER**.

ITEM #	PART #	DESCRIPTION	QTY
144	CAB-14014	FUNCTIONAL ARM TO FUNCTIONAL ARM	1
142	BFM-50345	4 1/2" PULLEY COVER	4
143	BFP-52412	SPACER	4
68	BFH-50173	3 1/2" PULLEY	4
69	BFH-50174	4 1/2" PULLEY	4
79	BFP-51759	3/8" x 2"	2
80	BFP-51752	3/8" x 2 1/4"	4
145	BFH-52520	SCHS 3/8" x 5 3/4"	2
92	BFH-50146	3/8" FLAT WASHER	12
93	BFH-50157	3/8" NYLOCK	8

STEP 15:



SKIP THIS STEP IF LEG PRESS WAS PURCHASED.

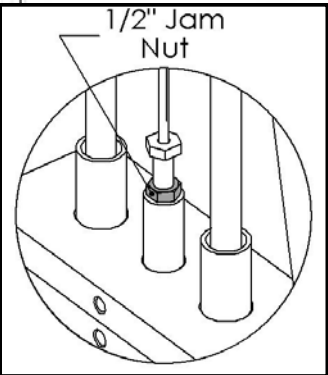
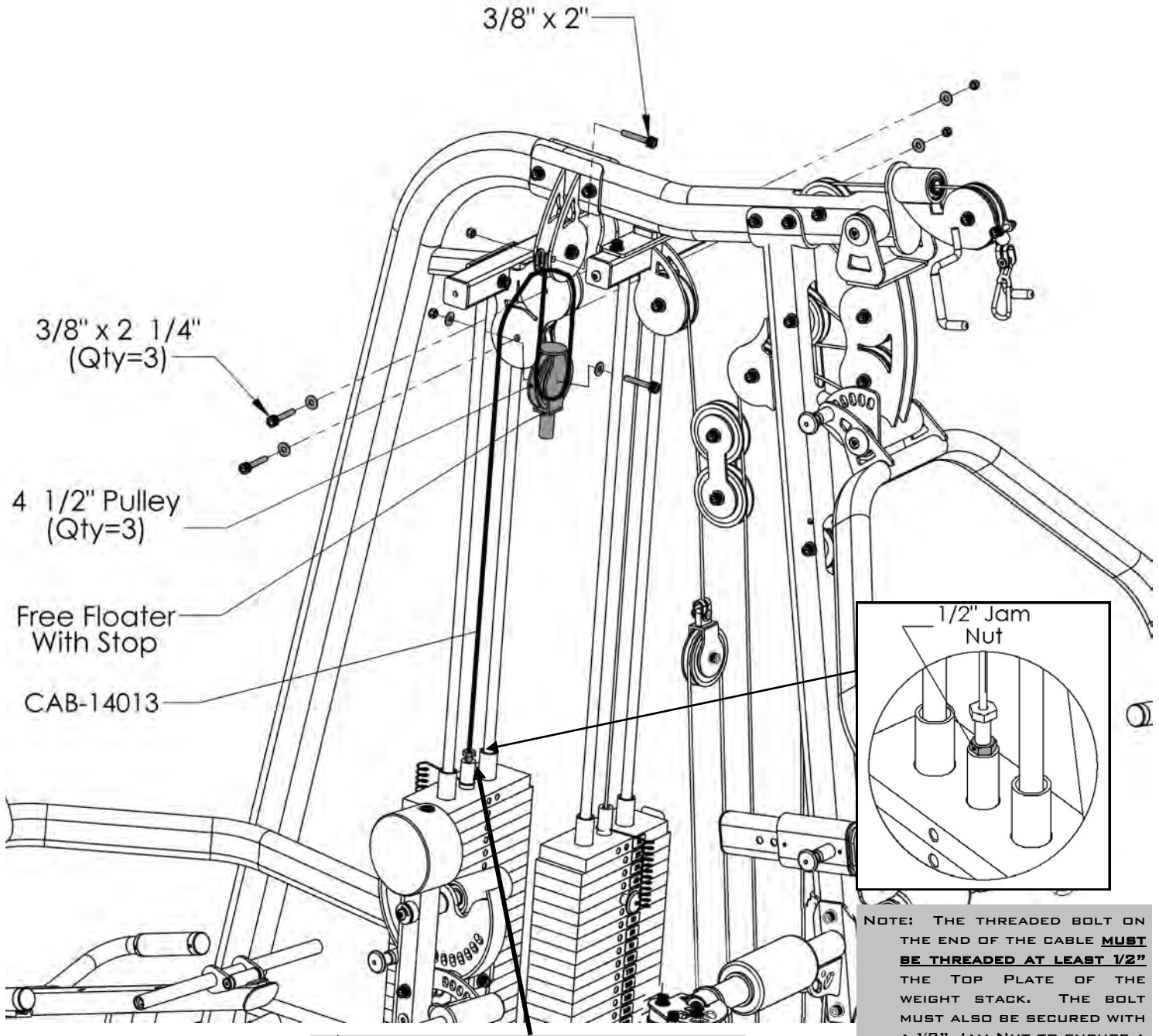

NOTE: THE THREADED BOLT ON THE END OF THE CABLE **MUST BE THREADED AT LEAST 1/2"** THE TOP PLATE OF THE WEIGHT STACK. THE BOLT MUST ALSO BE SECURED WITH A 1/2" JAM NUT TO ENSURE A SAFE AND PROPER CONNECTION.

START CABLE ROUTING HERE.

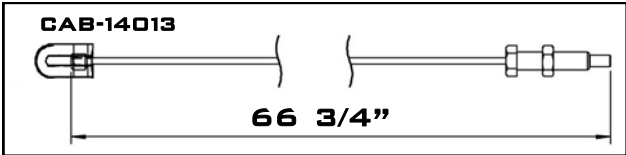

ITEM #	PART #	DESCRIPTION	QTY
101	CAB-14013	WEIGHT STACK TO LOCKOUT	1
46	BFP-11022	FREE FLOATER WITH STOP	1
69	BFH-50174	4 1/2" PULLEY	3
79	BFP-51759	SHCS 3/8" x 2"	1
80	BFP-51752	SHCS 3/8" x 2 1/4"	3
92	BFH-50146	3/8" FLAT WASHER	6
93	BFH-50157	3/8" NYLOCK	4

ALL FLAT WASHERS AND NYLOCKS ARE 3/8" UNLESS OTHERWISE NOTED.

STEP 15A:



SKIP THIS STEP IF LEG PRESS WAS NOT PURCHASED.

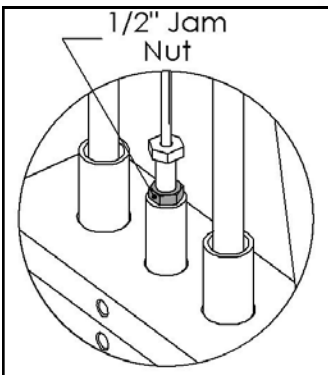
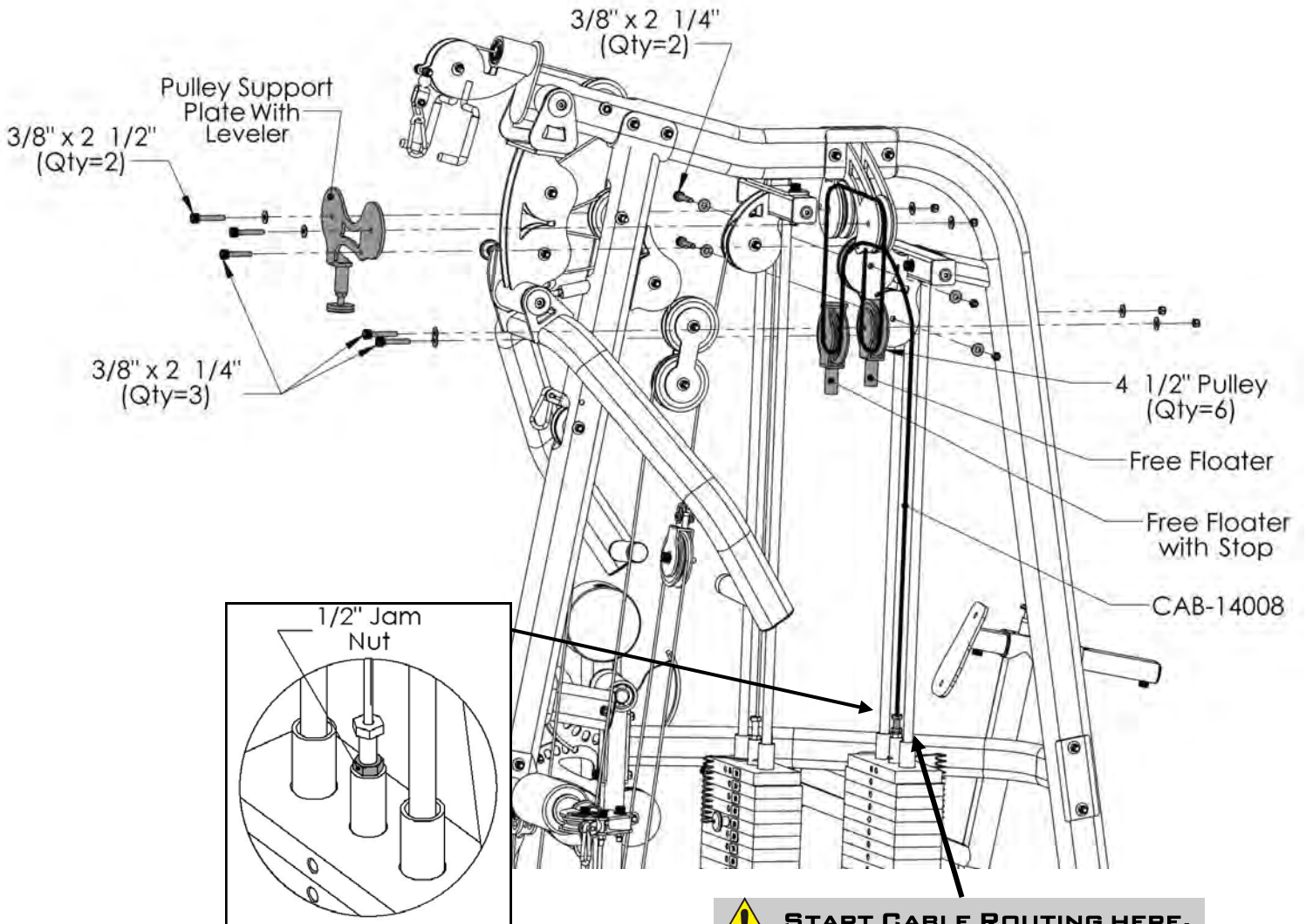

NOTE: THE THREADED BOLT ON THE END OF THE CABLE **MUST BE THREADED AT LEAST 1/2"** THE TOP PLATE OF THE WEIGHT STACK. THE BOLT MUST ALSO BE SECURED WITH A 1/2" JAM NUT TO ENSURE A SAFE AND PROPER CONNECTION.



START CABLE ROUTING HERE.

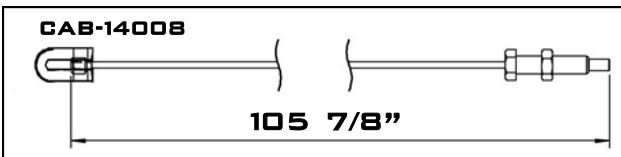

ITEM #	PART #	DESCRIPTION	QTY
139	CAB-14008	WEIGHT STACK TO LEG PRESS FREE FLOATER	1
46	BFP-10838	FREE FLOATER	1
145	BFP-11022	FREE FLOATER WITH STOP	1
106	BFP-11021	PULLEY SUPPORT PLATE WITH LEVELER	1
120	BFH-50174	4 1/2" PULLEY	6
80	BFP-51752	SHCS 3/8" 2 1/4"	5
129	BFP-52382	SHCS 3/8" x 2 1/2"	2
92	BFH-50146	3/8" FLAT WASHER	12
93	BFH-50157	3/8" NYLOCK	7

ALL FLAT WASHERS AND NYLOCKS ARE 3/8" UNLESS OTHERWISE NOTED.

STEP 16:

! START CABLE ROUTING HERE.

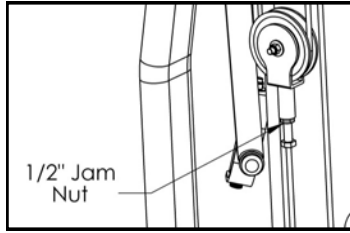

NOTE: THE THREADED BOLT ON THE END OF THE CABLE **MUST BE THREADED AT LEAST 1/2"** THE FREE FLOATER. THE BOLT MUST ALSO BE SECURED WITH A 1/2" JAM NUT TO ENSURE A SAFE AND PROPER CONNECTION.

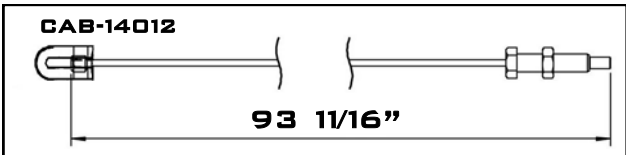
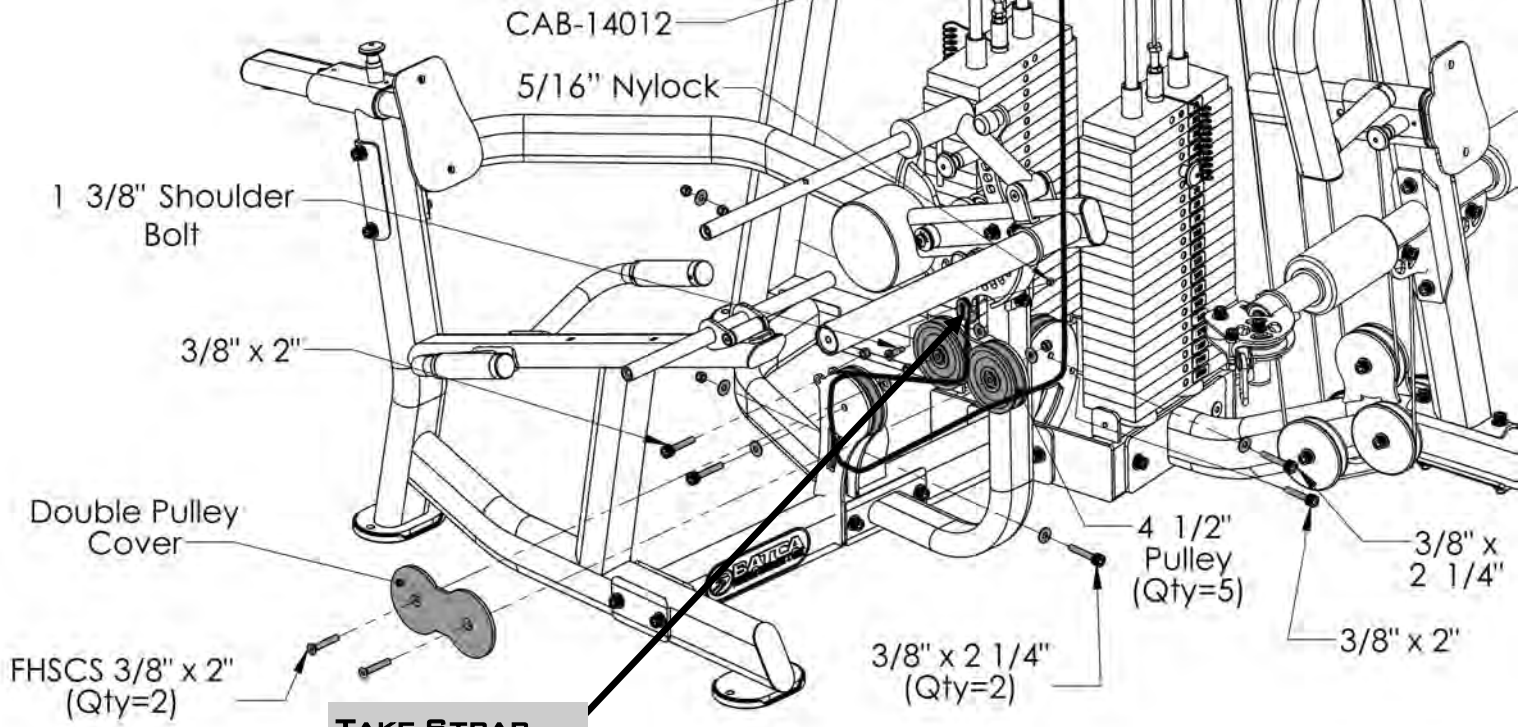

ALL FLAT WASHERS AND NYLOCKS ARE 3/8" UNLESS OTHERWISE NOTED.

ITEM #	PART #	DESCRIPTION	QTY
102	CAB-14012	FREE FLOATER LEG EXTENSION CAM	1
47	BFP-51883	DOUBLE PULLEY COVER	1
69	BFH-50174	4 1/2" PULLEY	5
77	BFH-50351	1 3/8" SHOULDER BOLT	1
78	BFP-52377	FHSCS 3/8" x 2"	2
79	BFP-51759	SHCS 3/8" x 2"	2
80	BFP-51752	SHCS 3/8" x 2 1/4"	3
89	BFH-50267	5/16" NYLOCK	1
92	BFH-50146	3/8" FLAT WASHER	8
93	BFH-50157	3/8" NYLOCK	7

STEP 17:

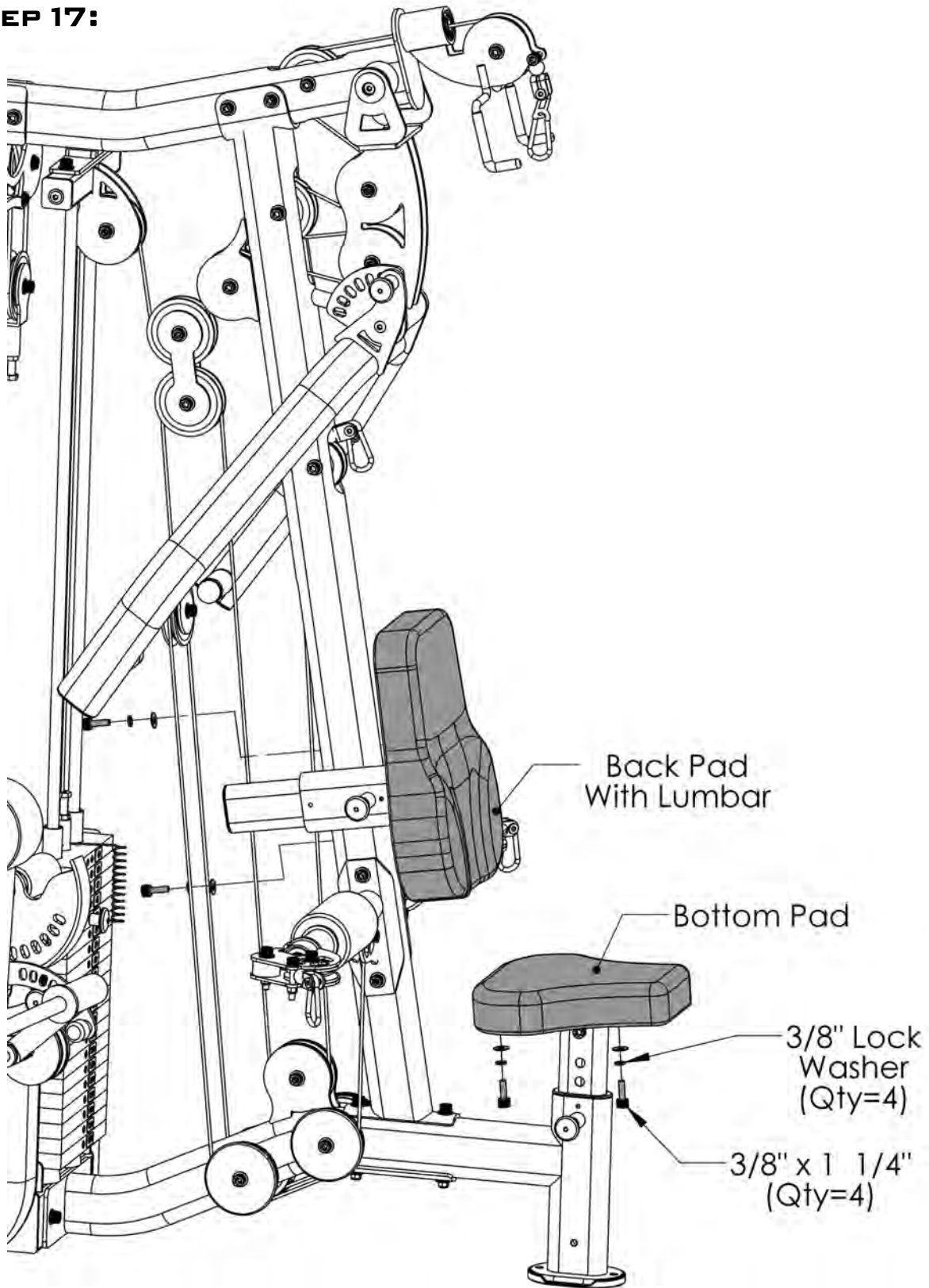

ALL FLAT WASHERS AND NYLOCKS ARE 3/8" UNLESS OTHERWISE NOTED.

ITEM #	PART #	DESCRIPTION	QTY
94	BFP-52136	BACK PAD WITH LUMBAR	1
95	BFP-52141	BOTTOM PAD	1
76	BFP-51653	SHCS 3/8" x 1 1/4"	4
90	BFH-50147	3/8" LOCK WASHER	4
92	BFH-50146	3/8" FLAT WASHER	4

STEP 18:

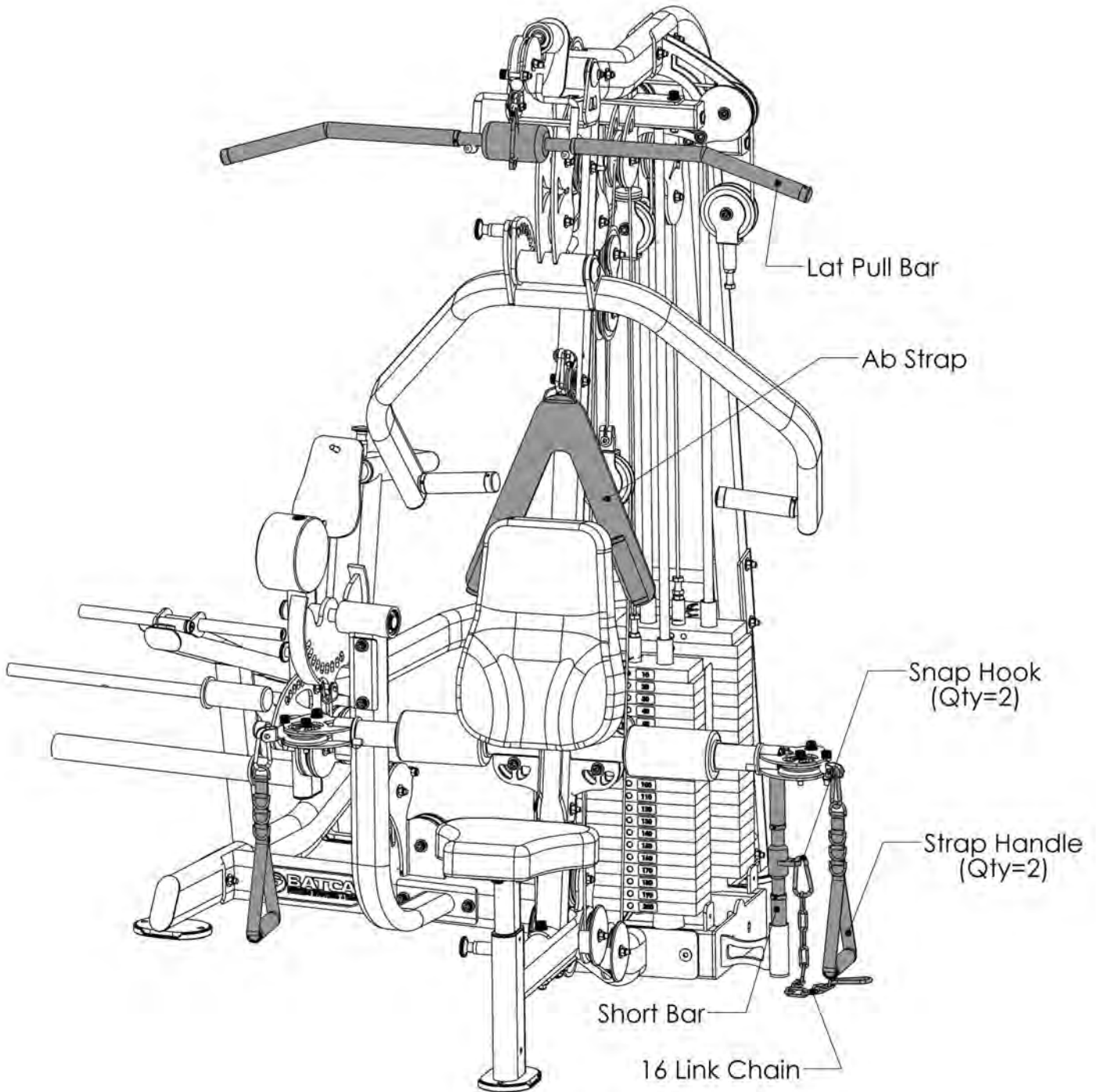

ITEM #	PART #	DESCRIPTION	QTY
146	BFC-10103	STRAP HANDLE	2
55	BFC-50122	AB STRAP	1
56	BFC-50125	LAT PULL BAR	1
57	BFC-50126	SHORT BAR	1
63	16xBFC-50128	16 LINK CHAIN	1

ALL FLAT WASHERS AND NYLOCKS
ARE 3/8" UNLESS OTHERWISE NOTED.

STEP 19:

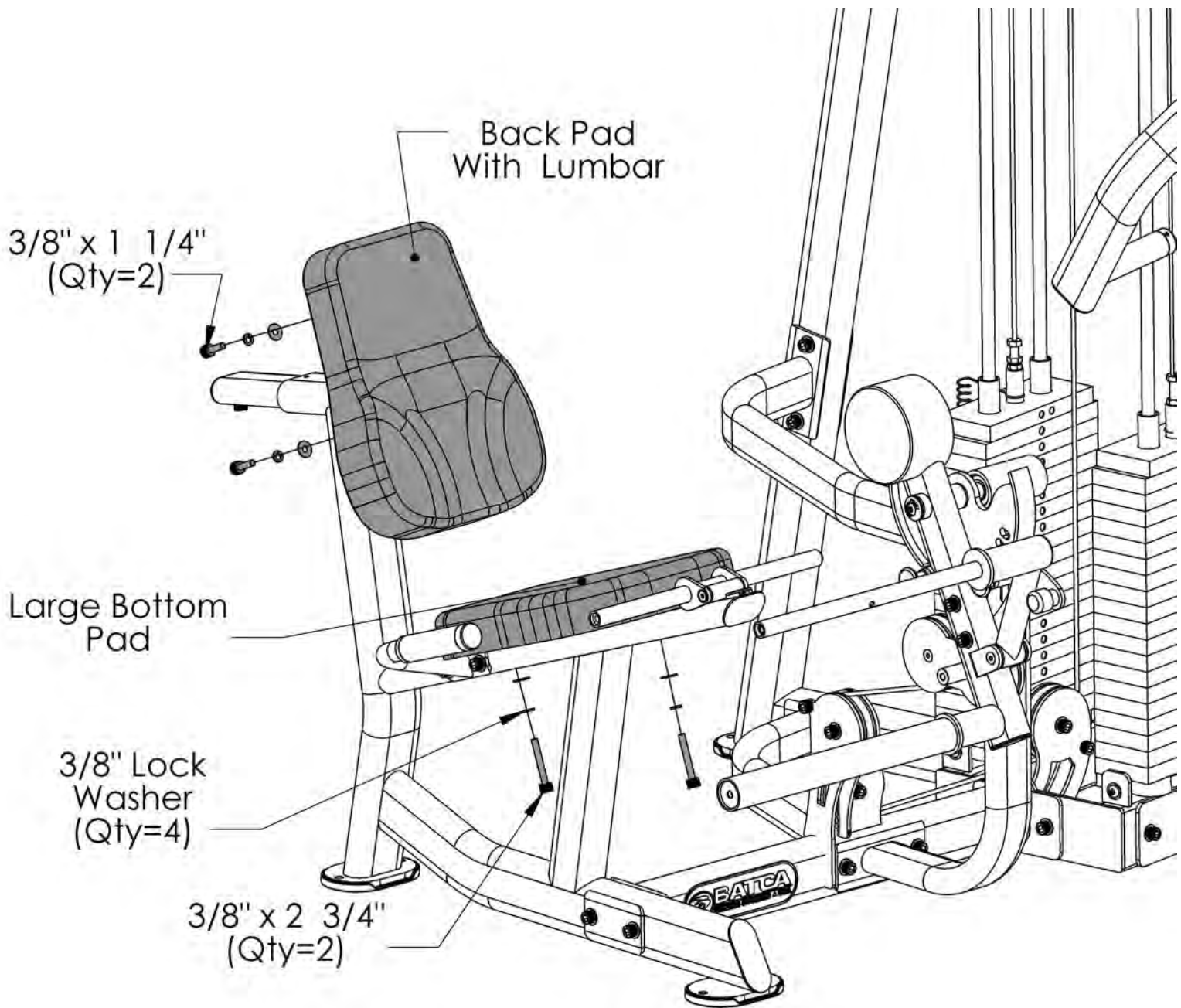

ITEM #	PART #	DESCRIPTION	QTY
94	BFP-52136	BACK PAD WITH LUMBAR	1
97	BFP-52130	LARGE BOTTOM PAD	1
76	BFP-51653	SHCS 3/8" x 1 1/4"	2
82	BFP-51750	SHCS 3/8" x 2 3/4"	2
90	BFH-50147	3/8" LOCK WASHER	4
92	BFH-50146	3/8" FLAT WASHER	4

ALL FLAT WASHERS AND NYLOCKS ARE 3/8" UNLESS OTHERWISE NOTED.

STEP 20:

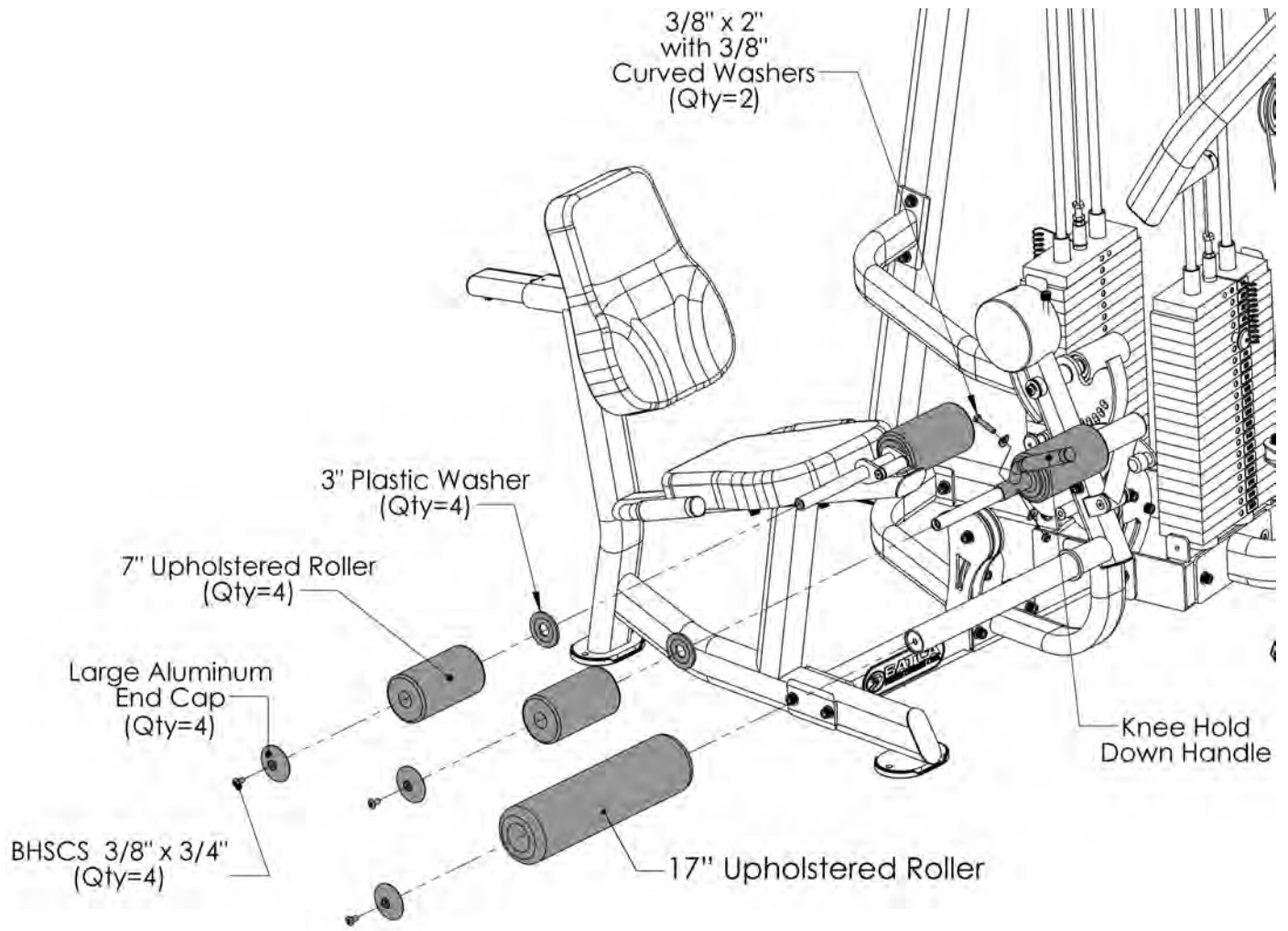

ITEM #	PART #	DESCRIPTION	QTY
96	BFU-10121	7" UPHOLSTERED ROLLER	4
98	BFU-10122	17" UPHOLSTERED ROLLER	1
48	BFM-10588	KNEE HOLD DOWN HANDLE	1
64	BFH-50622	LARGE ALUMINUM END CAP	4
66	BFH-50221	3" PLASTIC WASHER	4
72	BFP-52430	BHSCS 3/8" x 3/4"	4
79	BFP-51759	SHCS 3/8" x 2"	1
91	BFH-50204	3/8" CURVED WASHER	2
93	BFH-50157	3/8" NYLOCK	1

ALL FLAT WASHERS AND NYLOCKS ARE 3/8" UNLESS OTHERWISE NOTED.

STEP 21:

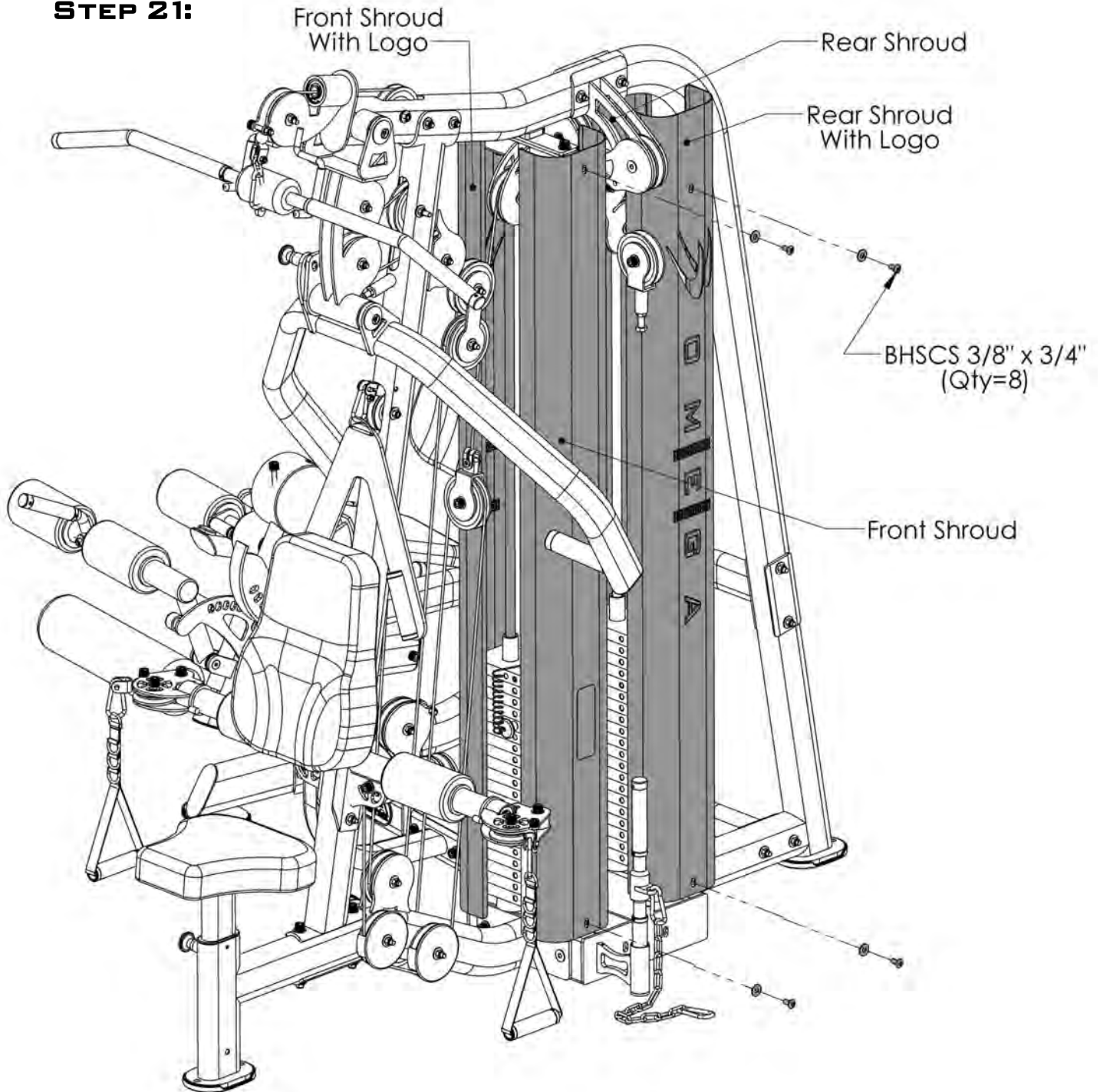

ALL FLAT WASHERS AND NYLOCKS ARE 3/8"
UNLESS OTHERWISE NOTED.

ITEM #	PART #	DESCRIPTION	QTY
49	BFP-52267	FRONT SHROUD WITH LOGO	1
50	BFP-52269	REAR SHROUD WITH LOGO	1
51	BFP-52268	FRONT SHROUD	1
52	BFP-52271	REAR SHROUD	1
72	BFP-52430	BHSCS 3/8" x 3/4"	8
92	BFH-50146	3/8" FLAT WASHER	8

LEG PRESS OPTION

STEP 22: THIS SECTION IS ONLY FOR THOSE WHO PURCHASED THE LEG PRESS OPTION.

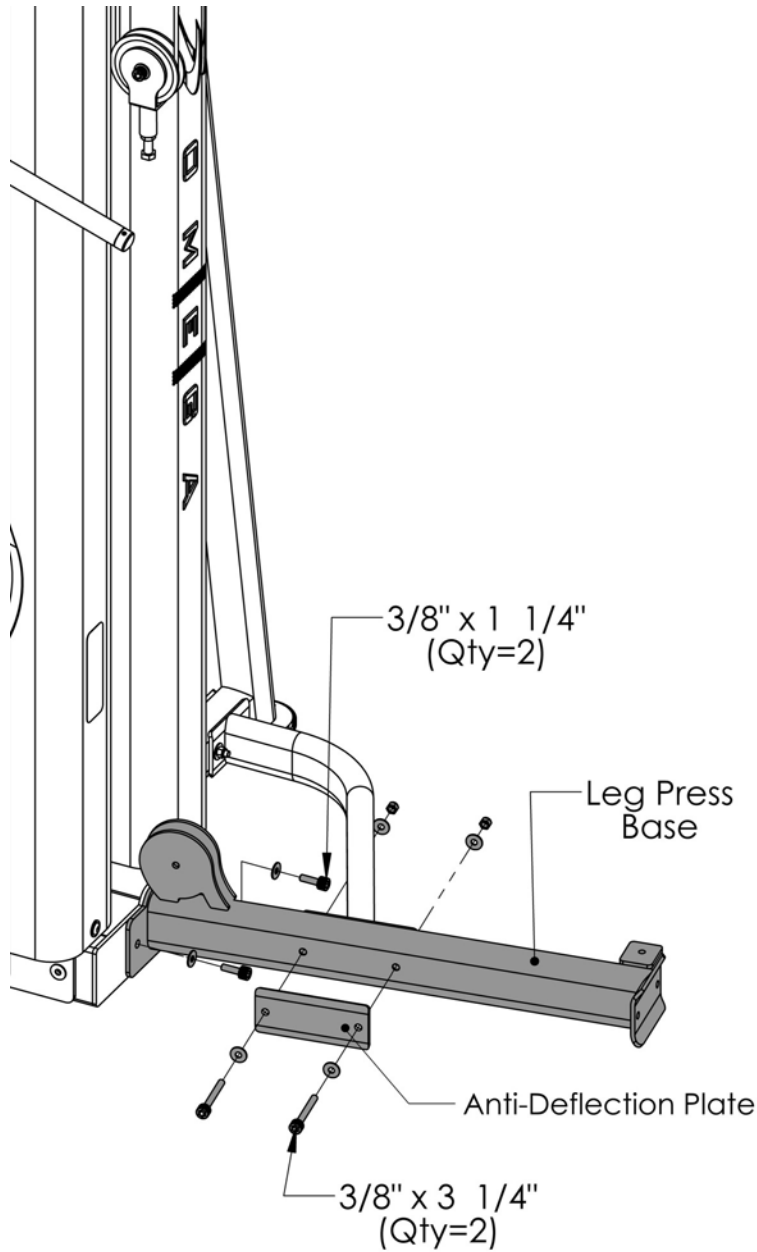

ALL FLAT WASHERS AND NYLOCKS ARE 3/8" UNLESS OTHERWISE NOTED.

ITEM #	PART #	DESCRIPTION	QTY
107	BFP-10981	LEG PRESS BASE	1
108	BFP-52164	ANTI-DEFLECTION PLATE	1
125	BFP-51653	SHCS 3/8" x 1 1/4"	2
132	BFP-51748	SHCS 3/8" x 3 1/4"	2
136	BFH-50146	3/8" FLAT WASHER	8
137	BFH-50157	3/8" NYLOCK	4

STEP 23:

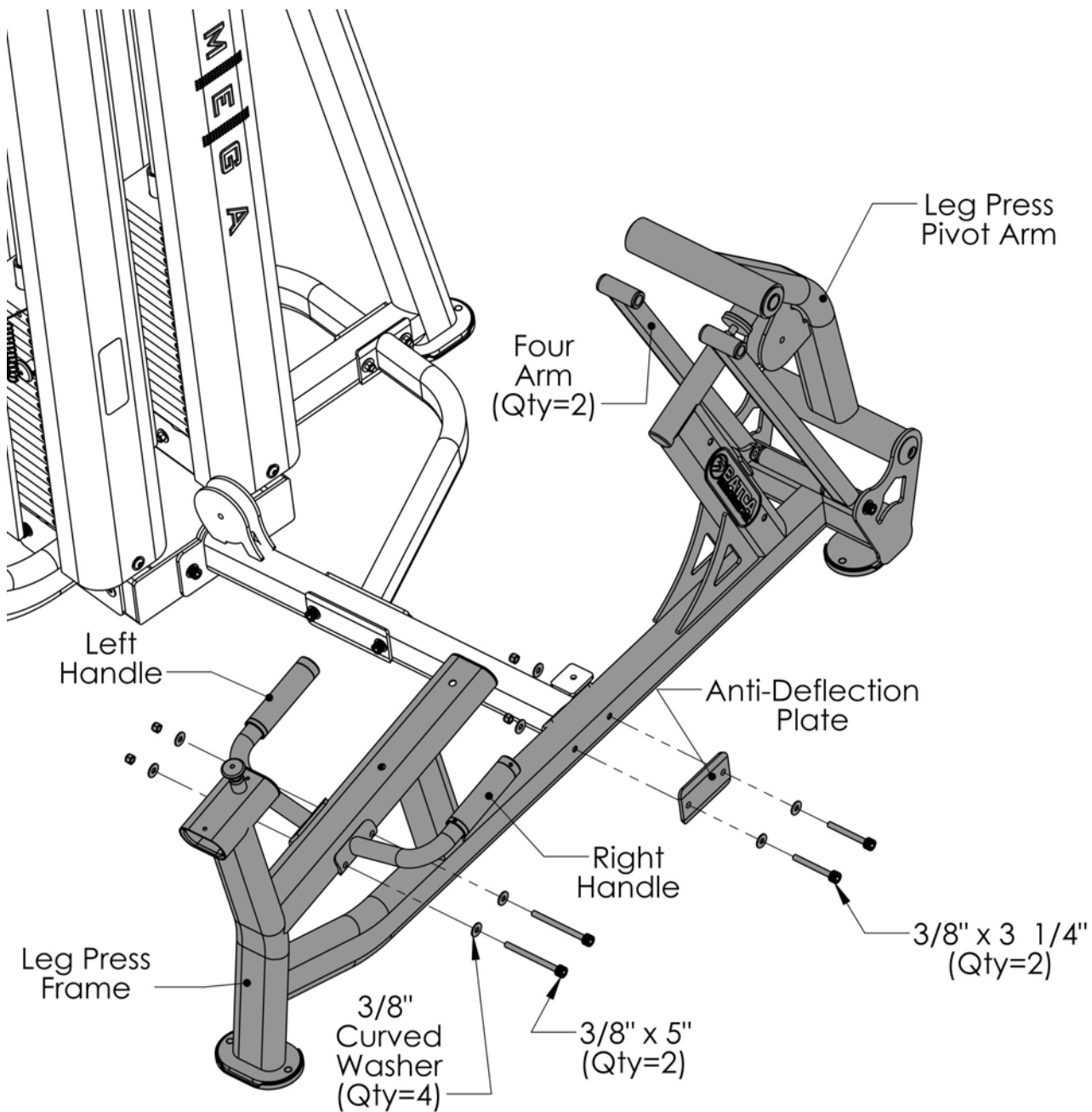

ITEM #	PART #	DESCRIPTION	QTY
109	BFP-10982	LEG PRESS FRAME	1
110	BFP-10860	LEFT HANDLE	1
111	BFP-10861	RIGHT HANDLE	1
112	BFP-52159	ANTI DEFLECTION PLATE	1
113	BFP-10851	FOUR ARM	2
114	BFP-10852	PIVOT ARM	1
132	BFP-51748	SHCS 3/8" x 3 1/4"	2
133	BFP-51799	SHCS 3/8" x 5 "	2
135	BFH-50204	3/8" CURVED WASHER	4
136	BFH-50146	3/8" FLAT WASHER	4
137	BFH-50157	3/8" NYLOCK	4

ALL FLAT WASHERS AND NYLOCKS ARE 3/8" UNLESS OTHERWISE NOTED.

STEP 24:

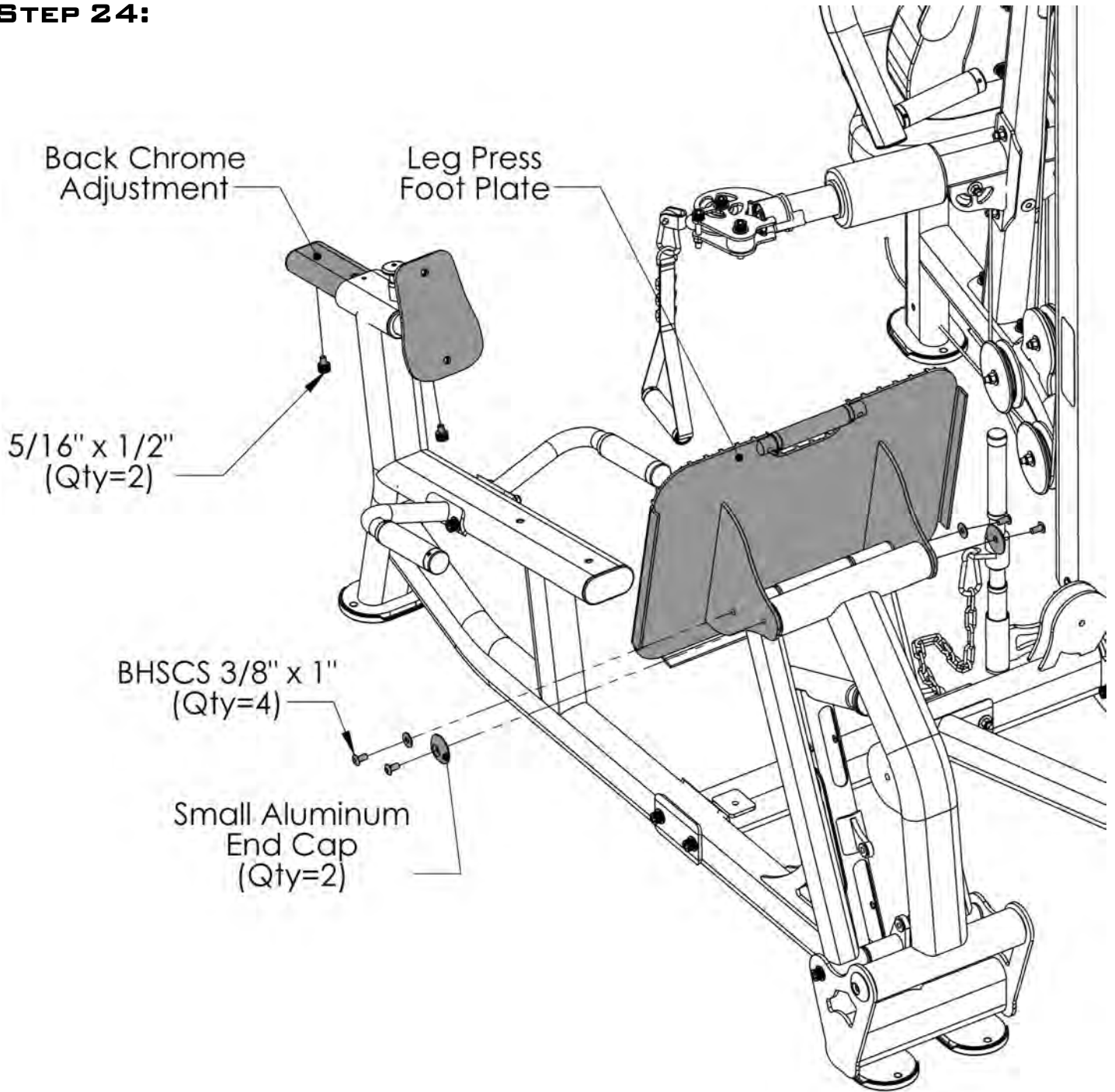

ITEM #	PART #	DESCRIPTION	QTY
115	BFP-10853	LEG PRESS FOOT PLATE	1
116	BFP-10983	BACK CHROME ADJUSTMENT	1
121	BFP-51696	SMALL ALUMINUM END CAP	2
123	BFP-52430	SHCS 5/16" x 1/2"	2
124	BFH-50620	BHSCS 3/8" x 1"	4
136	BFH-50146	3/8" FLAT WASHER	2

ALL FLAT WASHERS AND NYLOCKS ARE 3/8" UNLESS OTHERWISE NOTED.

STEP 25:

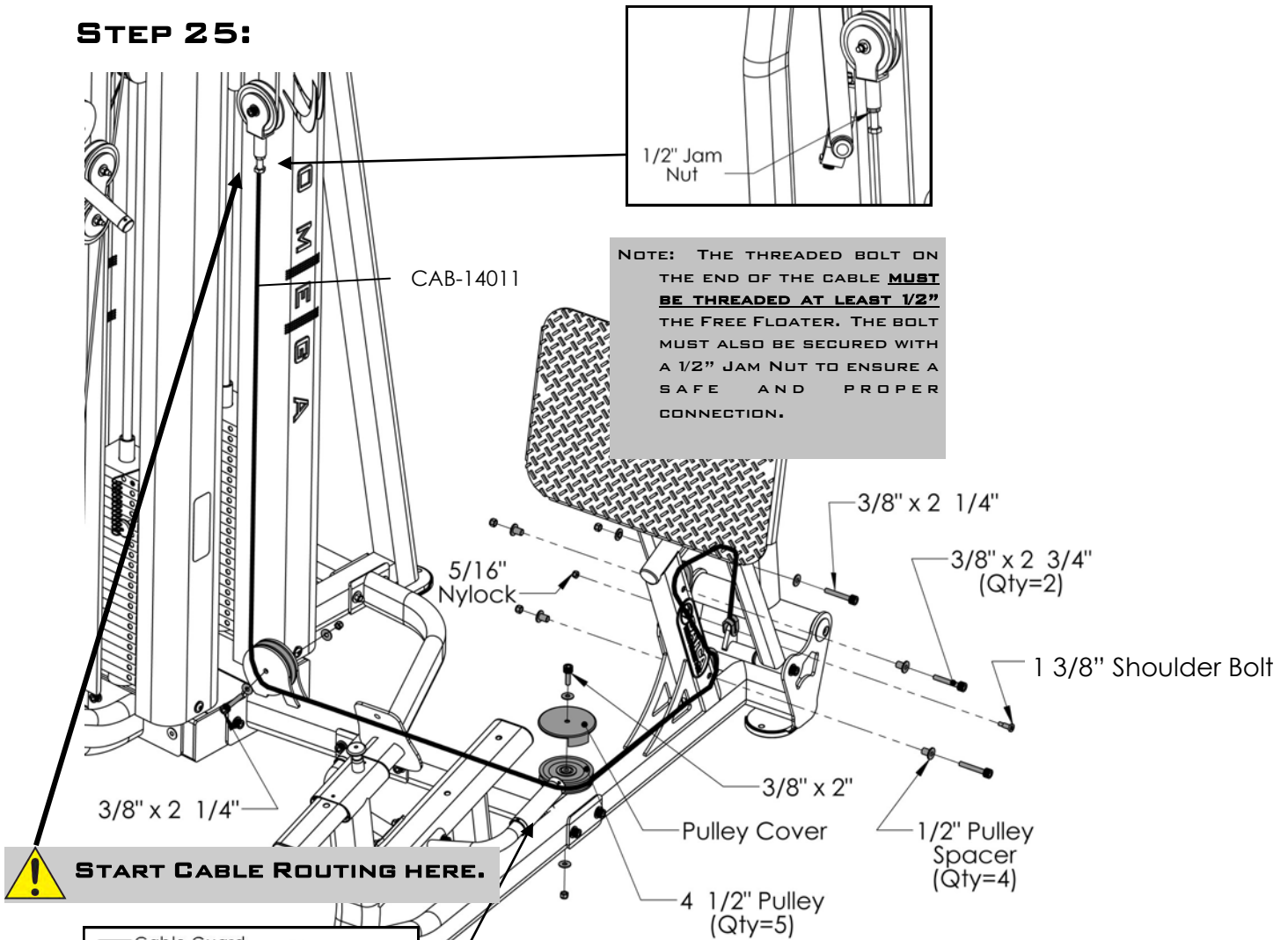

NOTE: THE THREADED BOLT ON THE END OF THE CABLE **MUST BE THREADED AT LEAST 1/2"** THE FREE FLOATER. THE BOLT MUST ALSO BE SECURED WITH A 1/2" JAM NUT TO ENSURE A SAFE AND PROPER CONNECTION.

! START CABLE ROUTING HERE.

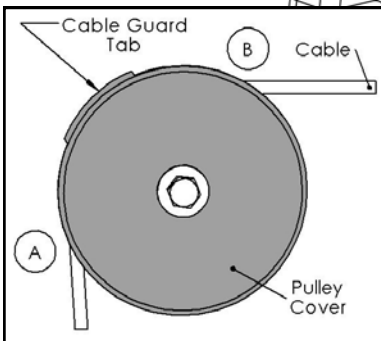

- POSITION** THE CABLE GUARD TAB ON THE PULLEY COVER SO THAT THE TAB PREVENTS THE CABLE FROM COMING OUT OF ITS TRACK ON THE 4 1/2" PULLEY. AN EXAMPLE OF THIS POSITIONING CAN BE SEEN IN THE FIGURE ABOVE. THE CABLE GUARD TAB SHOULD BE POSITIONED SO THAT IT IS IN THE MIDDLE OF THE CABLE WRAP ON THE 4 1/2" PULLEY, BETWEEN POINTS "A" AND "B". THIS WILL ALLOW BETTER PROTECTION AND PREVENT THE CABLE FROM RUBBING THE CABLE GUARD TAB.

ALL FLAT WASHERS AND NYLOCKS ARE 3/8" UNLESS OTHERWISE NOTED.

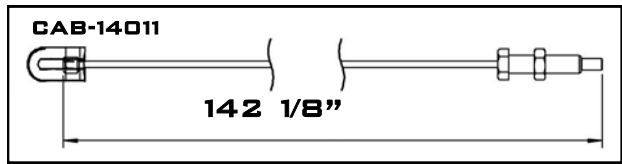

ITEM #	PART #	DESCRIPTION	QTY
140	CAB-14011	FREE FLOATER TO CABLE LOCKOUT	1
117	BFM-50345	PULLEY COVER	1
120	BFH-50174	4 1/2" PULLEY	5
122	BFP-51746	1/2" PULLEY SPACER	4
126	BFH-50351	1 3/8" SHOULDER BOLT	1
127	BFP-51759	SHCS 3/8" x 2"	1
128	BFP-51752	SHCS 3/8" x 2 1/4"	2
130	BFP-51750	SHCS 3/8" x 2 3/4"	2
134	BFH-50267	5/16" NYLOCK	1
136	BFH-50146	3/8" FLAT WASHER	6
137	BFH-50157	3/8" NYLOCK	5

STEP 26:

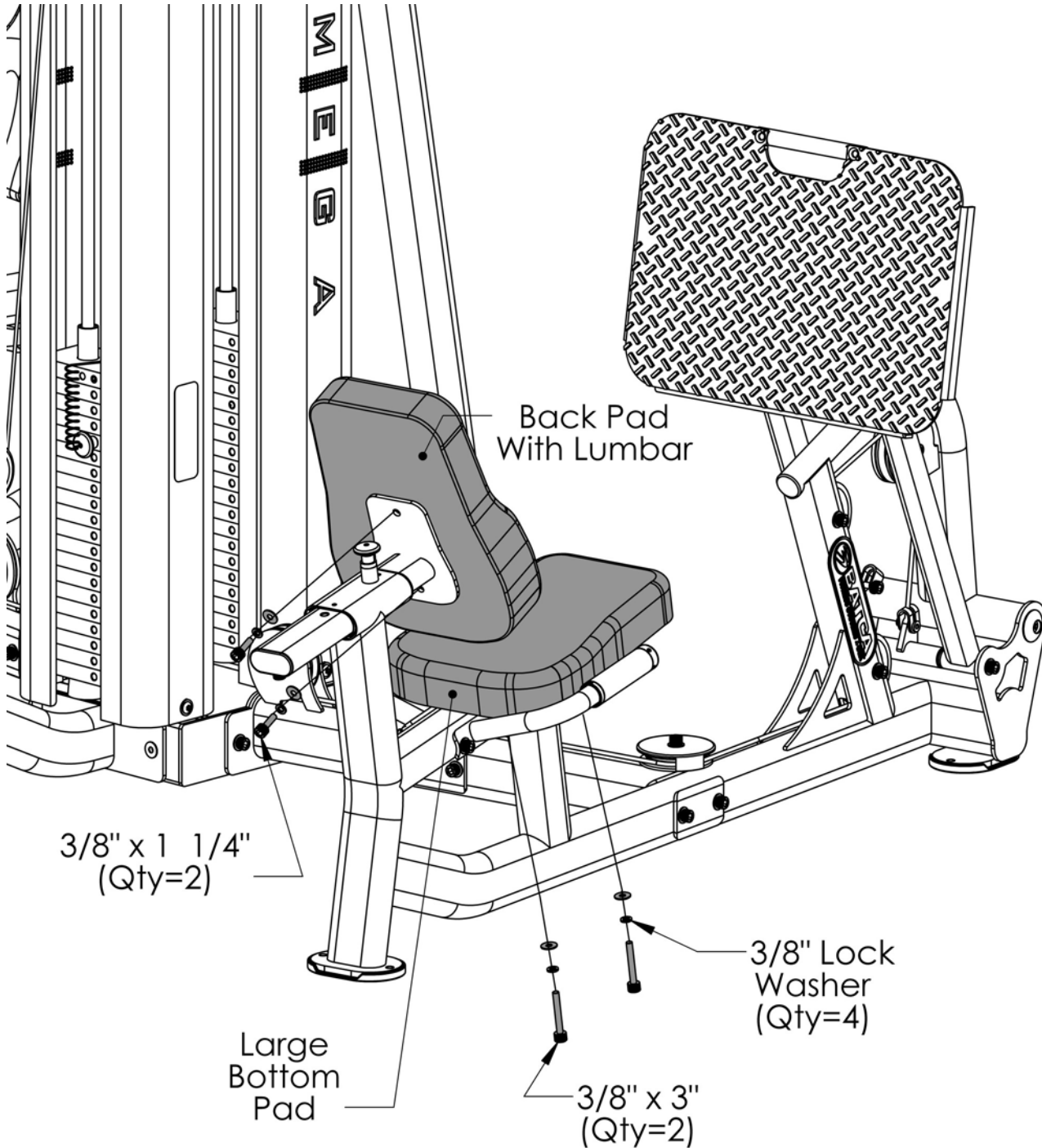

ITEM #	PART #	DESCRIPTION	QTY
118	BFP-52136	BACK PAD WITH LUMBAR	1
119	BFP-52130	LARGE BOTTOM PAD	1
125	BFP-51653	SHCS 3/8" x 1 1/4"	2
131	BFP-51747	SHCS 3/8" x 3"	2
138	BFH-50147	3/8" LOCK WASHER	4
137	BFH-50146	3/8" FLAT WASHER	4

ALL FLAT WASHERS AND NYLOCKS ARE 3/8" UNLESS OTHERWISE NOTED.

FINAL ASSEMBLY AND TROUBLESHOOTING

WEIGHT STACK DECALS:

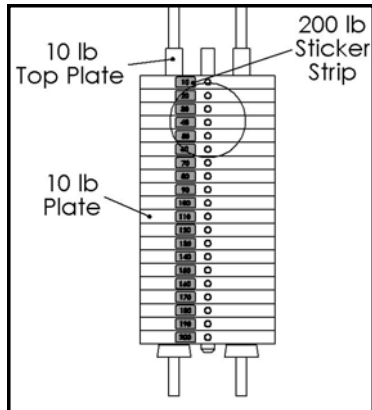

200LB STACK

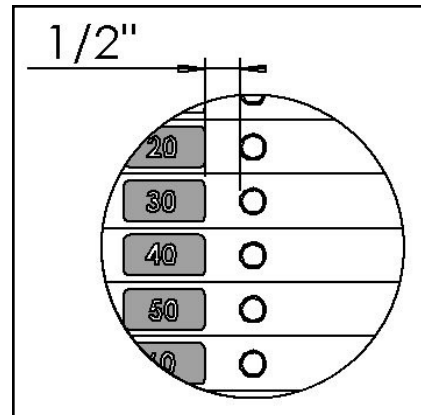

IMPORTANT - CHECK THESE COMPONENTS BEFORE USING GYM:

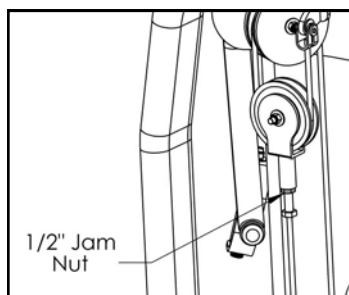

FREE FLOATER

- EACH CABLE WITH A THREADED BOLT ON EITHER END **MUST BE THREADED AT LEAST 1/2"** INTO ITS ATTACHMENT, WHETHER IT BE A FREE FLOATER, LOCKOUT FREE FLOATER, OR THE TOP PLATE OF THE WEIGHT STACK. EACH MUST ALSO BE SECURED WITH A 1/2" JAM NUT TO ENSURE A SAFE AND PROPER CONNECTION.

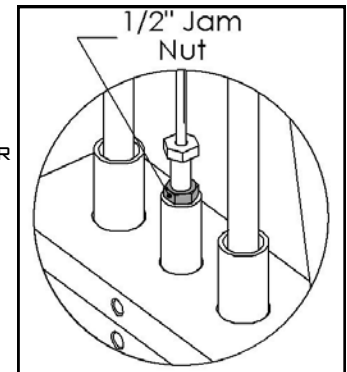

TOP PLATE

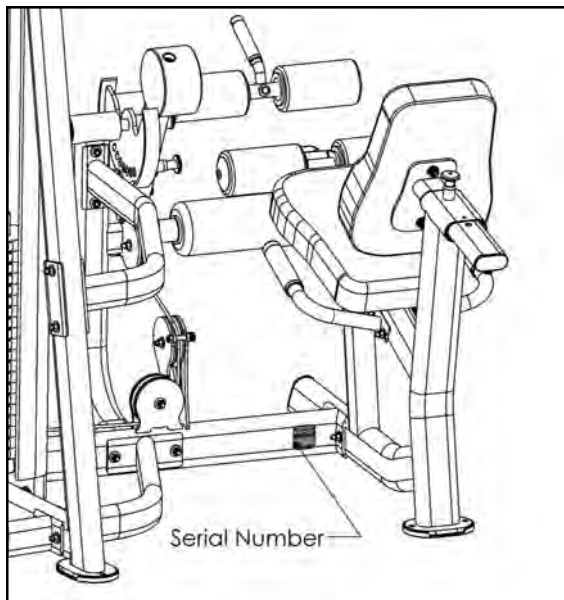

- **RECORD** YOUR SERIAL NUMBER ON THE FRONT OF THIS MANUAL AND KEEP FOR YOUR RECORDS. THE SERIAL NUMBER CAN BE FOUND BACK OF THE LEG EXTENSION/LEG CURL BASE AS SHOWN IN THE FIGURE TO THE LEFT.

GUIDE ROD

- CLEAN GUIDE RODS WITH A LINT-FREE CLOTH AND APPLY A THIN LAYER OF SILICONE LUBRICANT (PART # BFH-50262) TO EACH GUIDE ROD. THIS WILL ENSURE A GLASS SMOOTH PERFORMANCE FROM YOUR WEIGHT STACK.

CABLE ADJUSTMENTS

- **ADJUST** CABLES TO PROPER TENSION FROM ANY OF THE LOCATIONS SHOWN BELOW.



NOTE: ALL CABLES WITH THREADED ADJUSTABLE ENDS MUST HAVE AT LEAST 1/2" OF THE THREADS THREADED IN TO ITS COUNTERPART. IT IS VERY IMPORTANT THAT THE 1/2" JAM NUT BE WRENCH TIGHTENED TO THE COUNTERPART TO ENSURE THAT THE THREADED ADJUSTABLE END OF THE CABLE DOES NOT BACK OUT OF ITS COUNTERPART.

- **NOTE:** IF THE TOP PLATE RAISES OFF OF THE SECOND PLATE IN THE WEIGHT STACK, THEN THE CABLE TENSION IS TOO TIGHT. YOU WILL NEED TO TAKE SOME OF THE TENSION OUT TO LOWER THE TOP PLATE FLUSH WITH THE SECOND PLATE.

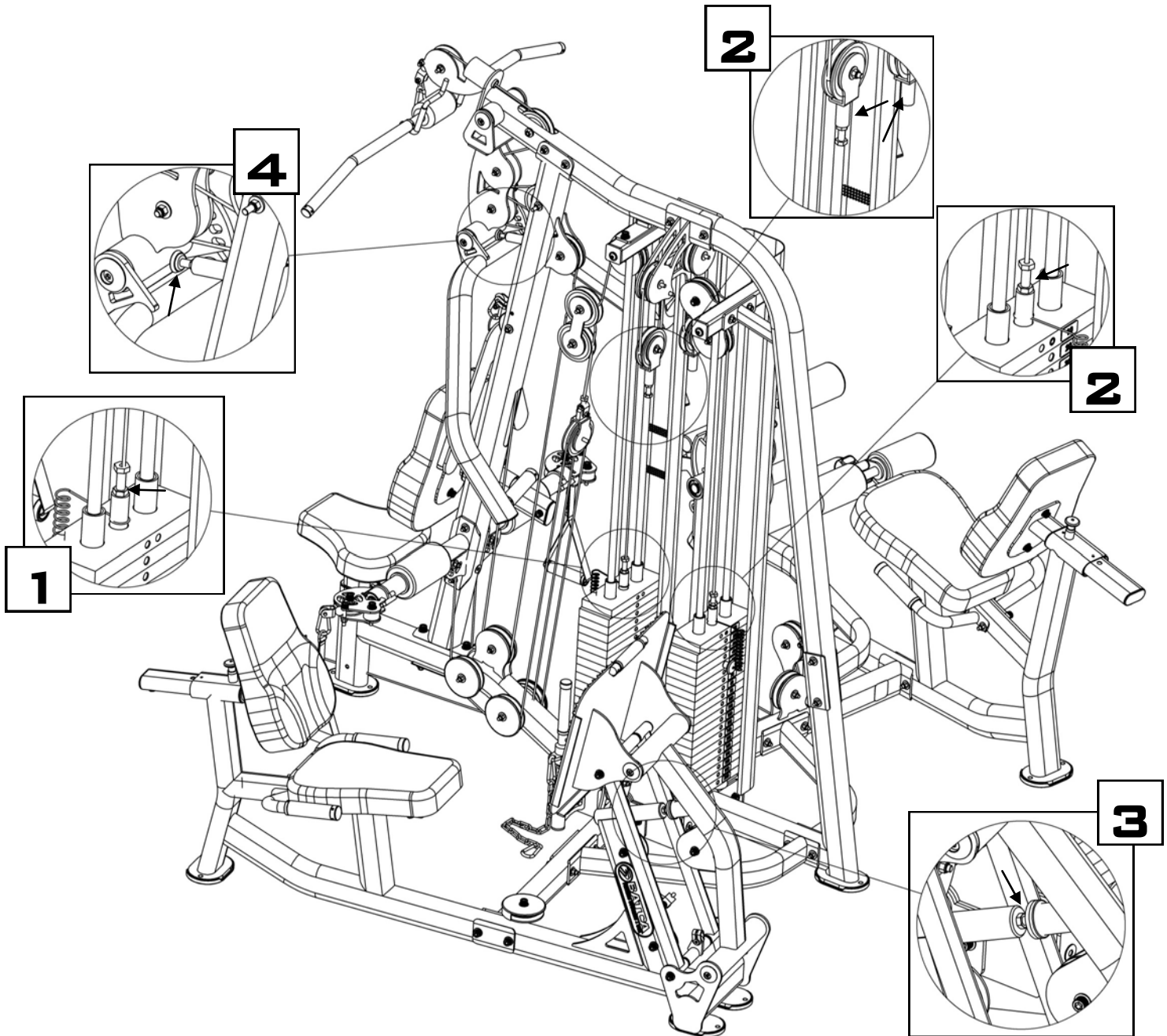

PREVENTIVE MAINTENANCE

BATCA FITNESS SYSTEMS STRIVES TO GIVE YOU THE VERY BEST IN QUALITY, PERFORMANCE AND SAFETY THROUGH CAREFULLY ENGINEERED DESIGNS AND EXCELLENT WORKMANSHIP. IN ORDER TO MAINTAIN THIS HIGH LEVEL OF QUALITY THE PREVENTATIVE MAINTENANCE SCHEDULE BELOW SHOULD BE FOLLOWED.

CLEAN UPHOLSTERY, GRIPS, AND ROLLER PADS WITH MILD SOAP AND WATER GENERALLY AFTER EVERY USE. THE GUIDE RODS, CHROME SLIDES AND FRAME SHOULD BE CLEANED WITH A COTTON CLOTH. UPON CLEANING THE GUIDE RODS, A THIN LAYER OF SILICONE OR TEFLON GEL SHOULD BE APPLIED TO EACH ROD TO ENSURE A GLASS SMOOTH PERFORMANCE.

AN OVERALL INSPECTION SHOULD BE DONE BEFORE EACH WORKOUT. IF THE WARNING AND SAFETY DECALS ARE WORN OR HAVE BEEN REMOVED THEY SHOULD BE REPLACED IMMEDIATELY. THE CABLES AND CABLE SYSTEMS SHOULD BE INSPECTED FOR SIGNS OF WEAR AND PROPER TENSION. IN ORDER TO CHECK CABLES PROPERLY YOU SHOULD CAREFULLY RUN THE CABLE THROUGH YOUR FINGERTIPS, CHECKING FOR SIGNS OF WEAR, CRACKS, BURS AND THINNING SPOTS. REPLACE ANY PART AT FIRST SIGNS OF WEAR. CABLES SHOULD BE ADJUSTED FOR PROPER TENSION. SEE ASSEMBLY INSTRUCTIONS FOR THIS DETAIL. ALL HARDWARE, STOPS, AND ADJUSTMENTS SHOULD BE CHECKED AND TIGHTENED AS REQUIRED.

THE GUIDE RODS ON YOUR MACHINE SHOULD BE CLEANED AND LUBRICATED REGULARLY. THIS WILL ENSURE A GLASS SMOOTH PERFORMANCE FROM YOUR WEIGHT STACK. A THIN LAYER OF EITHER SILICONE OR TEFLON GEL SHOULD APPLIED TO EACH ROD. EACH PILLOW BLOCK BEARING AND FLANGE BEARING HAS A GREASE FITTINGS THAT MUST BE LUBRICATED REGULARLY. USE GENERAL PURPOSE BEARING GREASE AND FOLLOW THE SCHEDULE BELOW.

ALTHOUGH CABLES SHOULD BE INSPECTED DAILY, IT IS IMPORTANT THAT ALL CABLES BE REPLACED AS DIRECTED IN THE SCHEDULE BELOW. PLEASE NOTE THAT AT ANY FIRST SIGN OF WEAR THE CABLE SHOULD BE REPLACED IMMEDIATELY.

IF THERE ARE ANY QUESTIONS CONCERNING MAINTENANCE, PLEASE CONTACT YOUR LOCAL BATCA DEALER OR CONTACT BATCA FITNESS SYSTEMS DIRECTLY AT:

BATCA FITNESS SYSTEMS

(919) 255-1233

WWW.BATCAFITNESS.COM

	DAILY		WEEKLY		MONTHLY		QUARTERLY		YEARS	
	Commercial	Home	Commercial	Home	Commercial	Home	Commercial	Home	Commercial	Home
CLEAN										
UPHOLSTERY	X			X						
HAND GRIPS	X			X						
ROLLER PADS	X			X						
GUIDE RODS			X			X				
CHROME SLIDES			X			X				
FRAME			X			X				
INSPECT										
OVERALL	X	X								
SAFETY DECALS	X	X								
CABLES	X	X								
CABLE TENSION			X			X				
PULLEYS	X	X								
HARDWARE	X	X								
STOPS	X	X								
UPHOLSTERY	X	X								
HAND GRIPS			X			X				
FRAME			X			X				
BUSHINGS	X			X						
BEARINGS	X			X						
LUBRICATE										
GUIDE RODS			X			X				
BEARINGS			X				As Needed			1
REPLACE										
CABLES									1	3

LIMITED LIFETIME WARRANTY

WHAT IS COVERED

FOR RESIDENTIAL USE:

BATCA FITNESS SYSTEMS WARRANTS ALL OF ITS PRODUCTS AGAINST DEFECTS IN MANUFACTURING, MATERIALS AND WORKMANSHIP UNDER NORMAL USE AND SERVICE FOR ONE YEAR FROM DATE OF PURCHASE INCLUDING PAINT, CHROME, UPHOLSTERY AND GRIPS. BATCA FITNESS SYSTEMS ALSO WARRANTS ALL CABLES, BELTS, BOLTS, NUTS, CAPS, PLUGS, BUMPERS, WASHERS, LEVELERS, DECALS, GAS SPRINGS AND OTHER HARDWARE FOR THREE YEARS AFTER DATE OF PURCHASE; ALL MOVING PARTS, INCLUDING PULLEYS, BUSHINGS, BEARINGS AND PULL PINS FOR FIVE YEARS AFTER DATE OF PURCHASE AND WARRANTS THE FRAME AND ALL WELDED PARTS FOR THE LIFETIME OF THE ORIGINAL PURCHASER.

FOR COMMERCIAL USE:

BATCA FITNESS SYSTEMS WARRANTS ALL OF ITS PRODUCTS AGAINST DEFECTS IN MANUFACTURING, MATERIALS AND WORKMANSHIP UNDER NORMAL USE AND SERVICE FOR SIX MONTHS FROM DATE OF PURCHASE INCLUDING PAINT, CHROME, UPHOLSTERY AND GRIPS. BATCA FITNESS SYSTEMS ALSO WARRANTS ALL CABLES, BELTS, BOLTS, NUTS, CAPS, PLUGS, BUMPERS, WASHERS, LEVELERS, DECALS, GAS SPRINGS AND OTHER HARDWARE FOR ONE YEAR AFTER DATE OF PURCHASE; ALL MOVING PARTS, INCLUDING PULLEYS, BUSHINGS, BEARINGS AND PULL PINS FOR THREE YEARS AFTER DATE OF PURCHASE AND WARRANTS THE FRAME AND ALL WELDED PARTS FOR TEN YEARS AFTER DATE OF PURCHASE.

WHAT IS NOT COVERED

THIS WARRANTY DOES NOT COVER DAMAGE, WHICH RESULTS FROM SHIPPING, MISUSE, ABUSE, NEGLIGENCE, CARELESSNESS, MODIFICATION OR ALTERATION, ACCIDENT, FIRE, FLOOD, "ACTS OF GOD" OR OTHER CONTINGENCIES BEYOND THE CONTROL OF BATCA FITNESS SYSTEMS. THIS WARRANTY ALSO DOES NOT COVER DETERIORATION FROM WEAR AND TEAR OR EXPOSURE OR ANY DEFECT, WHICH WOULD NOT HAVE HAPPENED IF INSTRUCTIONS IN THE OWNER'S MANUAL HAD BEEN FOLLOWED. IMPROPER INSTALLATION, IMPROPER ASSEMBLY OR FOLLOW-UP MAINTENANCE ALONG WITH INSTALLATION OF PARTS OR ACCESSORIES NOT ORIGINALLY INTENDED FOR PRODUCTS OF BATCA FITNESS SYSTEMS ARE ALSO NOT COVERED BY THIS WARRANTY. ONLY GENUINE BATCA PARTS SHOULD BE USED FOR REPLACEMENT, REPAIR, AND MAINTENANCE FOR THIS WARRANTY TO APPLY.

DEFECTIVE PARTS WILL BE REPAIRED OR REPLACED AT BATCA FITNESS SYSTEMS OPTION, WITHOUT PARTS CHARGE TO THE PURCHASER. ALL RETURNS REQUIRE A RETURN AUTHORIZATION PRIOR TO ACCEPTANCE OF REPAIR WORK. BATCA FITNESS SYSTEMS RESERVES THE RIGHT TO MAKE DESIGN CHANGES WITHOUT ANY PRIOR NOTIFICATION AND SHALL NOT BE RESPONSIBLE FOR INCIDENTAL OR CONSEQUENTIAL DAMAGES.

THE PURCHASER IS RESPONSIBLE FOR SHIPPING THE DEFECTIVE PART BACK TO THE FACTORY. REPAIR OR REPLACEMENT IS THE EXCLUSIVE AND SOLE REMEDY OF THE PURCHASER. LABOR CHARGES ASSOCIATED WITH PARTS CHANGES ARE NOT COVERED BY THIS WARRANTY. PROOF OF PURCHASE, SERIAL NUMBER, MODEL NUMBER AND DATE OF PURCHASE WILL BE REQUIRED ALONG WITH ALL PERTINENT INFORMATION OF THE ALLEGED DAMAGE.

THIS WARRANTY APPLIES ONLY TO THE ORIGINAL PURCHASER AND IS NOT TRANSFERABLE. CLAIMS UNDER THIS WARRANTY MUST BE MADE DIRECTLY TO BATCA FITNESS SYSTEMS.

BATCA FITNESS SYSTEMS
1207 N. NEW HOPE ROAD
RALEIGH, NC 27610
(919) 255-1233

WWW.BATCAFITNESS.COM

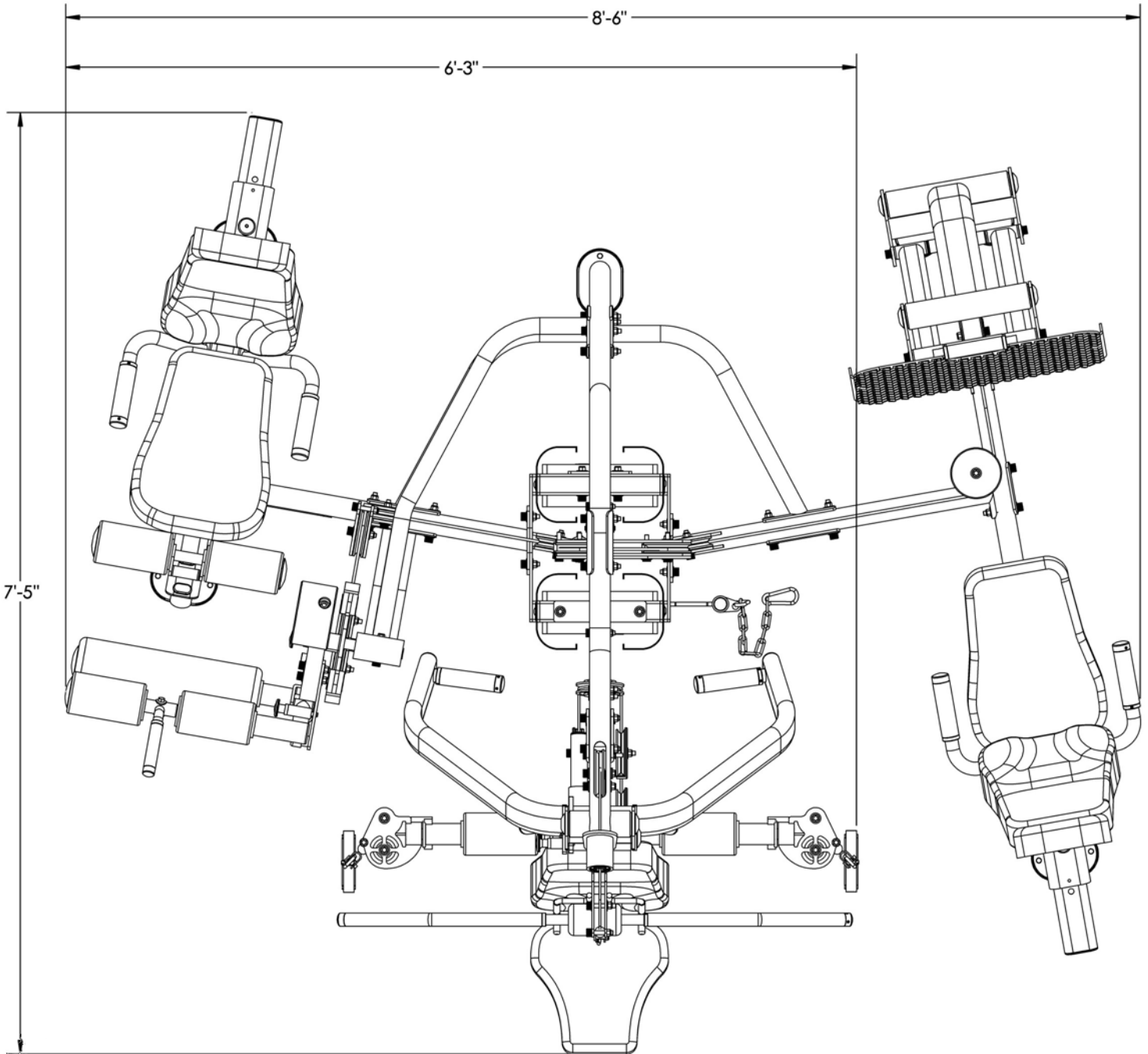

LAYOUT DIAGRAM

THE OMEGA 2 WITHOUT LEG PRESS HAS A LAYOUT DIMENSION OF 7'-5" (LENGTH) x 6'-3" (WIDTH) x 7'-0" (HEIGHT). THE OMEGA 2 WITH LEG PRESS HAS A LAYOUT DIMENSION OF 7'-5" (LENGTH) x 8'-6" (WIDTH) x 7'-0" (HEIGHT). THERE SHOULD BE MINIMUM OF 18", PREFERABLY 24", OR WORKING SPACE AROUND THE ENTIRE UNIT.