



CLEANPatch[®]-V

Medical Surface Repair patch for vinyl upholstery
Restores damage to an intact and hygienic state



	✓ Use CleanPatch [®] -V	✗ Do Not Use CleanPatch [®] -V
Equipment Condition	Usable within expected lifespan	No longer suitable for use
Appearance	No signs of fluid ingress	Surface is stained or warped
Damage Size and Location	Less than 6 inches (15 cm) Flat areas or over edges (2-D) No seams	More than 6 inches (15 cm) Sharp corners (3-D) Seams
Application	One patch per damaged area	Layering multiple patches is not recommended

IMPORTANT

- ✓ Vinyl surfaces should be inspected for damage during every cleaning
- ✓ Measure damage and use correct size of CleanPatch[®]-V to ensure proper adhesion
- ✓ If the patch lifts or peels, remove and apply a new CleanPatch[®]-V

To ensure product integrity, do not cut CleanPatch[®]-V



For more information visit www.cleanpatch.ca

CleanPatch[®] is patented by Surface Medical Inc. © CPVUG20180524

CLEANPatch[®]-V

STEP 1: Assess the damage to determine if CleanPatch[®]-V is appropriate (see over)

STEP 2: Measure the damage to determine which shape and size to use

Item Number	CleanPatch-V Size	Application
#21001 (10/box)	1.75 x 4 inch strip (S)	Damage up to 2 inches
#22001 (5/box)	5.75 x 8 inch rectangle (R)	Damage up to 6 inches
#23001 (10/box)	7 S + 3 R	Damage up to 6 inches
#24001 (10/box)	3 S + 1 R	Damage up to 6 inches

STEP 3: Apply CleanPatch[®]-V

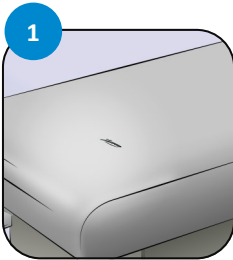

Assess and measure damage.



Clean surface per usual protocol.
Dry thoroughly.

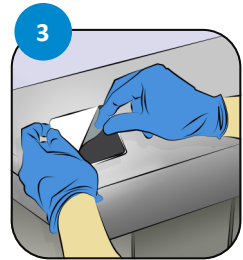

Remove the white backing.



Position over damaged area.



Firmly press on patch,
especially around edges.

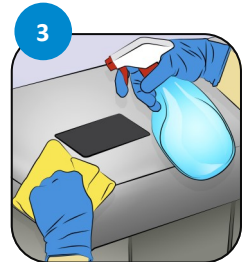

Clean the patch and
surrounding area.

