

Nautilus®ONE® Installation/Owner's Guide

The Installation/Owner's Guide provides instructions for the Tower Shroud and Cover Removal



Assembly

NOTICE: To prevent damage, all plastic shields must be removed from the weight tower prior to removal from the pallet and moving to the installation site.

If you need assistance, please call Nautilus® Customer Service at 1-800-628-8458.

N1 Tower Shroud removal instructions

Remove the Top Cover

- 1-1 Remove the two mounting screws on the rear of the top cover (See Fig. 1).
- 1-2 Remove the cover by lifting the rear edge up & forward to clear the front slot (See Fig. 2).

Remove the Rear Shroud

- 2-1 Remove one screw at the top of the shroud. Lift up and out of the bottom slot (See Fig. 3).

Remove the Outside Shroud

Note: The large round bezel does not need to be removed from the outside shroud.

- 3-1 Lift the shroud up until the tabs stop at the top of the P-slot (See Fig. 4, back page).

NOTICE: Do not attempt to remove shroud by prying with any type of tool.

- 3-2 Pull shroud outward to remove from the P-slots. (Fig. 5, back page)

Remove the Inside Shroud

- 4-1 Remove the center cap behind the dial. Adjust the dial to the lowest setting and lift the dial up and out of the way. Unsnap the center cap out of the shroud opening tabs (See Fig. 6, back page).
- 4-2 Lift the shroud up until the tabs stop at the top of the P-slot.

NOTICE: Do not attempt to remove shroud by prying with any type of tool.

- 4-3 Pull the shroud outward to remove it from the P-slots (See Fig. 7, back page).

Fig. 1



Fig. 2



Fig. 3



Attach the Inside Shroud

- 1-1 Put Inside Shroud into P-slots in the Steel Frame
- 1-2 Both front and back tabs need to be inserted into the P-slot openings (See Fig. 4).
- 1-3 Push down on both front and back to seat tabs at the bottom of the P-slots.

NOTICE: Do not attempt to force the shroud downward or tabs may break off. When the tabs are aligned to the P-slots, the cover should drop down into the slots with minimal resistance.

- 1-4 Install the center cap behind the dial. Adjust the dial to the lowest setting and lift the dial up and out of the way. Snap the center cap into the shroud opening tabs. Make sure to align the cap to the open ring (See Fig. 6).

Attach the Outside Shroud

- 2-1 Put Outside Shroud into the P-slots in the Steel Frame
- 2-2 Both front and back tabs need to be inserted into the P-slot openings (See Fig. 4).
- 2-3 Push down on both front and back to seat tabs at the bottom of the P-slots.

NOTICE: Do not attempt to force the shroud downward or tabs may break off. When the tabs are aligned to the P-slots, the cover should drop down into the slots with minimal resistance.

Attach the Rear Shroud

- 3-1 Put Rear Shroud into the Bottom slot and secure with one screw at the top.

Attach the Top Cover

- 4-1 Align and insert the front tab into the slot at the front of the two side shrouds.
- 4-2 Lower the top cover onto side shrouds making sure that the top edges of both side shrouds fit securely into the slots on each side of the top cover (See Fig. 8).

Note: To assure the top cover is properly installed, push inward on the top edge of the length of both side shrouds. If you can push the shroud inward, it is not in the slot and needs to be reinstalled.

- 4-3 Install the two mounting screws on the rear of the top cover (See Fig. 1).

Fig. 4

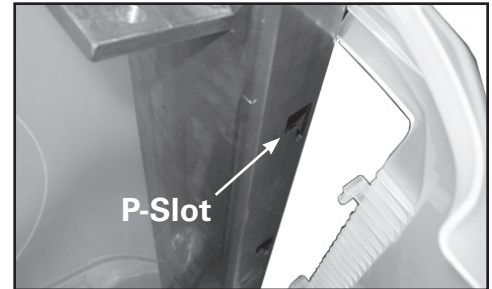

Fig. 5

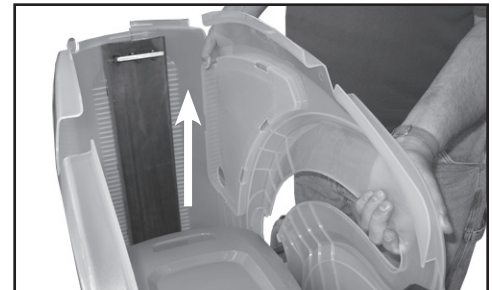

Fig. 6

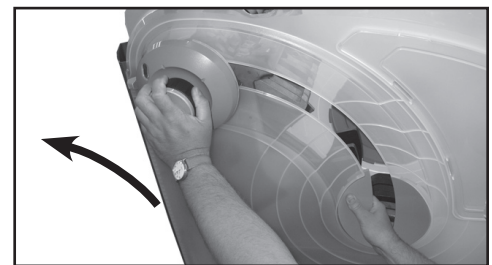

Fig. 7

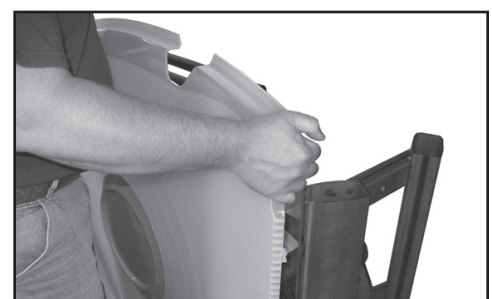
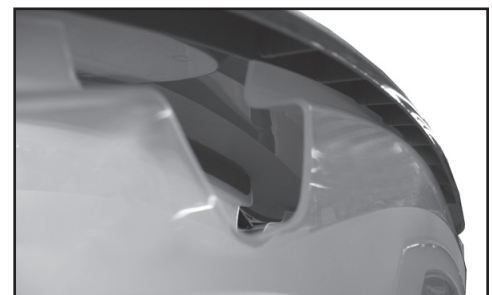

Fig. 8



Nautilus® ONE®

Nautilus® ONE® Weight Drive Installation

The Installation/Owner's Guide provides instructions for Seat Frame to Tower Assembly



Assembly

Tools Required: 3/4" Socket Wrench, Adjustable Wrench

- 1-1** Remove (3) 1/2-13 x 3" bolts from the Tower with 3/4" socket wrench (See Fig. 1).
- 1-2** Remove the Weight Drive Support from the Seat Frame by removing (4) 1/2-13 x 1 1/4" bolts and (4) 1/2-13 Lock Nuts with 3/4" socket wrench and adjustable wrench. Discard (1) bolt and (1) nut (See Fig. 1).
- 1-3** Align the Seat Frame Weight Drive holes to Tower Weight Drive holes and pins. Insert (3) 1/2 x 1 1/4" bolts into weight drive and (3) 1/2 x 3" bolts into seat frame plate. Carefully align Seat Frame to the Tower and tighten all bolts (See Fig. 3).

Note: Make sure that the belt is tight. Be sure that the dial selects and engages weight plates.

NO.	PART NO.	DESCRIPTION	QTY.
1	56-0161	WEIGHT DRIVE SUPPORT	1
2	01-1331	BOLT HH 1/2-13 X 3"	3
3	01-1271	BOLT HH 1/2-13 X 1 1/4"	4
4	03-1055	LOCK NUT 1/2-13	4

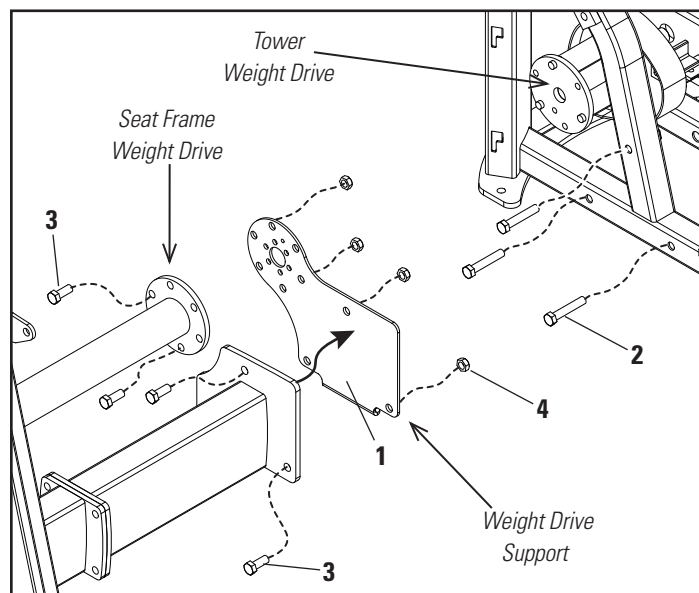

Fig. 1

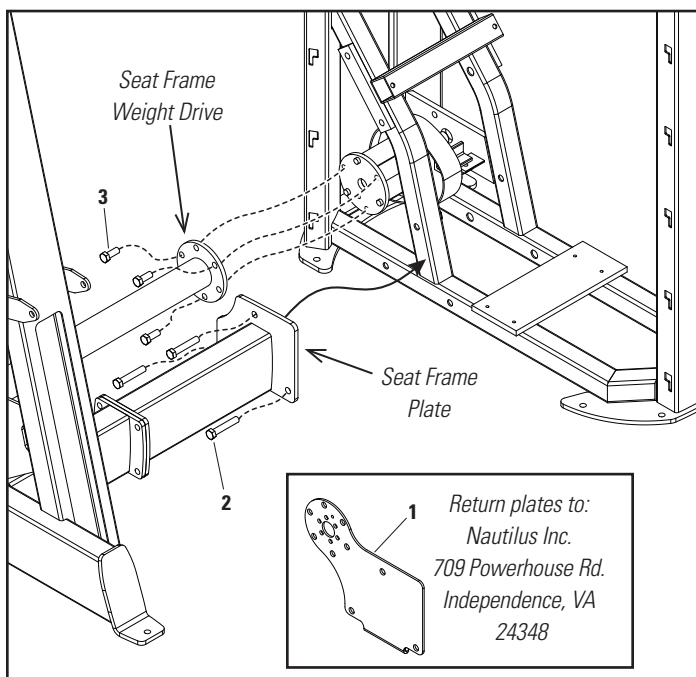

Fig. 2

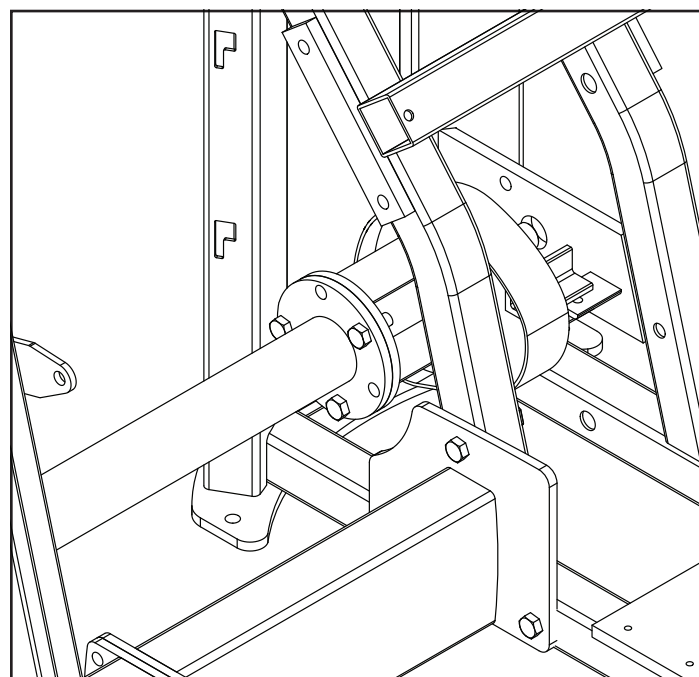

Fig. 3

©2007. Nautilus, Inc. All rights reserved. Nautilus, the Nautilus Logo, ONE, the ONE Logo, Bowflex, StairMaster and Nautilus Institute are either registered trademarks or trademarks of Nautilus, Inc. Schwinn is a registered trademark. All other trademarks are owned by their respective companies. www.nautilus.com

Installation of Nautilus One weight system selector knob badge.

1. Assure that knob is secure to shaft and screw is tight.
2. Remove adhesive backing cover from back of badge.
3. Align keyed slots on badge to mating keys on knob face (see photo).
4. Apply badge securely to knob face.

